

K&E 15-108 2411

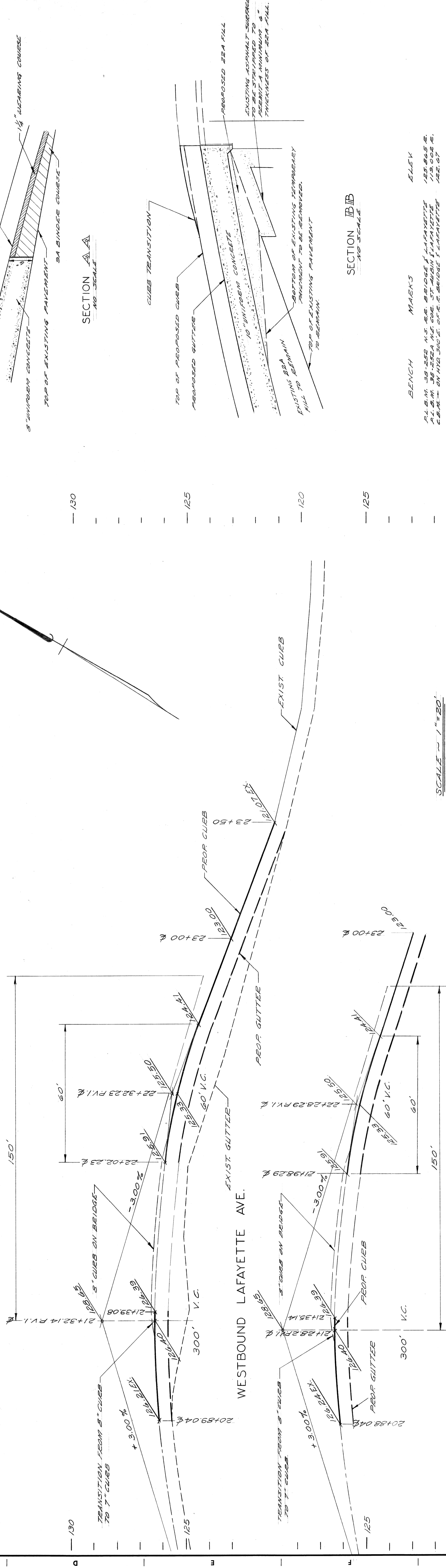
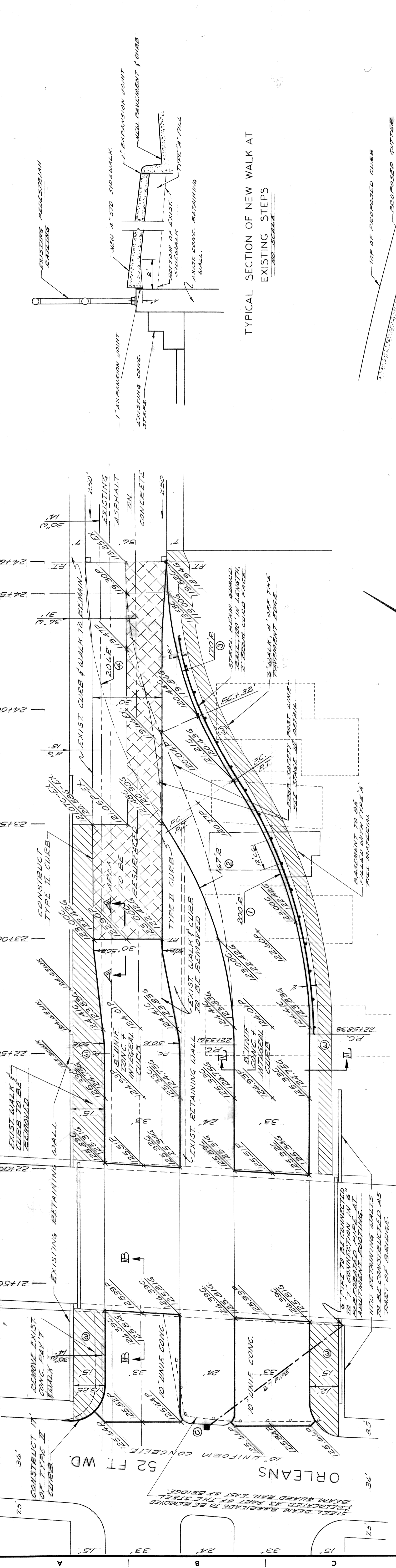

EASTBOUND LAFAYETTE AVE.

SCALE 1" = 20'

CURVE DATA	CONSTRUCTION SYMBOLS
① $R = 120'$ $C = 53' 39"$ $T = 51' 41"$ $A = 117' 46"$	① CONST. STD. CONC. WALK
② $R = 204'$ $C = 94' 20" 11"$ $T = 63' 04"$ $A = 100' 03"$	② CONST. STD. CONC. WALK

CITY OF DETROIT
DEPARTMENT OF PUBLIC WORKS
CITY ENGINEERS OFFICE
BUREAU OF HIGHWAYS AND EXPRESSWAYS
RAILROAD GRADE SEPARATION

LARNED ST. BRIDGE X069 & LAFAYETTE AVE. BRIDGE X072
OVER
GRAND TRUNK WESTERN RAILROAD
LAFAYETTE AVE. PAVING

DESIGNED BY	E. G. ANGELO
DRAWN BY	E. G. ANGELO
TRACED BY	
CHECKED BY	E. G. ANGELO

APPROVED: *E. G. Angelo*
ENGINEER OF STREETS

ASSISTANT ENGINEER - HIGHWAYS AND EXPRESSWAYS
Charles L. Power
CITY ENGINEER

DESCRIPTION	DATE
REVISIONS LOCATED BY COORDINATES ON SHEET	

SHEET 43 OF 46 SHEETS
CONTRACT NO. PW 3988
DRWG NO. P-302
DATE MAR. 1962

MISCELLANEOUS QUANTITIES		
ITEM	AMOUNT	UNIT
Excavation	261	Cu. Yds.
Pavement Removal (Incl. Curb)	256	Sq. Yds.
Concrete Walk Removal	6,126	Sq. Ft.
Concrete Drive Removal	10	Sq. Yds.
Curb Removal (Incl. Backing)	635	Lin. Ft.
Curb Removal	25	Lin. Ft.
Tree Removal (4"-12" Dia.)	3	Each
Tree Removal (13"-18" Dia.)	1	Each
Fill, Type A	850	Cu. Yds.
Fill, Type 22 A or 22 B	476	Cu. Yds.
Manhole, Adjust	2	Each
Catch Basin, Std., New	15	Lin. Ft.
Sewer, 12" Pipe	90	Lin. Ft.
Paving, 10" Uniform Concrete Integral Curb	669	Sq. Yds.
Paving, 8" Uniform Concrete Integral Curb	1,908	Sq. Yds.
Stelewalk, 4" Standard	6,920	Sq. Ft.
Curb, Type II	364	Lin. Ft.
Test Cores	3	Each
6" Base Course	226	Sq. Yds.
Strip Existing Asphalt Surface	193	Sq. Yds.
Asphaltic Binder Course	127	Tons
Asphaltic Wearing Course	86	Tons
Bond Coat	195	Gals.
Top Soil	70	Cu. Yds.
Building Entrance	Lump Sum	Lump Sum
Maintain Traffic	Lump Sum	Lump Sum
Asphaltic Curb	475	Lin. Ft.

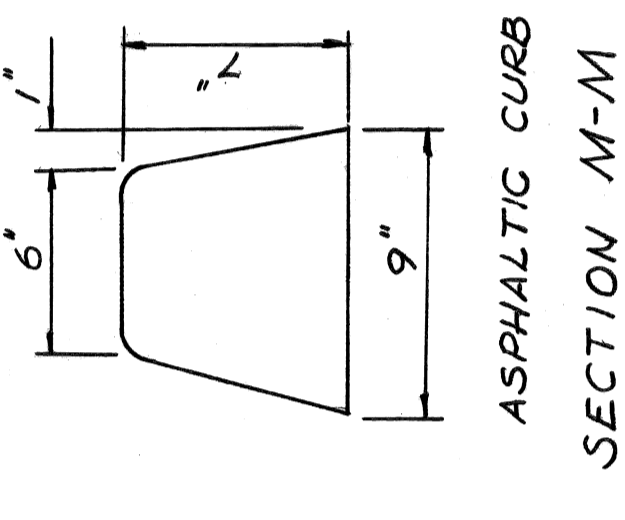
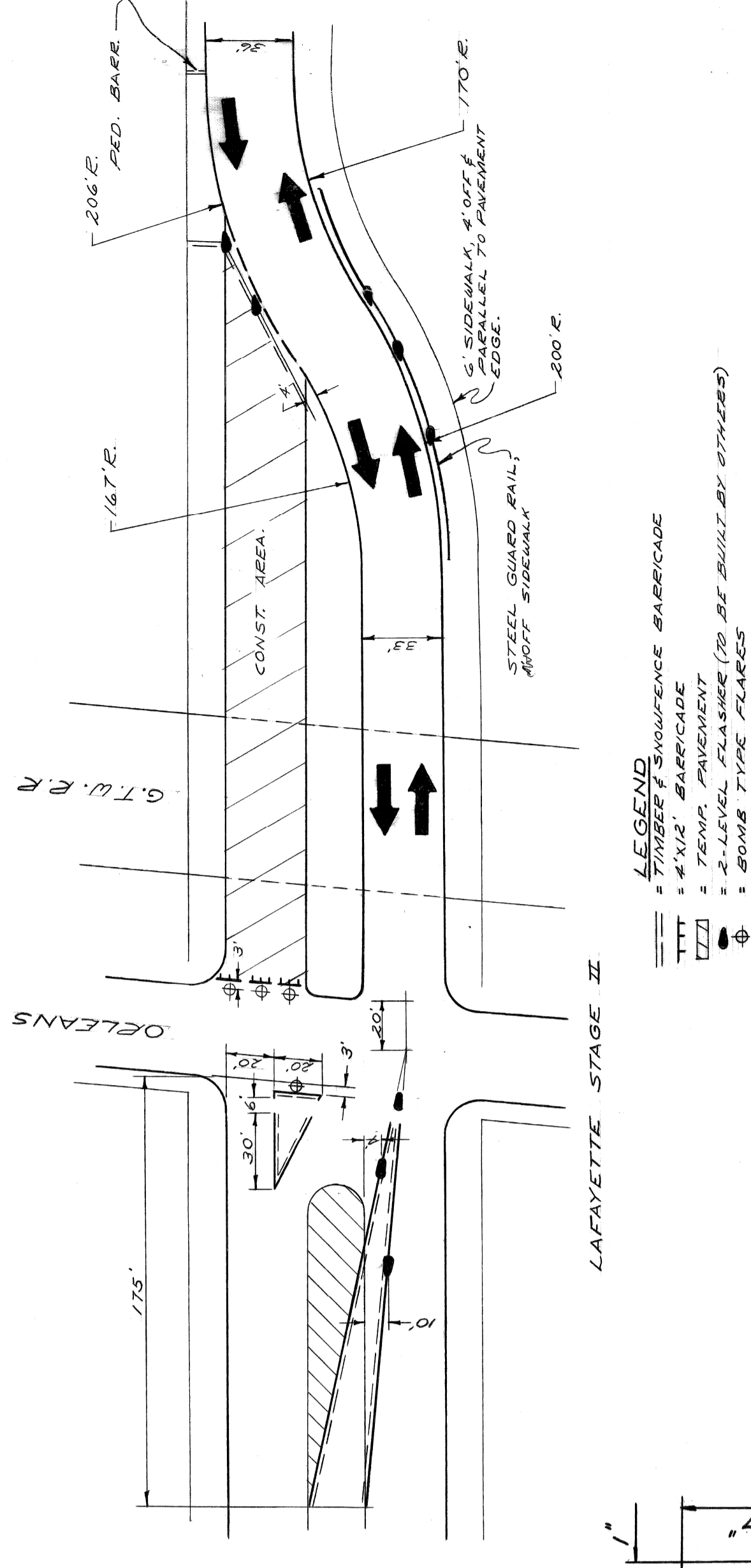

- LEGEND**
- ▬ TIMBER & SHOWENCE BARBERCADE
 - ▬ 4"x12" BARBERCADE
 - ▬ 2"x12" PAVEMENT
 - ▬ 1" CONC. CURB (TO BE BUILT BY OTHERS)
 - ⊕ 1" BOMB TYPE PLACES

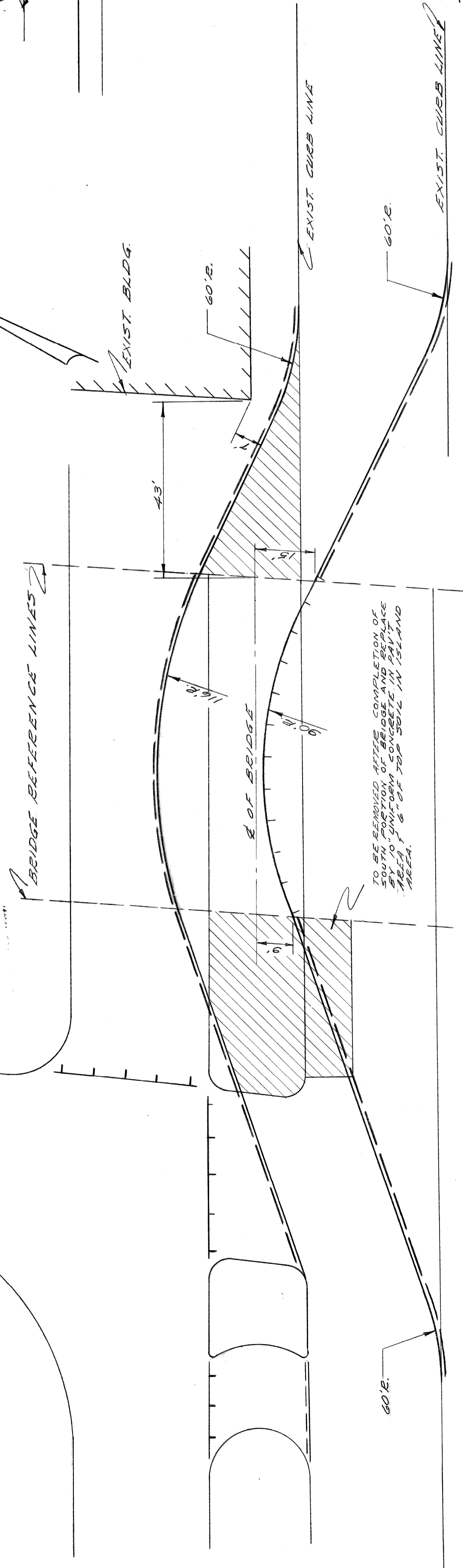
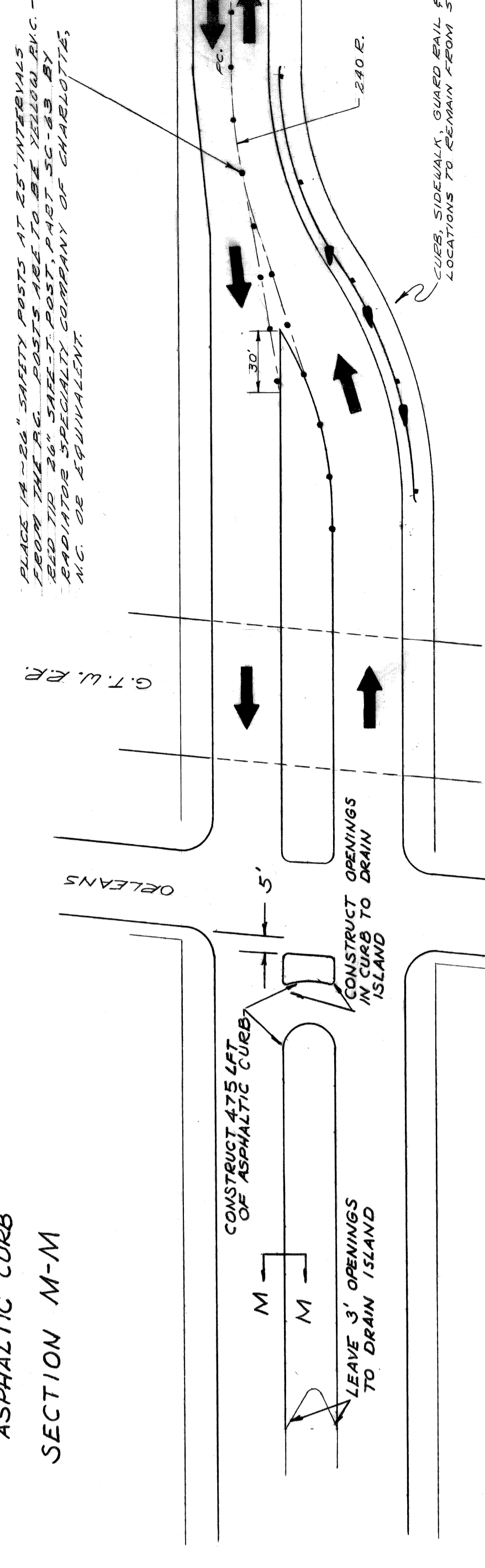

SECTION II-II

CITY OF DETROIT DEPARTMENT OF PUBLIC WORKS CITY ENGINEERS OFFICE BUREAU OF HIGHWAYS AND EXPRESSWAYS RAILROAD GRADE SEPARATION	LARNED ST. BRIDGE X069 & LAFAYETTE AVE. BRIDGE X072 OVER GRAND TRUNK WESTERN RAILROAD	SHEET 44 OF 46 SHEETS
		CONTRACT No. PW3988
APPROVED ENGINEER OF STREETS <i>Richard B. Chapman</i>	DESIGNED BY L. CHAPMAN	REVISIONS LOCATED BY COORDINATES ON SHEET
ASSIST. ENGINEER IN CHARGE HIGHWAYS AND EXPRESSWAYS <i>Walter K. Palmer</i>	TRACED BY J.C. MASCAGNE	
CITY ENGINEER	CHECKED BY	
REVISIONS LOCATED BY COORDINATES ON SHEET	DRAWN BY	
REVISIONS LOCATED BY COORDINATES ON SHEET	REVISIONS LOCATED BY COORDINATES ON SHEET	DRWG NO. P-303
REVISIONS LOCATED BY COORDINATES ON SHEET	REVISIONS LOCATED BY COORDINATES ON SHEET	DATE MAR. 1962

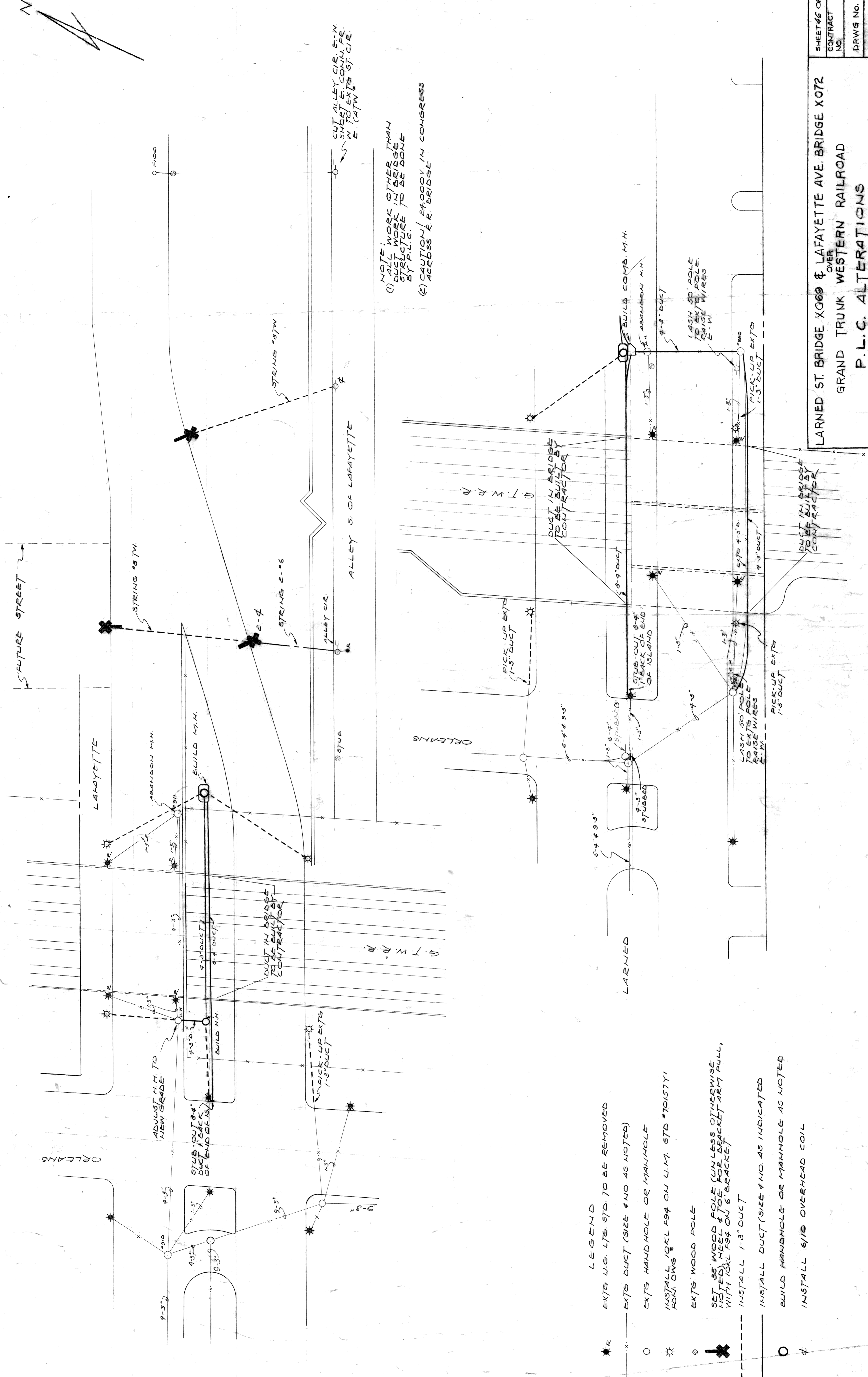

NOTE: WORK OTHER THAN STRUCTURE TO BE DONE BY P.L.C.
 (1) ALL WORK OTHER THAN STRUCTURE TO BE DONE BY P.L.C.
 (2) CAUTION! 24000V. IN CONGRESS ACCESS R.R. BRIDGE

- LEGEND**
- * R EXTS U.G. L.T.S. STD. TO BE REMOVED
 - EXTS DUCT (SIZE & NO. AS NOTED)
 - ⊙ EXTS HANDHOLE OR MANHOLE
 - ⊙ INSTALL 10KLV F94 ON U.M. STD *TOUSTY*
 - ⊙ EXTS. WOOD POLE
 - ⊙ SET 35' WOOD POLE (UNLESS OTHERWISE NOTED) HEEL & TOE FOR BRACKET ARM PULL, WITH 10KLV F94 ON 6" BRACKET
 - INSTALL 1-3" DUCT
 - INSTALL DUCT (SIZE & NO. AS INDICATED)
 - ⊙ BUILD HANDHOLE OR MANHOLE AS NOTED
 - ⊙ INSTALL 6/10 OVERHEAD COIL

SCALE: 1"=20'-0"

LARNED ST. BRIDGE X069 & LAFAYETTE AVE. BRIDGE X072
 OVER
 GRAND TRUNK WESTERN RAILROAD
 P.L.C. ALTERATIONS

DATE	DESCRIPTION	DRAWN BY	FILE NO.
			57-0360
			SHEET NO.
			1 OF 1
			DATE
			22-MAR-62
PUBLIC LIGHTING COMMISSION CITY OF DETROIT		CONTRACT NO. PW3988	SHEET 46 OF 46 SHEETS
DRAWN BY: [Signature]		DRWG NO. L-305	DATE MAR 1962
CHECKED BY: [Signature]		PUBLIC LIGHTING COMMISSION CITY OF DETROIT	
APPROVED BY: [Signature]		LARNED ST. BRIDGE X069 & LAFAYETTE AVE. BRIDGE X072 OVER GRAND TRUNK WESTERN RAILROAD P.L.C. ALTERATIONS	

CITY OF DETROIT
 DEPARTMENT OF PUBLIC WORKS
 CITY ENGINEERS OFFICE
 BUREAU OF HIGHWAYS AND EXPRESSWAYS
 RAILROAD GRADE SEPARATION