

SHEET ASPHALT 36' WD.
 With 8" Foundation

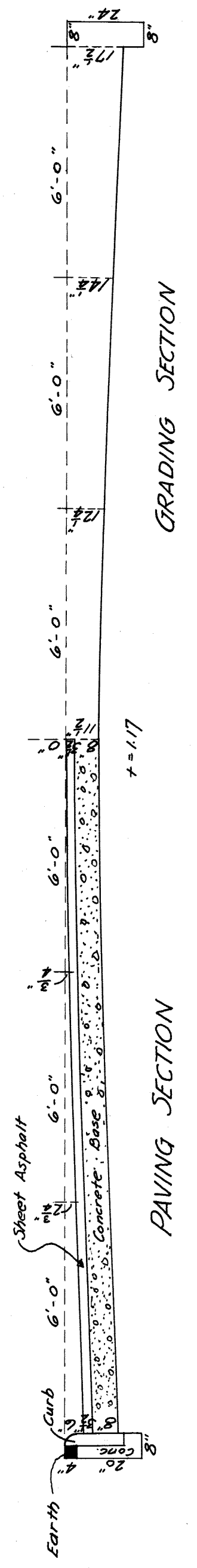

NOTE:
 New pavement to be surfaced with asphalt 3 1/2" thick instead of brick now used.
 Sidewalks to be rebuilt on present location except that the inner edge of walks shall not be closer than 6" from nearest coping edge of property retaining walls. Shade trees shall not be disturbed except where absolutely necessary to obtain the above results.

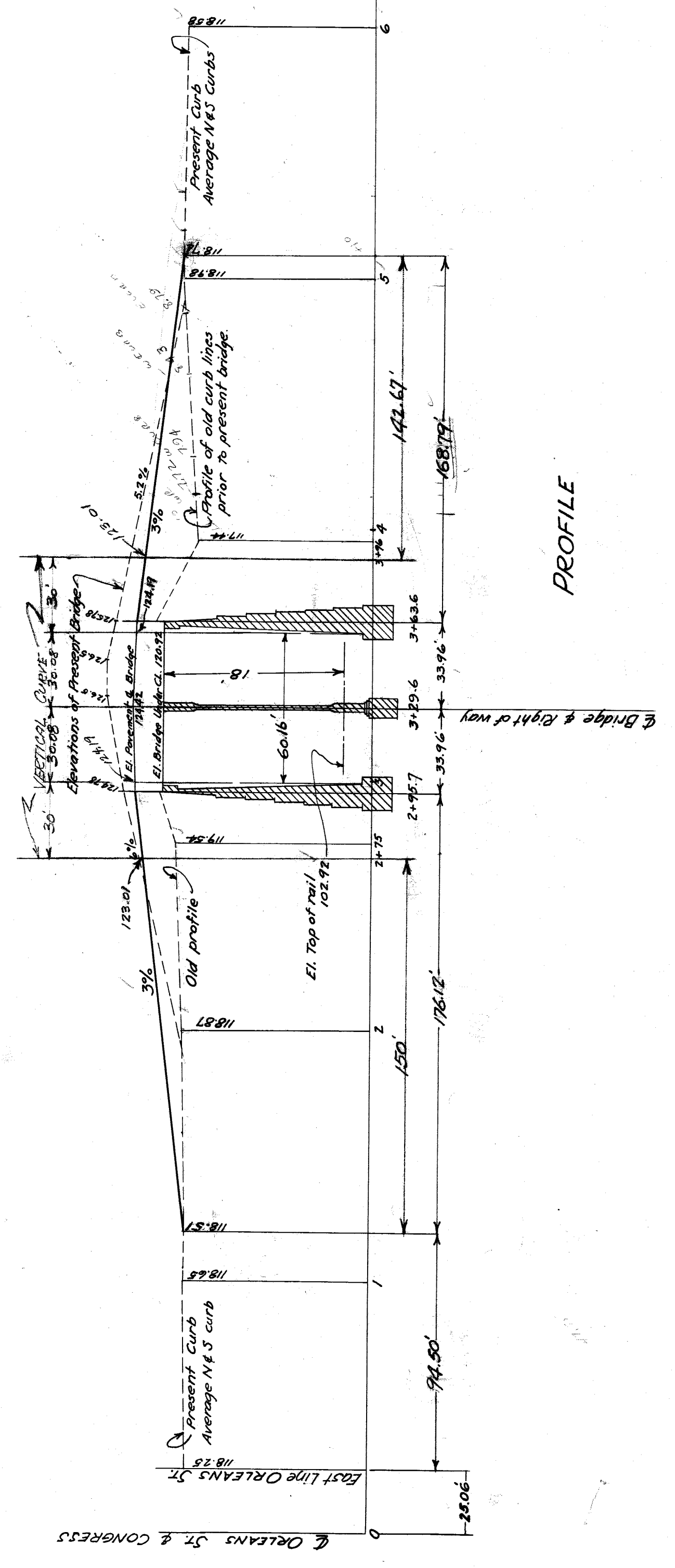

APPROVED *[Signature]* 1923
 CITY ENGINEER
 CHIEF ENGINEER G. T. RYAN SYSTEM - WESTERN LINES

CITY OF DETROIT
 DEPARTMENT OF PUBLIC WORKS
 CITY ENGINEER'S OFFICE
 DEPARTMENT OF GRADE SEPARATION & BRIDGES
 DEQUINDRE ST. GRADE SEPARATION
CONGRESS ST.

Made by AW. Scales 1" = 40'.
 Checked by: R. B. Plan 1" = 40'.
 Vertical 1" = 10'.
 1923

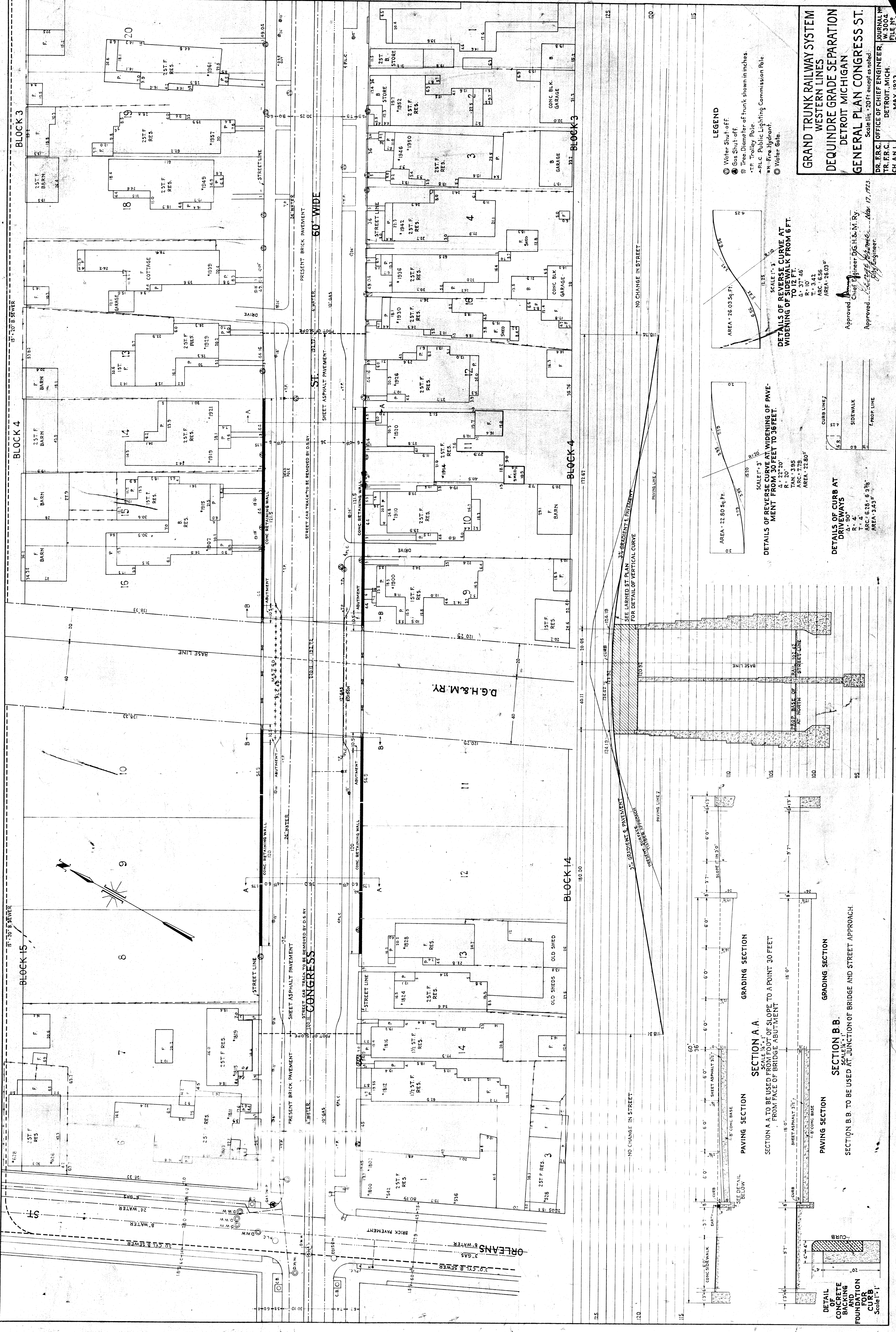

LEGEND

- ⊙ Water Shut-off
- ⊙ Gas Shut-off
- ⊙ Tree Diameter of trunk shown in inches.
- TP- Trolley Pole
- R-L-C Public Lighting Commission Pole
- F-F- Fire Hydrant
- ⊙ Water Gate

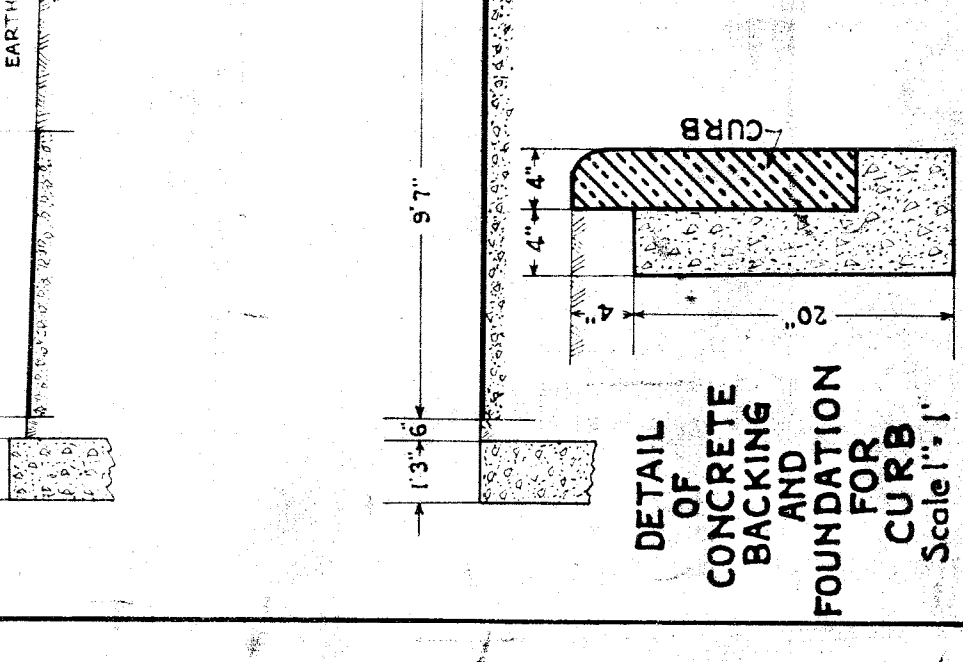
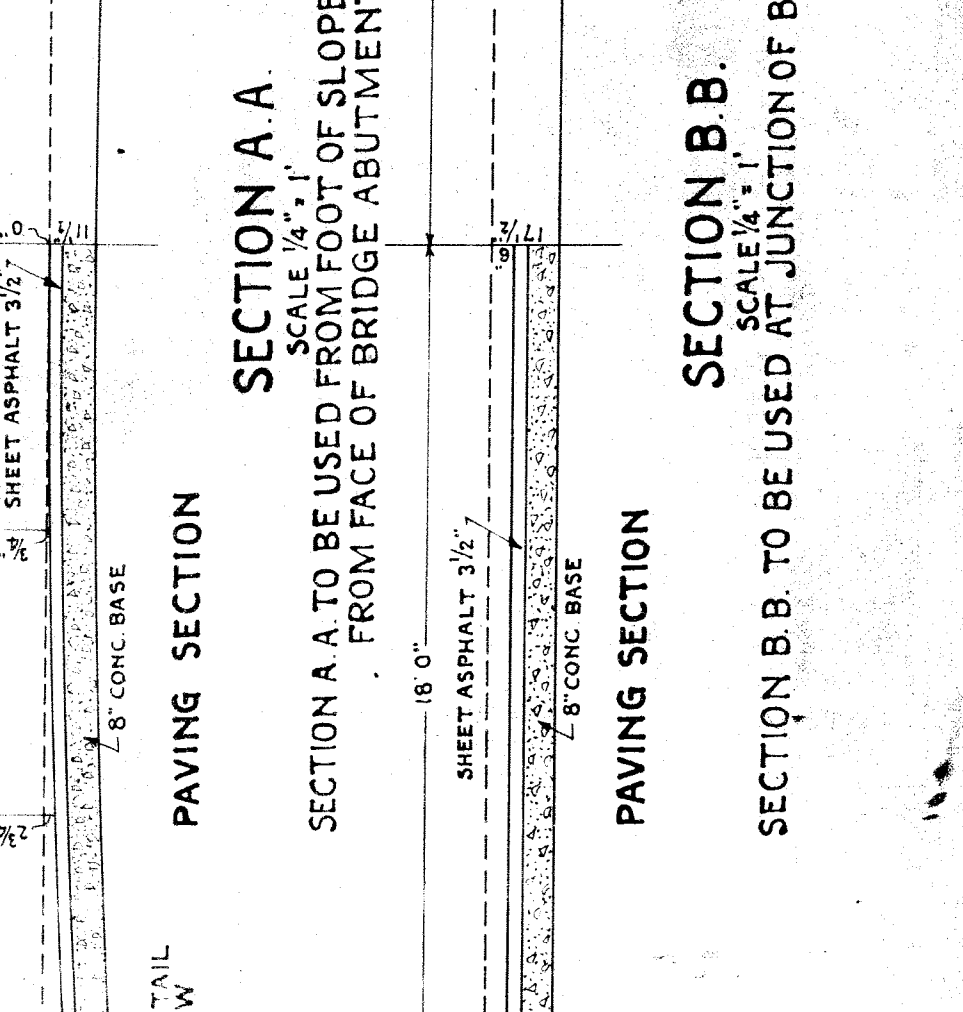
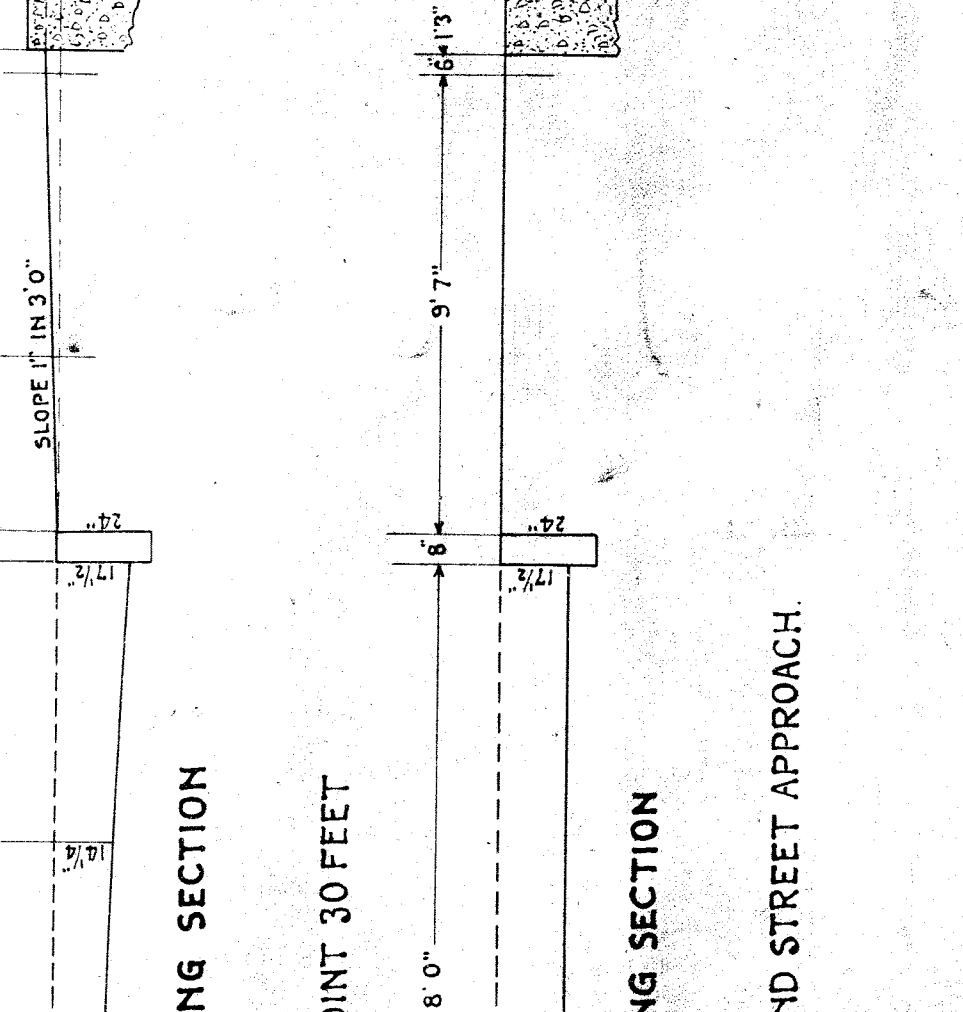
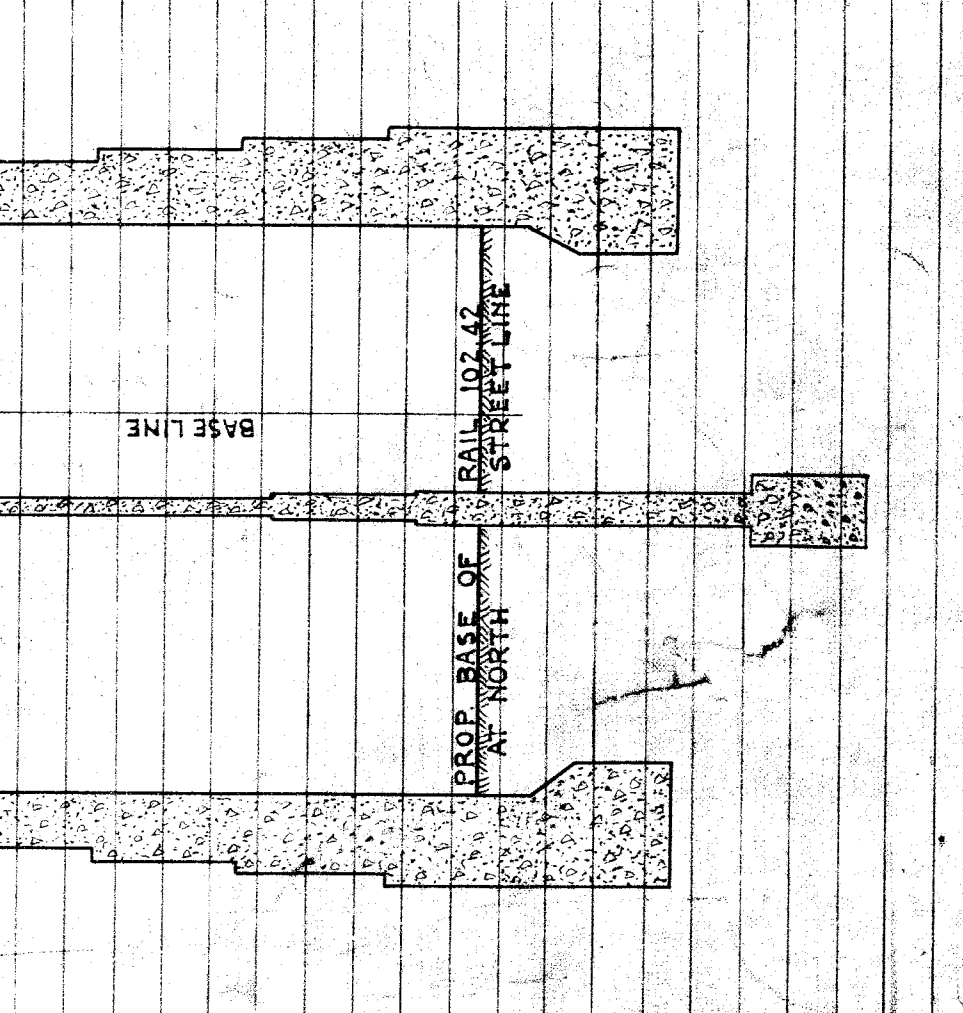
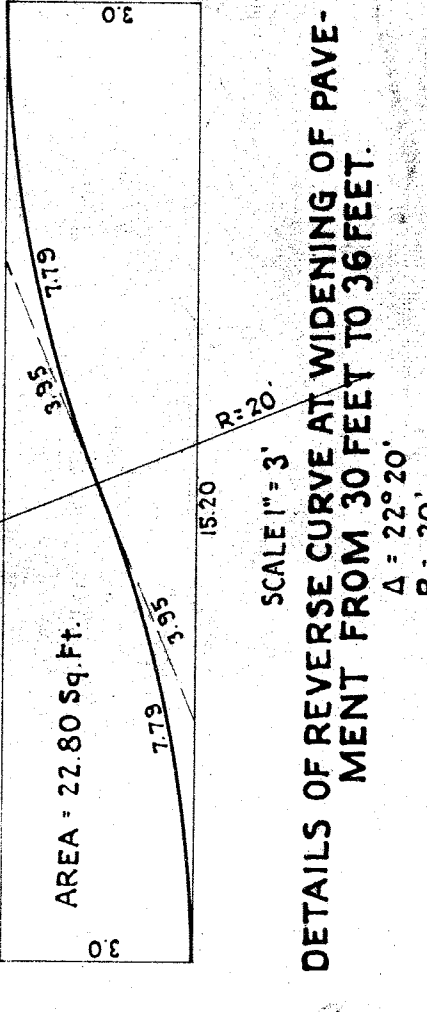
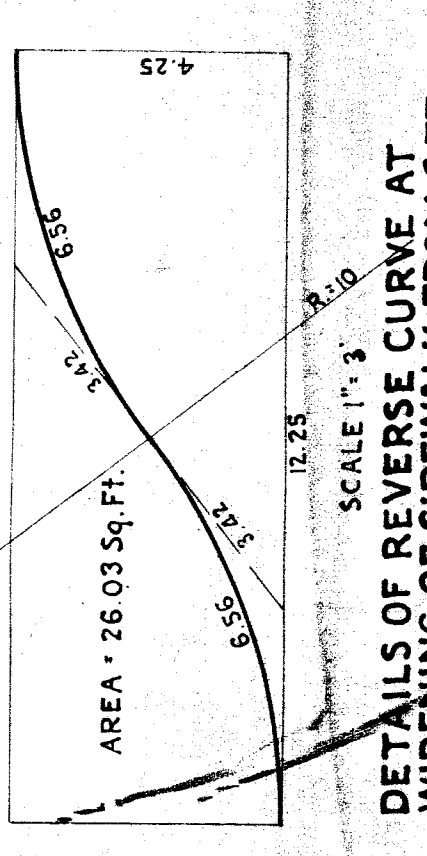

GRAND TRUNK RAILWAY SYSTEM
WESTERN LINES
DEQUINDE GRADE SEPARATION
DETROIT MICHIGAN
GENERAL PLAN CONGRESS ST.

Scale 1" = 20' ft. except as noted.
 DR. P.E.C. OFFICE OF CHIEF ENGINEER, JOURNAL NO. W. 3004
 TR. F.R.C. DETROIT, MICH. MAY, 1923
 CH. L.A.L. REVISED JUNE 16, 1923

Approved: *[Signature]*
 Chief Engineer D.G.H. & M. RY.
 Approved: *[Signature]*
 City Engineer

SECTION A. A.
 SCALE 1/4" = 1'
 SECTION A. TO BE USED FROM FOOT OF SLOPE TO A POINT 30 FEET FROM FACE OF BRIDGE ABUTMENT

SECTION B. B.
 SCALE 1/4" = 1'
 SECTION B. B. TO BE USED AT JUNCTION OF BRIDGE AND STREET APPROACH

PAVING SECTION

GRADING SECTION

GRADING SECTION

DETAIL CONCRETE BACKING AND FOUNDATION FOR CURB
 Scale 1" = 1'

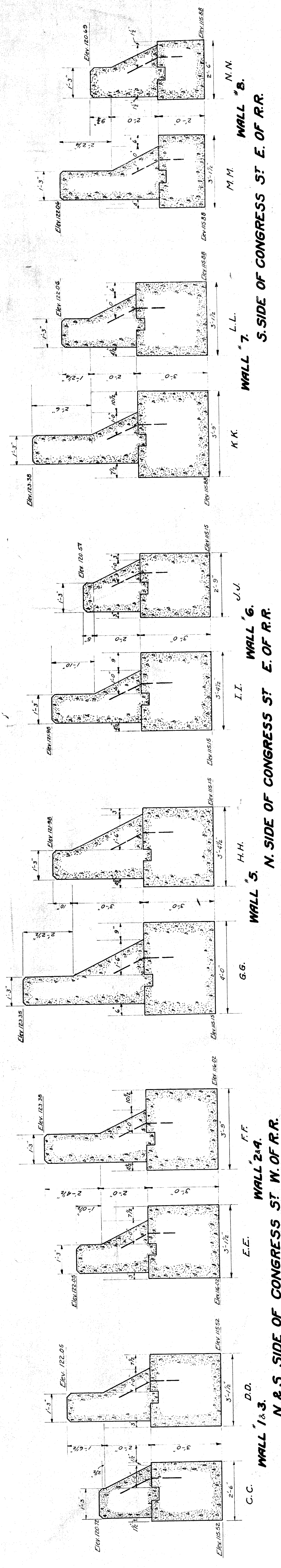

WALL # 7.
S. SIDE OF CONGRESS ST. E. OF R.R.

WALL # 6.
N. SIDE OF CONGRESS ST. E. OF R.R.

WALL # 5.
N. & S. SIDE OF CONGRESS ST. W. OF R.R.

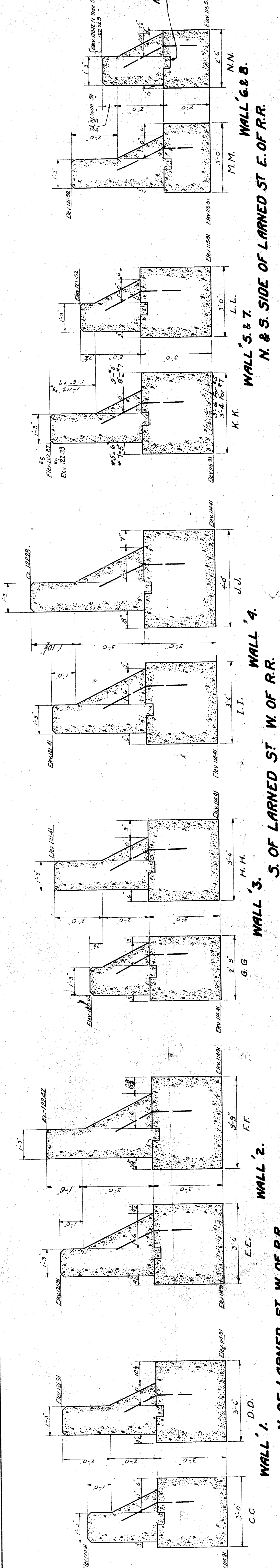

WALL # 13.
N. & S. SIDE OF LARNED ST. E. OF R.R.

WALL # 14.
S. OF LARNED ST. W. OF R.R.

WALL # 15.
N. OF LARNED ST. W. OF R.R.

NOTE:
ALL CONSTRUCTION KEYS FOR
STREET RETAINING WALLS TO
BE 1" X 8"
ALL OTHERS TO STREET BE
AS SHOWN
ALL OTHERS TO STREET BE
AS SHOWN

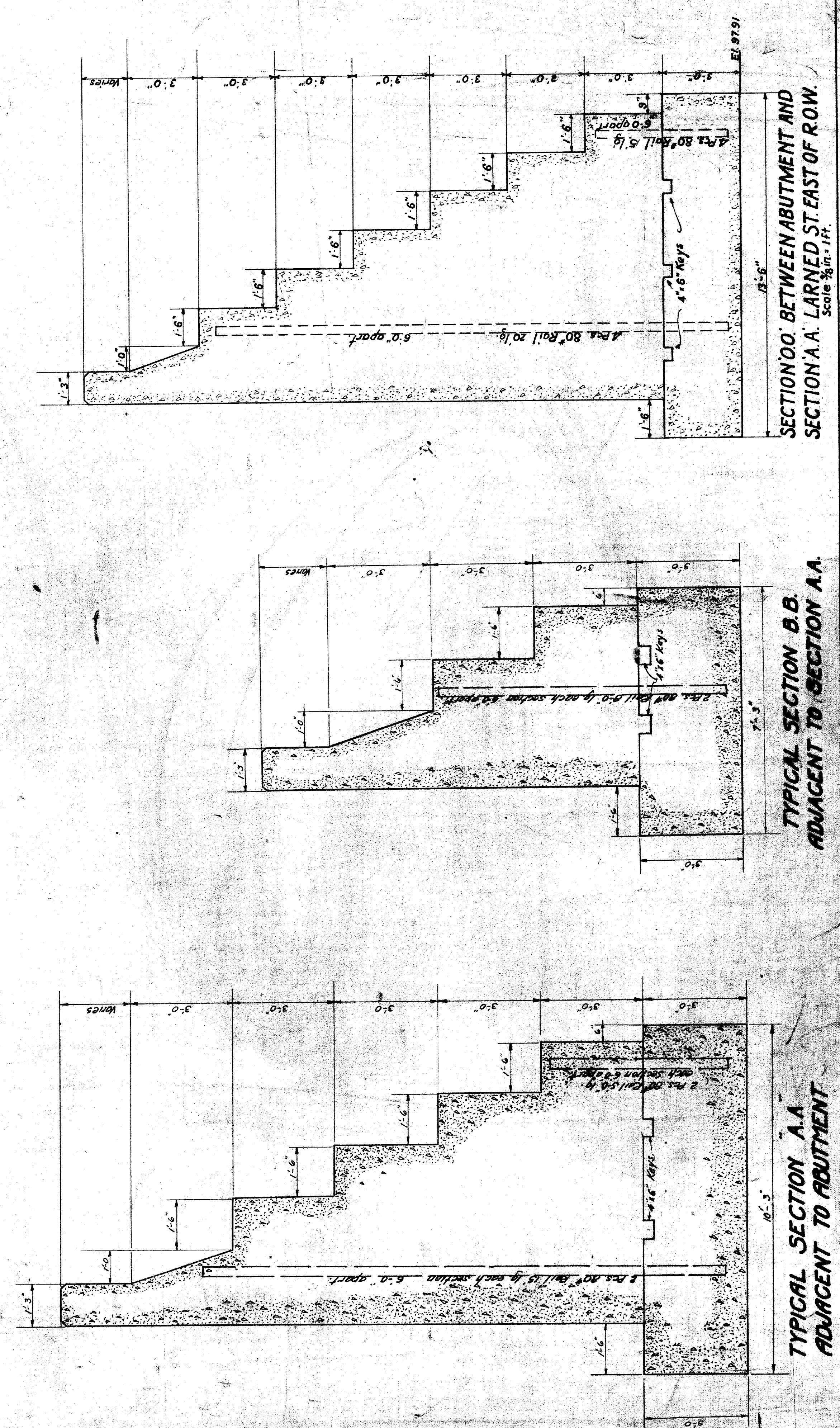

TYPICAL SECTION A.A.
ADJACENT TO ABUTMENT

TYPICAL SECTION B.B.
ADJACENT TO SECTION A.A.

**SECTION 'O.O.' BETWEEN ABUTMENT AND
SECTION 'A.A.' LARNED ST. EAST OF ROW.**
SCALE 3/8" = 1'-0"

Approved: *[Signature]*
Chief Engineer D.C.H. & M. Ry.
Approved: *[Signature]*
City Engineer
Nov. 17, 1923

**GRAND TRUNK RAILWAY SYSTEM
WESTERN LINES
DEQUINDRE GRADE SEPARATION
DETROIT, MICHIGAN
STREET RETAINING WALL SECTIONS**

SCALE 1/2" = 1'-0"
EXCEPT AS INDICED
OFFICE OF CHIEF ENGINEER
DETROIT, MICHIGAN
MAY 1923
JOURNAL NO. W-3015
FILE D146-2
REVISED JUNE 20, 1923
REVISIONS JUNE 20, 1923

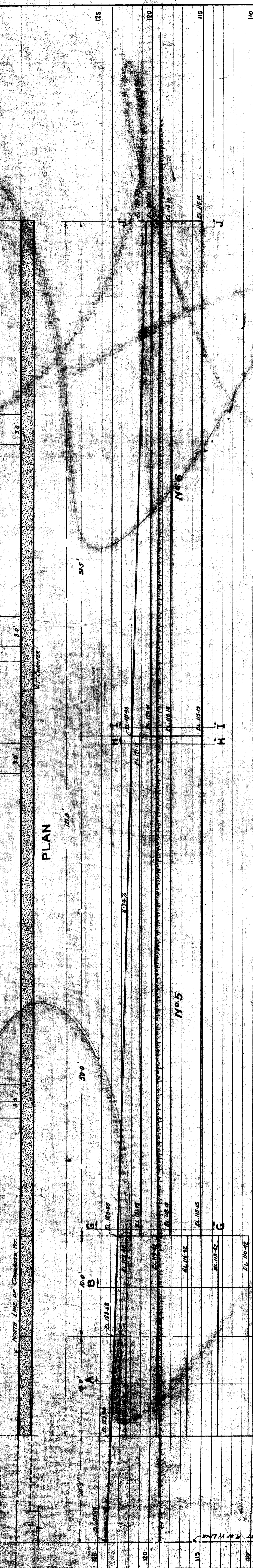

ELEVATION

WALL N. SIDE OF STREET - E. OF R. OF W.

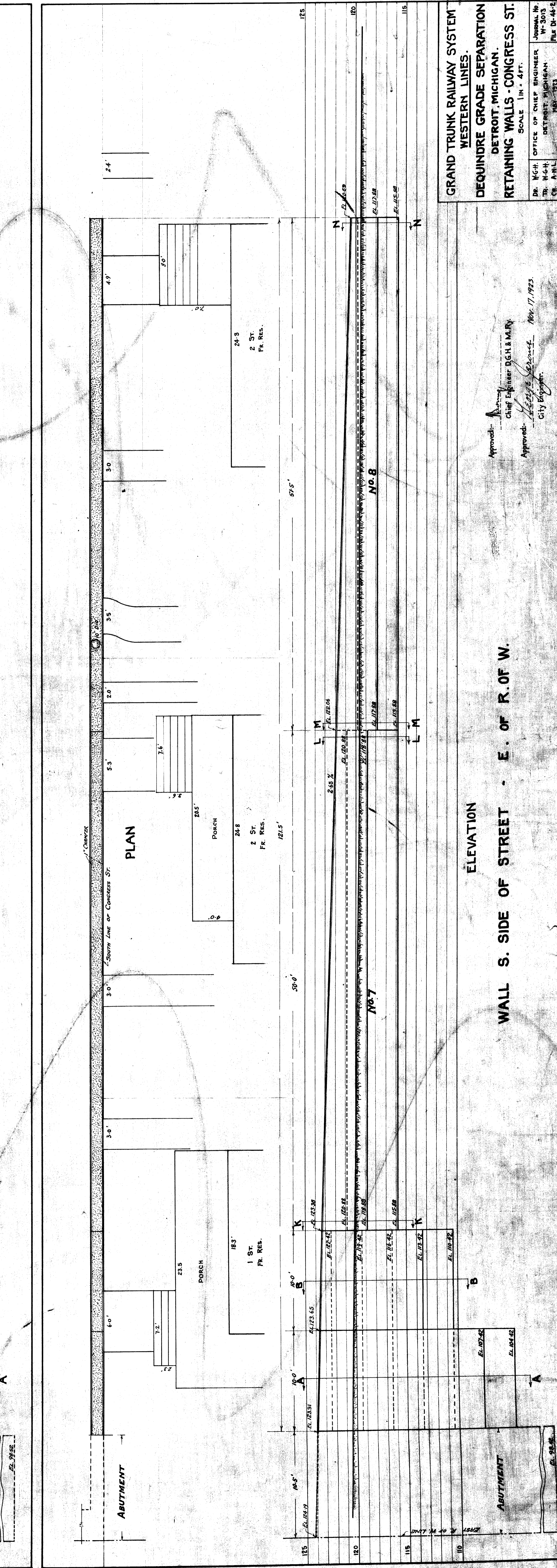

ELEVATION

WALL S. SIDE OF STREET - E. OF R. OF W.

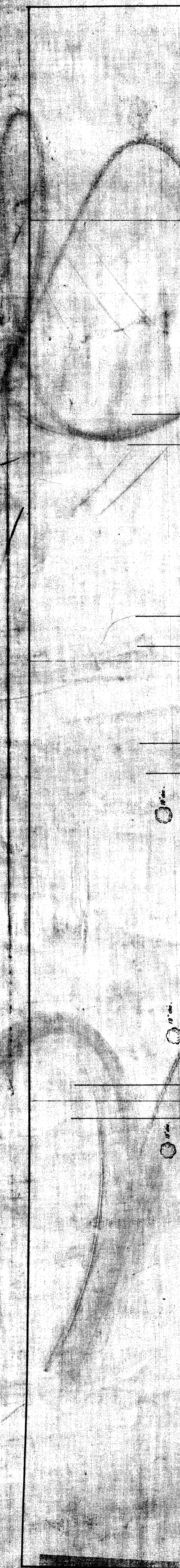

GRAND TRUNK RAILWAY SYSTEM
WESTERN LINES.
DEQUINDRE GRADE SEPARATION.
DETROIT, MICHIGAN.
RETAINING WALLS - CONGRESS ST.
SCALE 1 IN. = 4 FT.

Approved: *[Signature]*
Chief Engineer D.G.H.M.R.
Approved: *[Signature]*
City Engineer Nov. 17, 1923

DR. W.G.H. OFFICE OF CHIEF ENGINEER
DETROIT, MICHIGAN
JOURNAL No. W-3013
PL. D-465-E

