

152-6-13

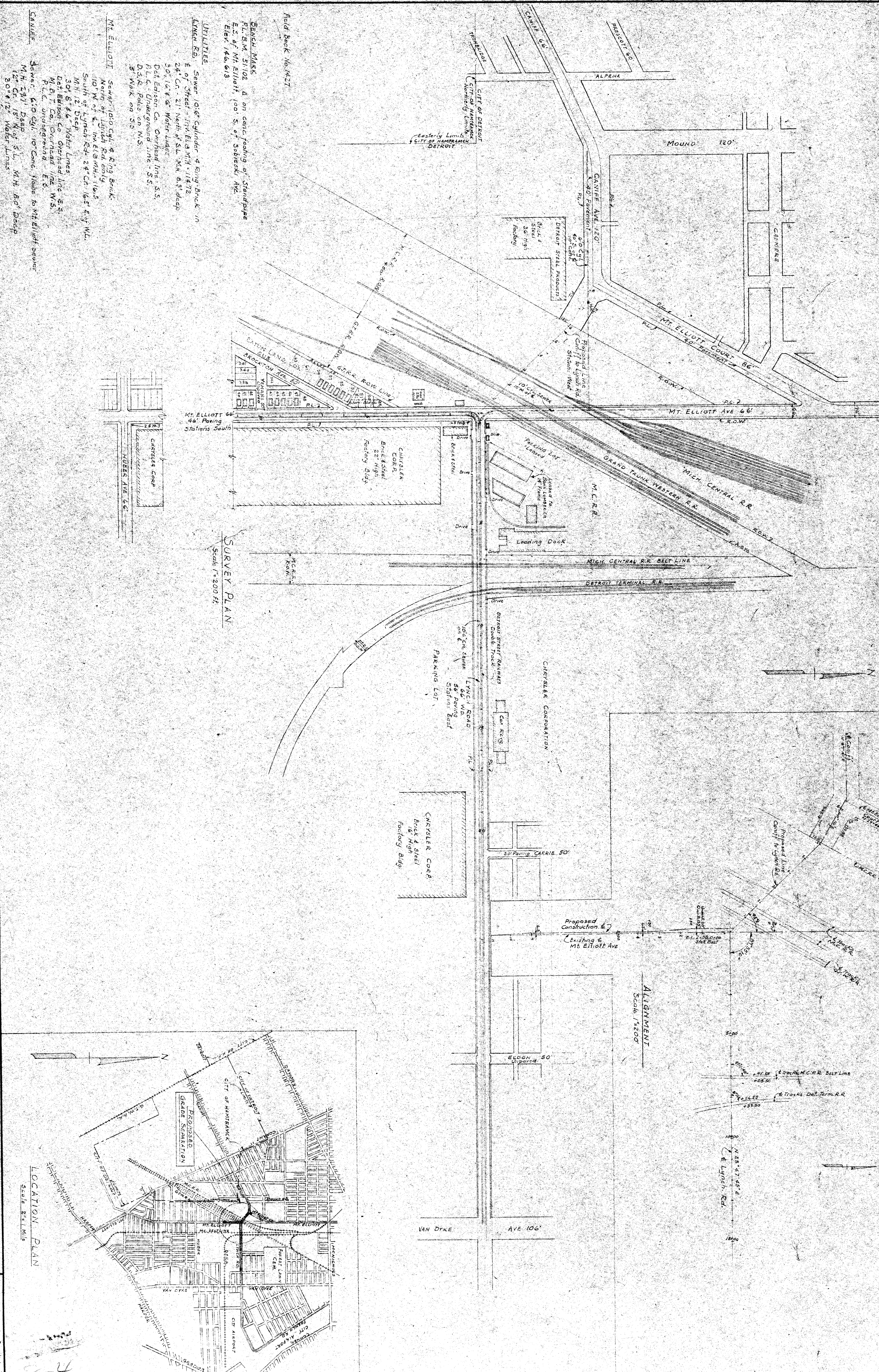

SURVEY PLAN  
Scale 1"=200 FT.

ALIGNMENT  
Scale 1"=500'

LOCATION PLAN  
Scale 2"=1 MILE

**SEARCH MARK**  
P.L. BM 51102 Δ on center footing of Standpipe  
E.S. of Mt. Elliott 100 S. of Sibley's Ave.  
Elev. 146.613

**UTILITIES**  
LYNCH RD. Sewer 10" 6" Cylinder 4 Ring Brick in  
E. of Street - 11th Elevation 147.12  
24" C. 21" North of S.W. M.H. 8' deep  
30" 12" 6" Water Lines  
Det. Edison Co. Overhead line S.S.  
H.C. Underground line S.S.  
D.S.R. Poles on S.S.  
5" WAK on S.S.

**MT. ELLIOTT** Sewer 10" 6" 4 Ring Brick  
North of Lynch Rd. 100 S.  
100 W. of E. 1st Elevation 146.5  
South of Lynch Rd. 24" Cr. 16.5" E. of W.L.  
M.H. 12' Deep  
30" 8" 6" Water Lines  
Det. Edison Co. Overhead line S.S.  
M.P.T. Co. Overhead line W.S.  
P.L.C. Underground E.S.

**CANIFF** Sewer 6" 6" 10" Concrete Pipes to Mt. Elliott sewer  
M.H. 24' Deep  
12" Cr. 15" N. of S.W. M.H. 8' Deep  
30" 8" 12" Water Lines

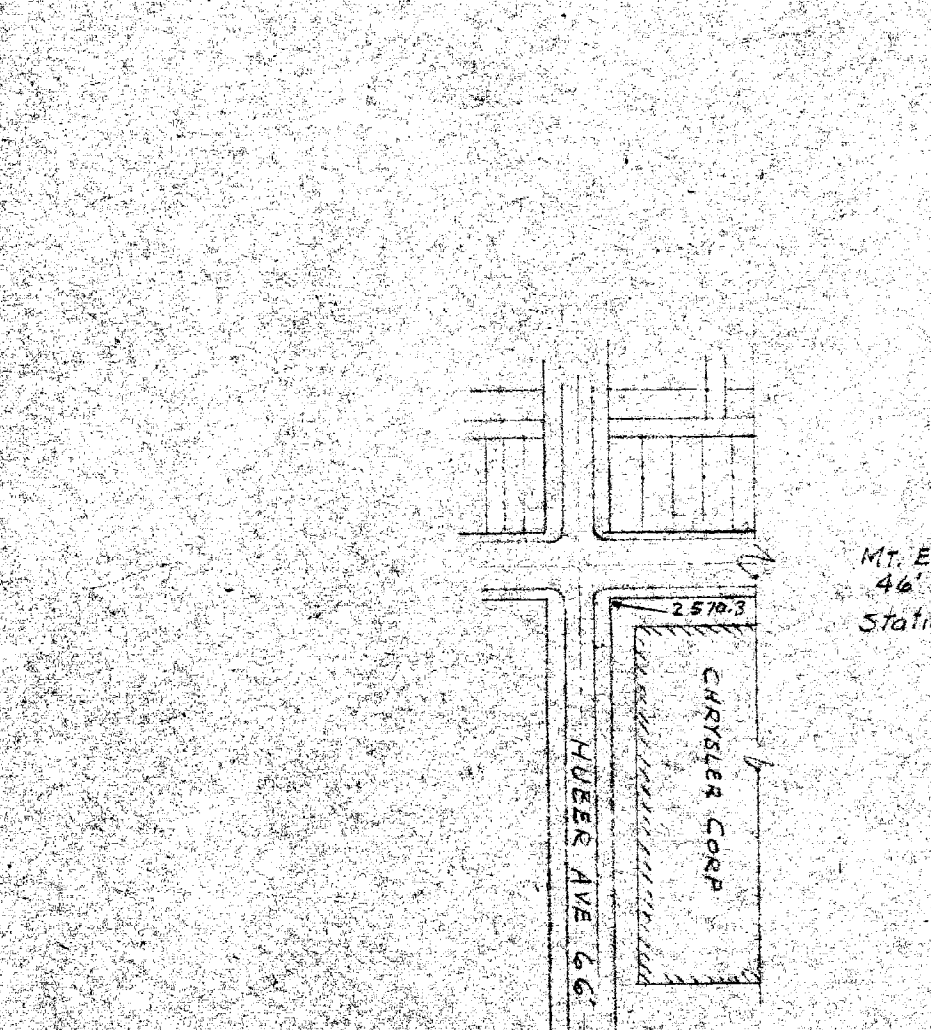

**DESIGNED BY**  
A. Bagnard

**TRACED BY**

**CHECKED BY**

**APPROVED:**

**CITY ENGINEER**

**GRADE SEPARATION**  
CANIFF AVE, LYNCH RD & MT ELLIOTT AVE  
M.C.R.R., G.T.W.R., M.C. BELTLINE & D.T.R.  
**SURVEY AND LOCATION PLAN**

**DEPARTMENT OF PUBLIC WORKS**  
CITY ENGINEERS OFFICE

**SHEET 1 OF 2 SHEETS**  
CONTINUED JOB NO. 27  
DRWG NO.  
DATE 2-22-44

NO.	REVISIONS	DATE	BY	DESCRIPTION
1				
2				
3				
4				
5				
6				
7				
8				
9				
10				



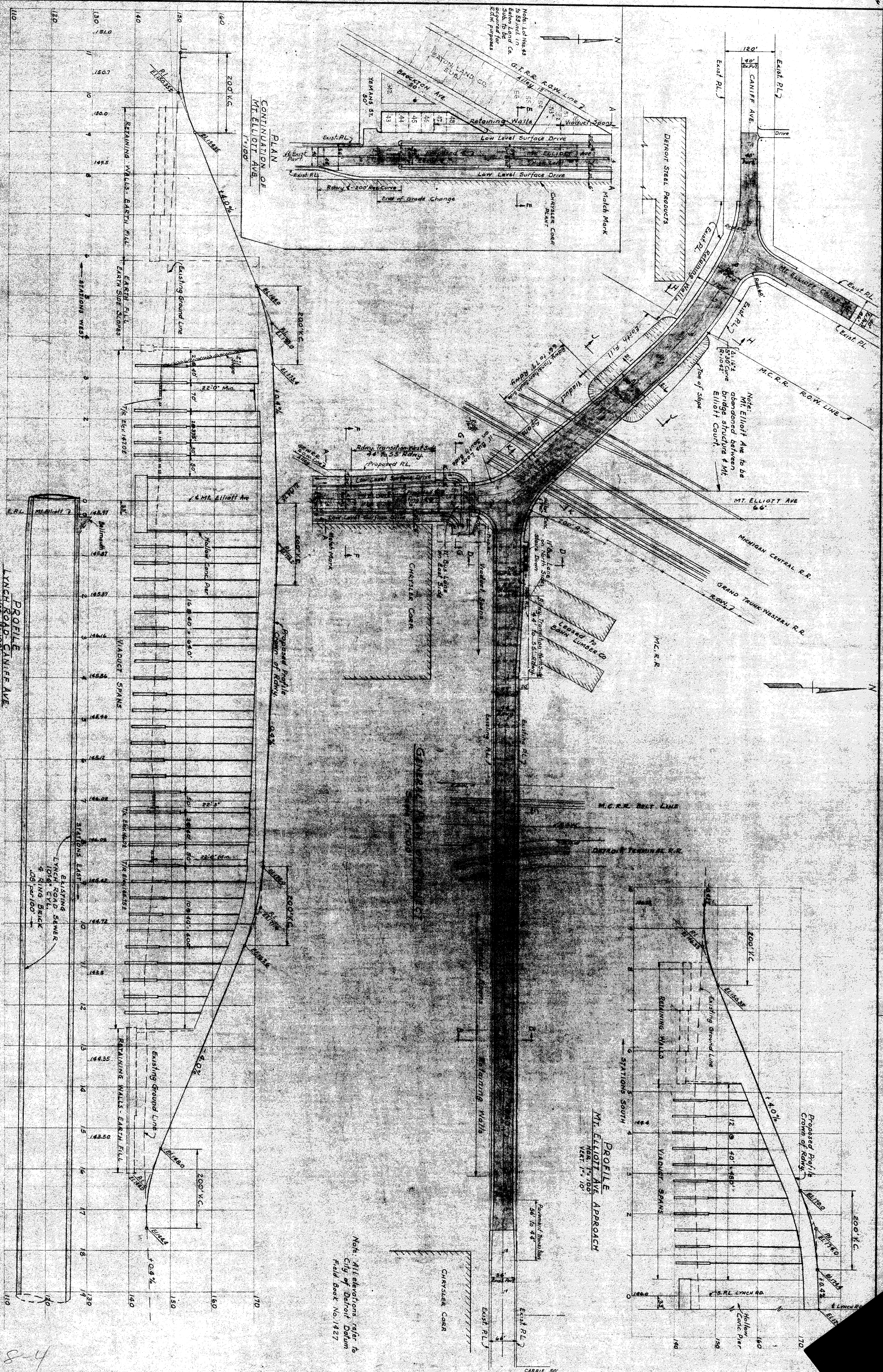

**CITY OF DETROIT**  
 DEPARTMENT OF PUBLIC WORKS  
 CITY ENGINEERS OFFICE

GRADE SEPARATION  
 CANIFF AVE, LYNCH ROAD & MT. ELLIOTT AVE  
 M.C.R.R., G.T.W.R.R., M.C. BELT LINE & D.T.R.R.

PRELIMINARY PLAN  
 PLAN AND PROFILE

SHEET 2 OF 4 SHEETS  
 JOB NO. 37  
 DRWG. NO.  
 DATE 2-22-44

NO.	DATE	DESCRIPTION	REVISIONS
1			
2			
3			
4			
5			
6			
7			
8			
9			
10			

8-4

Note: All elevations refer to City of Detroit Datum Field Book No. 1427



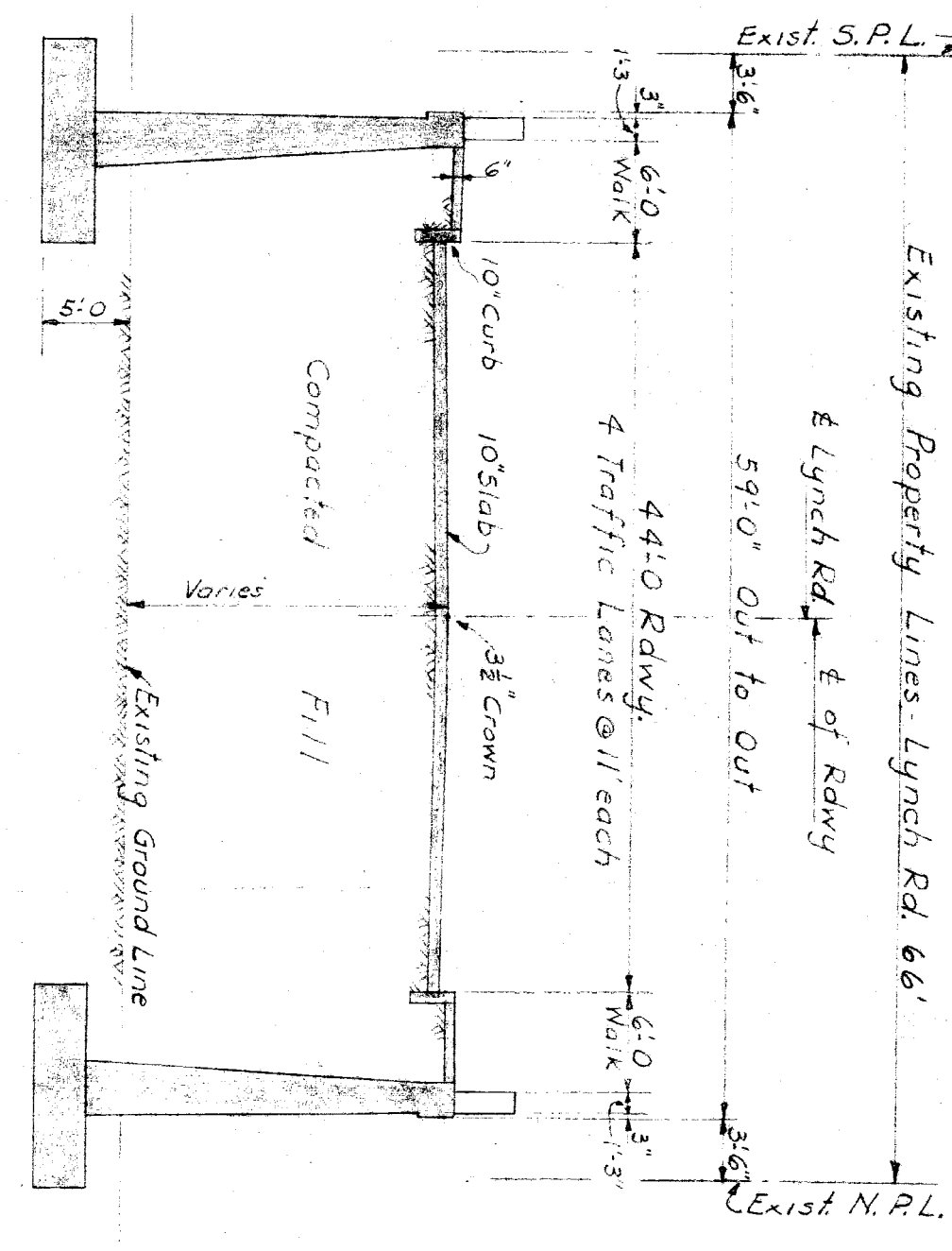

SECTION B-B  
RETAINING WALL SECTION  
LYNCH ROAD APPROACH  
3/8" = 1'-0"

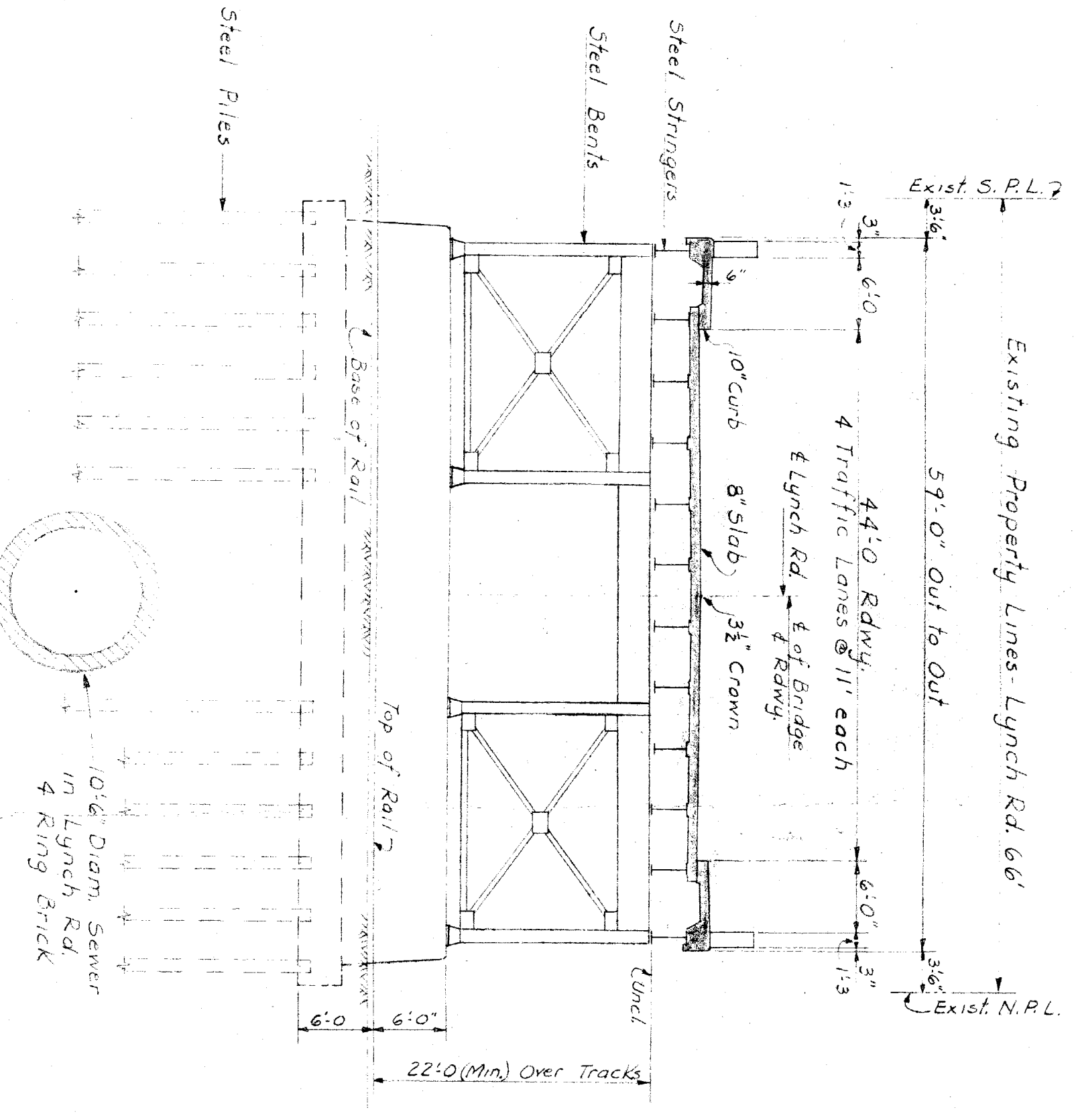

SECTION C-C  
VIADUCT SECTION  
LYNCH ROAD APPROACH  
3/8" = 1'-0"

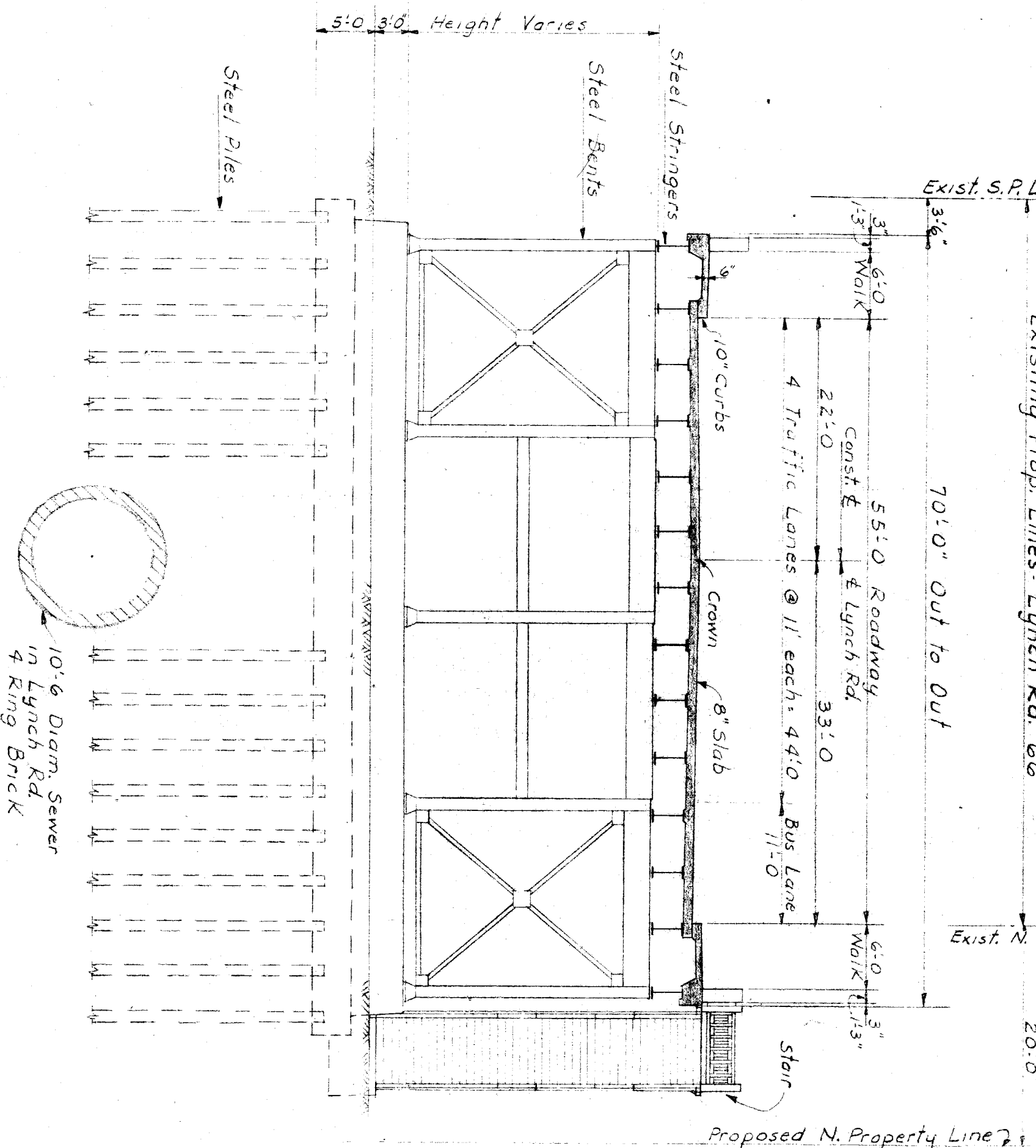

SECTION D-D  
LYNCH ROAD APPROACH  
VIADUCT SECTION AT BUS LANE  
3/8" = 1'-0"

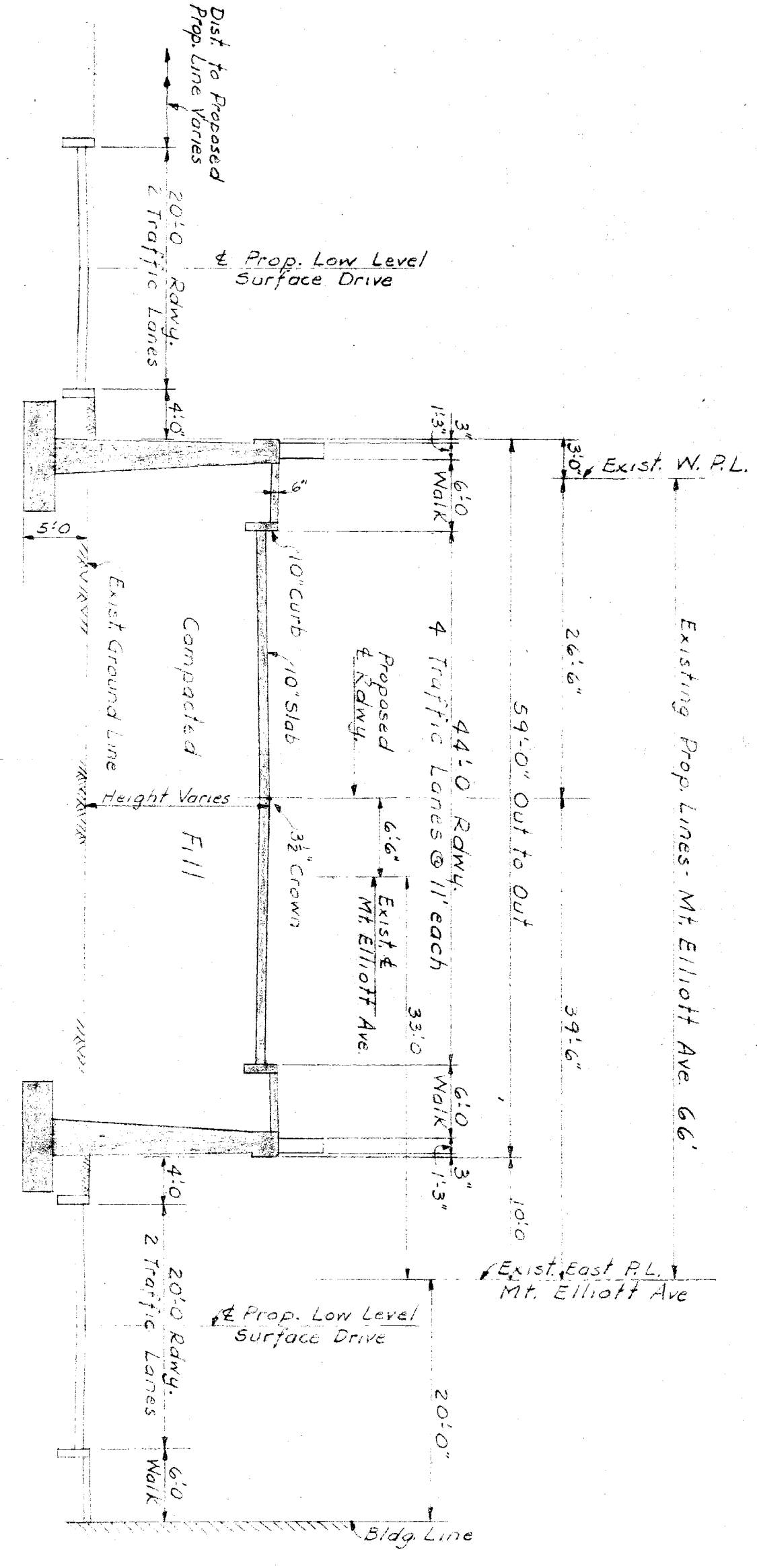

SECTION E-E  
MT. ELLIOTT AVE. APPROACH  
RETAINING WALL SECTION  
3/8" = 1'-0"

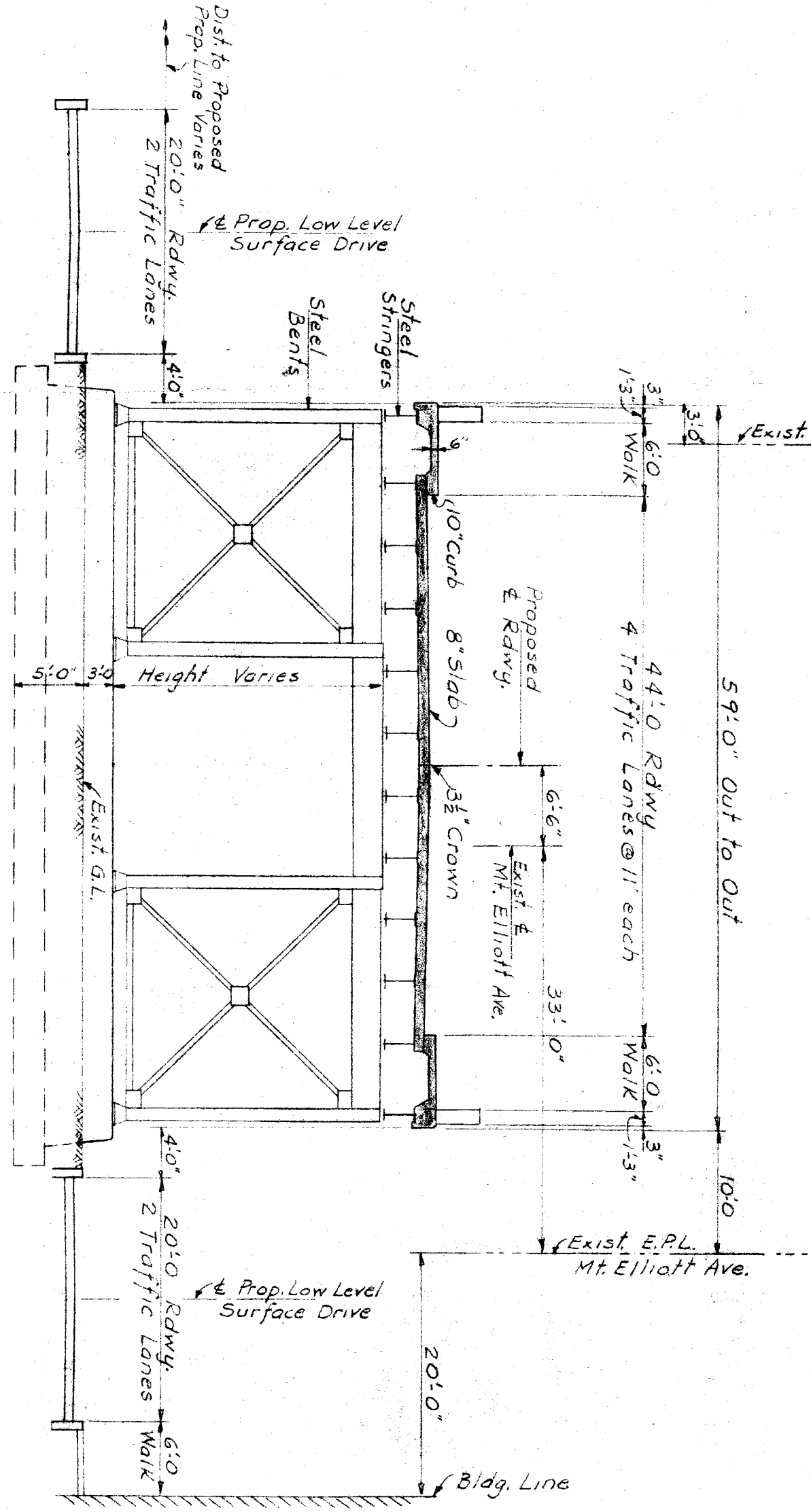

SECTION F-F  
MT. ELLIOTT AVE. APPROACH  
VIADUCT SECTION  
3/8" = 1'-0"

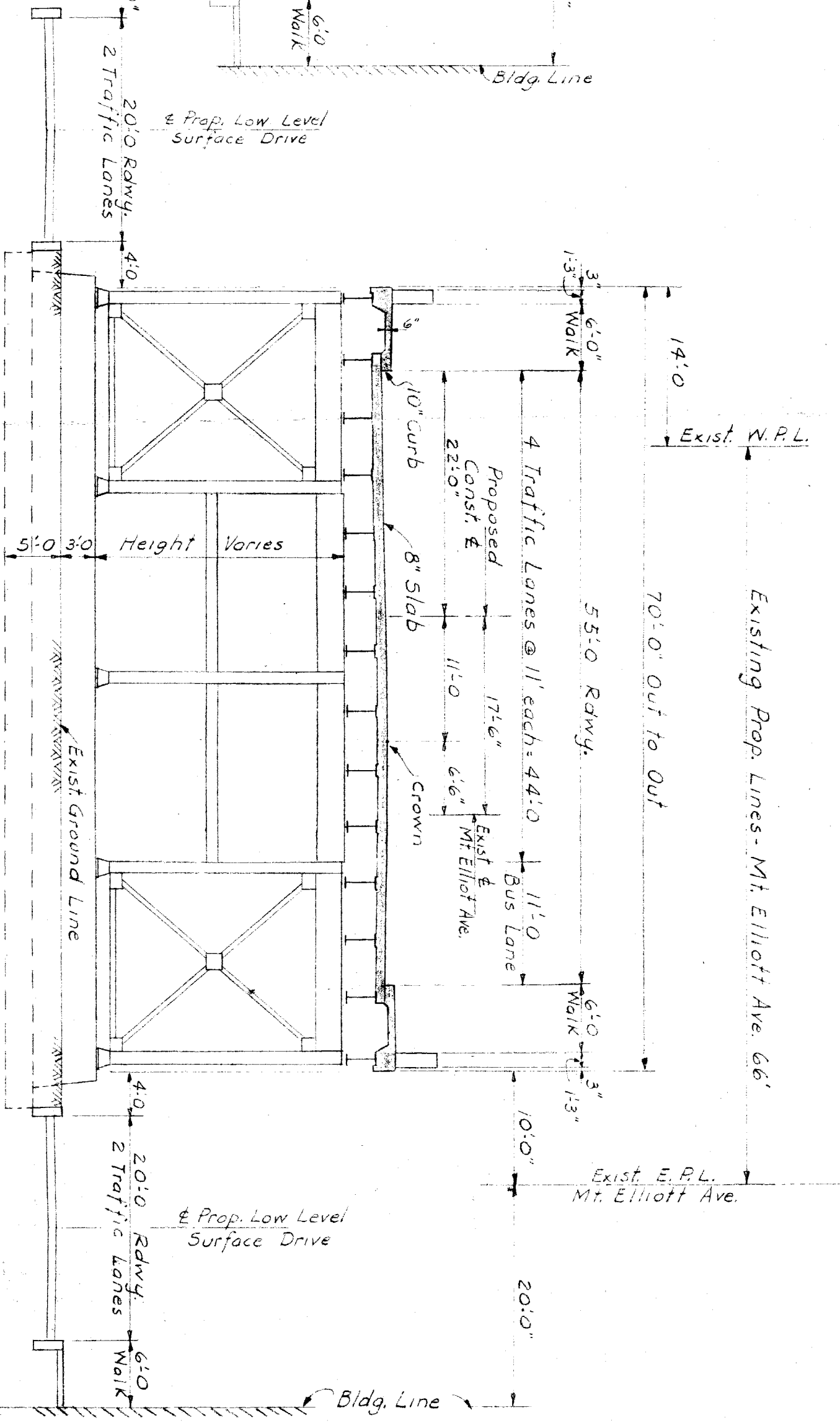

SECTION G-G  
MT. ELLIOTT AVE. APPROACH  
VIADUCT SECTION AT BUS LANE  
3/8" = 1'-0"

NO.	DATE	DESCRIPTION	BY	CHECKED BY
A		DESIGNED BY	A. Berarducci	
B		DRAWN BY	A. Berarducci	
C		TRACED BY		
D		CHECKED BY		
E		APPROVED		

CITY OF DETROIT  
DEPARTMENT OF PUBLIC WORKS  
CITY ENGINEERS OFFICE

GRADE SEPARATION  
CANIFF AVE., LYNCH ROAD & MT. ELLIOTT AVE.  
M.C.R., G.W.R., M.C. BELTLINE & D.T.R.  
PRELIMINARY PLAN  
TYPICAL SECTIONS  
SCALE: AS NOTED  
SHEET 3 OF 4 SHEETS  
JOB NO. 37  
DRWG NO.  
DATE 2-22-44

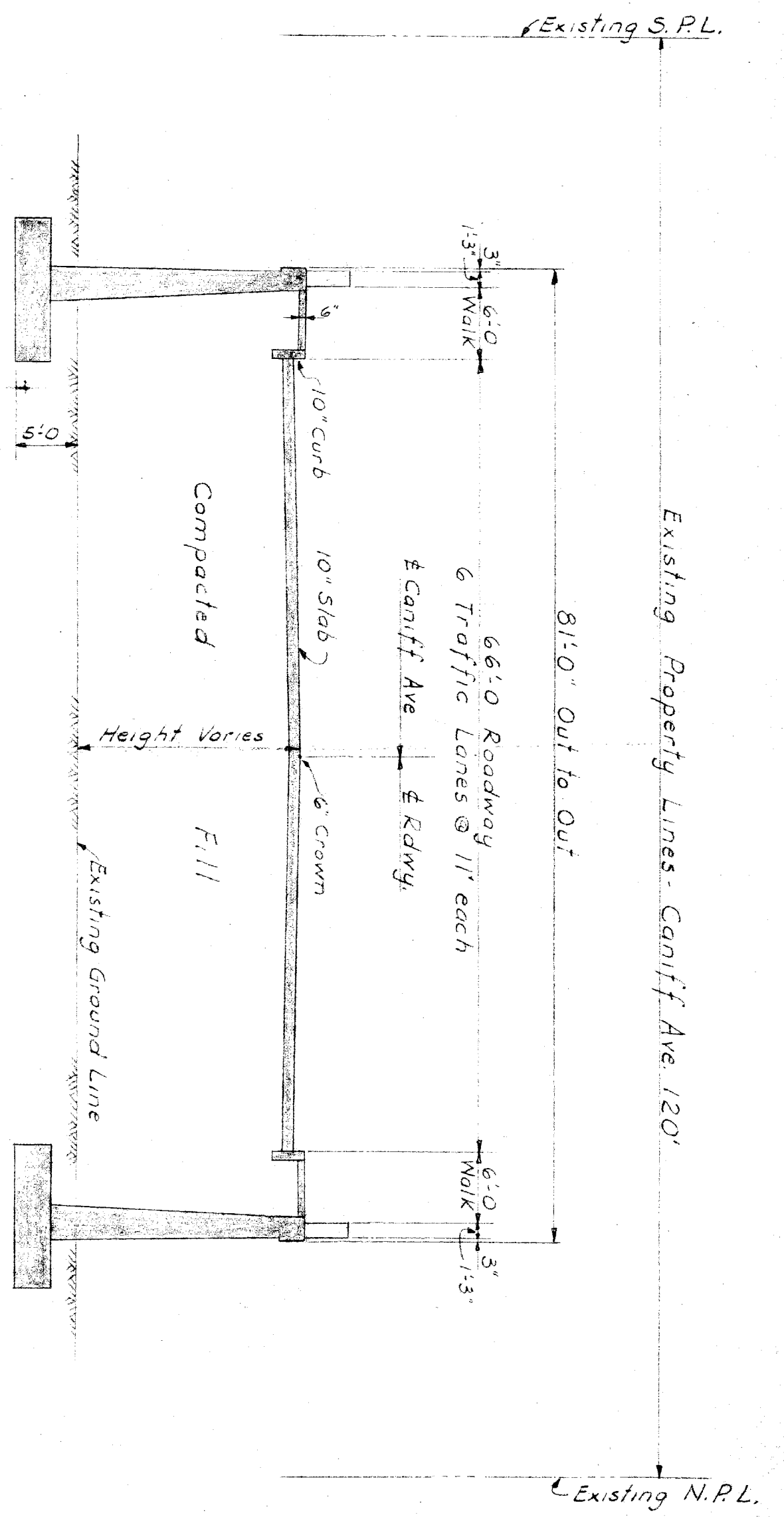

SECTION H-H  
CANIFF AVE APPROACH  
RETAINING WALL SECTION  
 $\frac{3}{32}'' = 1' = 0''$

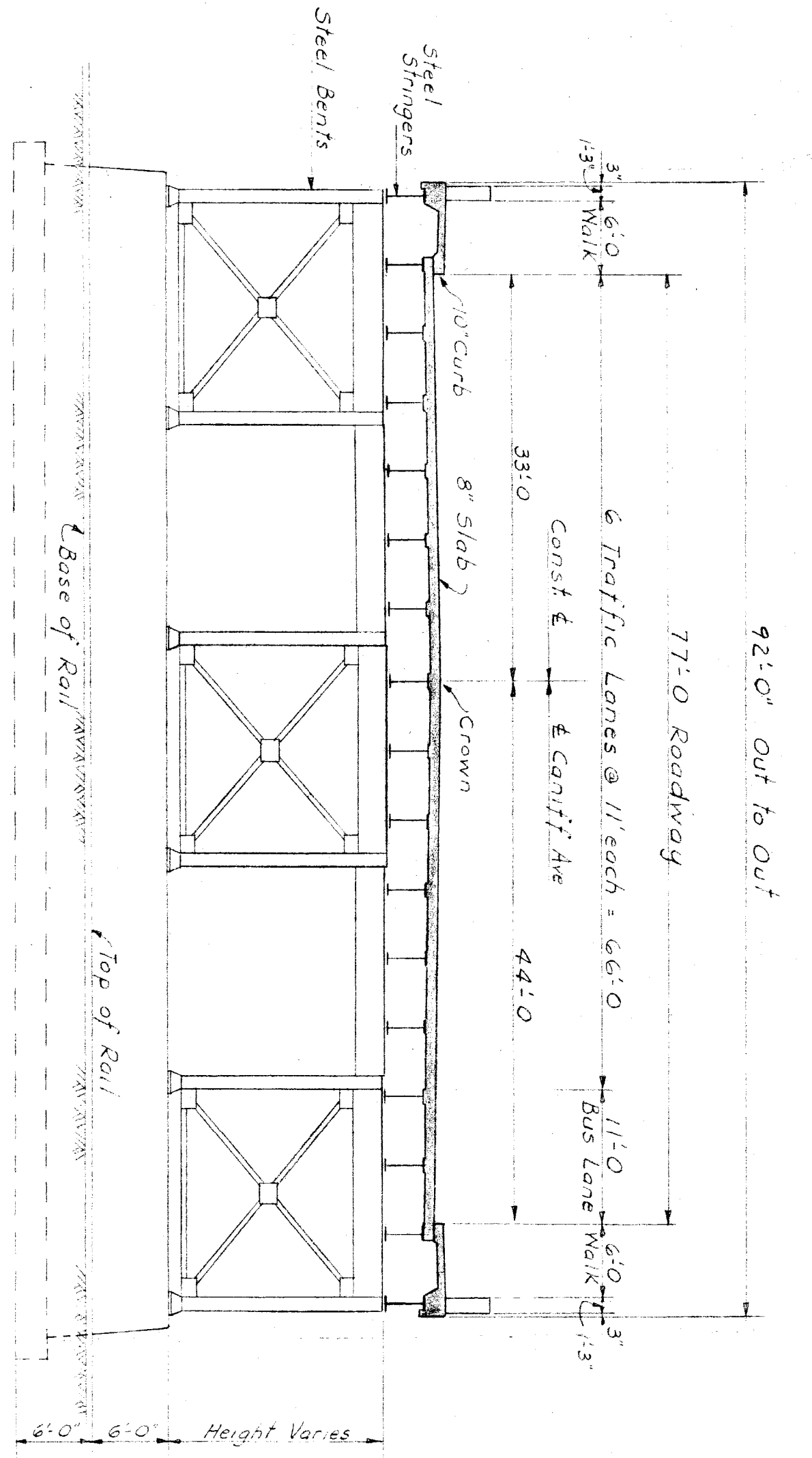

SECTION K-K  
CANIFF AVE APPROACH  
VIADUCT SECTION AT BUS LANE  
 $\frac{3}{32}'' = 1' = 0''$

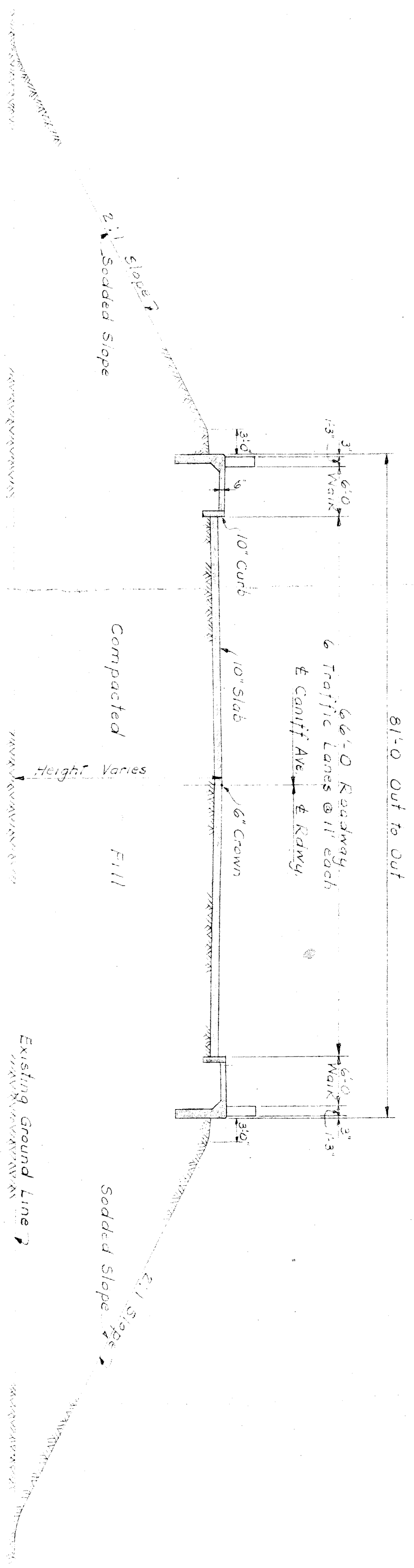

SECTION U-U  
CANIFF AVE APPROACH  
ROADWAY ON EARTH FILL  
 $\frac{3}{32}'' = 1' = 0''$

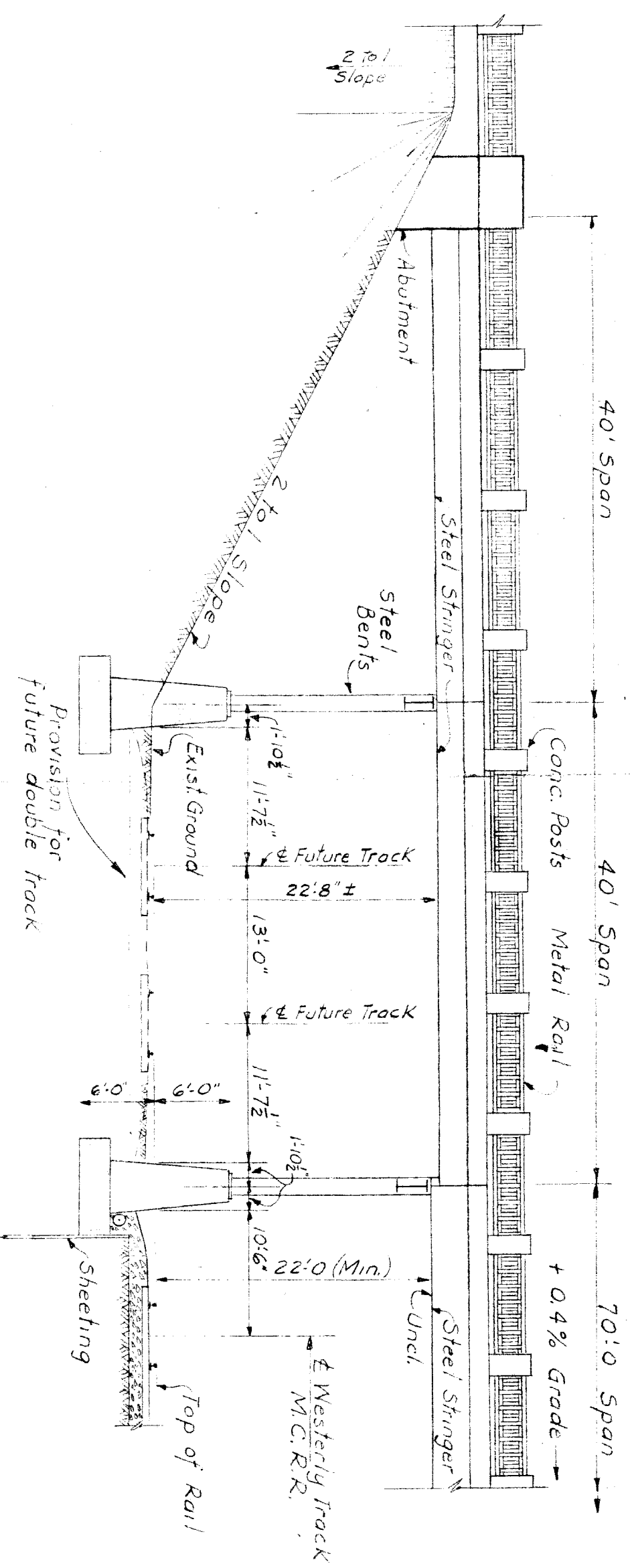

PART ELEVATION  
NEAR STATION 310.0 WEST  
PROVISION FOR FUTURE DOUBLE TRACK  
 $\frac{3}{32}'' = 1' = 0''$

LIGHT POLE DETAIL  
 $\frac{3}{32}'' = 1' = 0''$

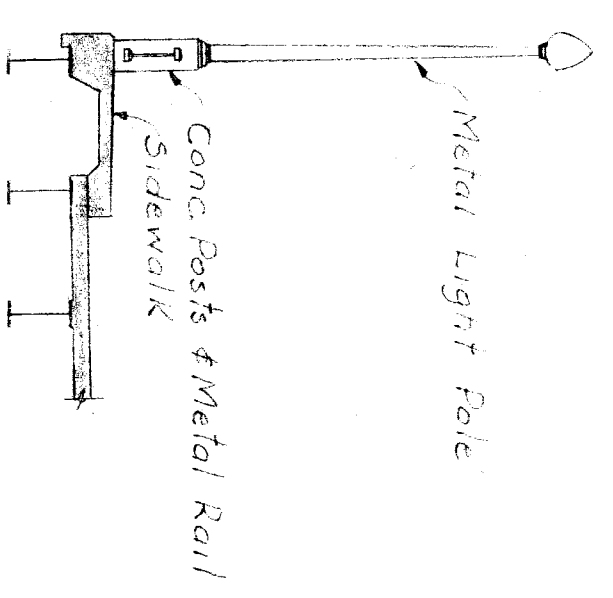

NO.	DATE	DESCRIPTION	BY	CHECKED	DATE
A					
B					
C					
D					
E					
F					
G					

REFERENCE	DESIGNED BY	APPROVED
	A. Berarducci	

DESCRIPTION	DRAWN BY	TRACED BY	CHECKED BY
	A. Berarducci		

CITY ENGINEER

SCALE
AS NOTED

TYPICAL CROSS SECTIONS

CITY OF DETROIT	DEPARTMENT OF PUBLIC WORKS
CITY ENGINEERS OFFICE	

GRADE SEPARATION
CANIFF AVE LYNCH ROAD & Mt. ELLIOTT AVE. M.C.R.R. G.T.W.R.R. M.C. SETTLELINE & D.T.R.

PRELIMINARY PLAN

SHEET
4 OF 4 SHEETS

JOB NO.