

Sketch Plan

<table border="1"> <tr><td>G</td><td></td></tr> <tr><td>F</td><td></td></tr> <tr><td>E</td><td></td></tr> <tr><td>D</td><td></td></tr> <tr><td>C</td><td></td></tr> <tr><td>B</td><td></td></tr> <tr><td>A</td><td></td></tr> </table>		G		F		E		D		C		B		A		<table border="1"> <tr><td>DESIGNED BY</td><td></td></tr> <tr><td>DRAWN BY</td><td></td></tr> <tr><td>TRACED BY</td><td></td></tr> <tr><td>CHECKED BY</td><td></td></tr> </table>	DESIGNED BY		DRAWN BY		TRACED BY		CHECKED BY		<table border="1"> <tr><td>APPROVED:</td><td></td></tr> <tr><td>ENGINEER OF</td><td></td></tr> <tr><td>CITY ENGINEER</td><td></td></tr> </table>	APPROVED:		ENGINEER OF		CITY ENGINEER		<p align="center">CITY OF DETROIT DEPARTMENT OF PUBLIC WORKS CITY ENGINEERS OFFICE BUREAU OF DESIGN</p>	<p align="center">GRADE SEPARATION CANIFF AVE., LYNCH ROAD & MT. ELLIOTT AVE. CROSSING MICH. CENTRAL R.R. (N.Y.C.R.R.) & GRAND TRUNK WESTERN R.R.</p>	<table border="1"> <tr><td>SHEET</td><td>—</td><td>OF</td><td>—</td><td>SHEETS</td></tr> <tr><td>JOB No.</td><td colspan="4">GS-RR-2</td></tr> <tr><td>DRWG No.</td><td colspan="4">C-6</td></tr> <tr><td>DATE</td><td colspan="4"></td></tr> </table>	SHEET	—	OF	—	SHEETS	JOB No.	GS-RR-2				DRWG No.	C-6				DATE				
G																																																						
F																																																						
E																																																						
D																																																						
C																																																						
B																																																						
A																																																						
DESIGNED BY																																																						
DRAWN BY																																																						
TRACED BY																																																						
CHECKED BY																																																						
APPROVED:																																																						
ENGINEER OF																																																						
CITY ENGINEER																																																						
SHEET	—	OF	—	SHEETS																																																		
JOB No.	GS-RR-2																																																					
DRWG No.	C-6																																																					
DATE																																																						
<table border="1"> <tr><th>DESCRIPTION</th><th>DEW</th><th>CK'D</th><th>AP'D</th><th>DATE</th></tr> <tr><td> </td><td> </td><td> </td><td> </td><td> </td></tr> <tr><td> </td><td> </td><td> </td><td> </td><td> </td></tr> <tr><td> </td><td> </td><td> </td><td> </td><td> </td></tr> </table>		DESCRIPTION	DEW	CK'D	AP'D	DATE																																																
DESCRIPTION	DEW	CK'D	AP'D	DATE																																																		

8-4d(T)

2.13 P-3-27-44
2.13 P-6-13-44

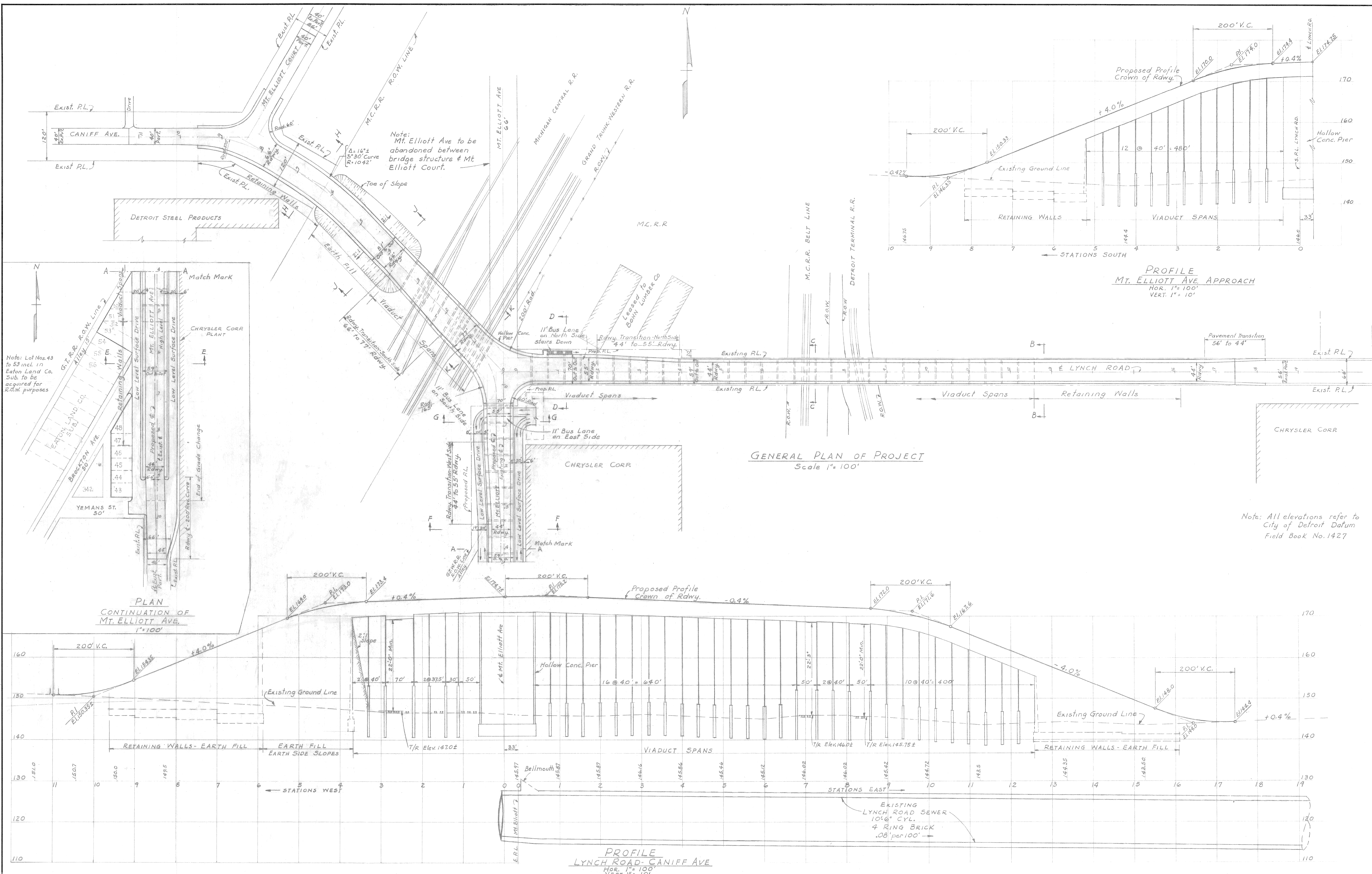

Note: Lot Nos. 43 to 53 incl. in Eaton Land Co. Sub. to be acquired for R.O.W. purposes

Note: Mt. Elliott Ave to be abandoned between bridge structure & Mt. Elliott Court.

Note: All elevations refer to City of Detroit Datum Field Book No. 1427

G					
F					
E					
D					
C					
B					
A					
NOTED BY	DESCRIPTION	DRN	CK'D	AP'VD	DATE
	REVISIONS				

DESIGNED BY	A. Berarducci
DRAWN BY	A. Berarducci
TRACED BY	
CHECKED BY	

APPROVED:	
CITY ENGINEER	

CITY OF DETROIT
DEPARTMENT OF PUBLIC WORKS
CITY ENGINEERS OFFICE

GRADE SEPARATION
CANIFF AVE., LYNCH ROAD & MT. ELLIOTT AVE.
M.C.R.R., G.T.W.R.R., M.C. BELTLINE & D.T.R.R.

PRELIMINARY PLAN
PLAN AND PROFILE
ROADWAY OVERPASS

SCALE: As NOTED

SHEET 2 OF 4 SHEETS
JOB No. GS-RR-2
DRWG No. C-7
DATE 2-22-44

137-2-11-37
23P-5-27-44
23P-6-13-44

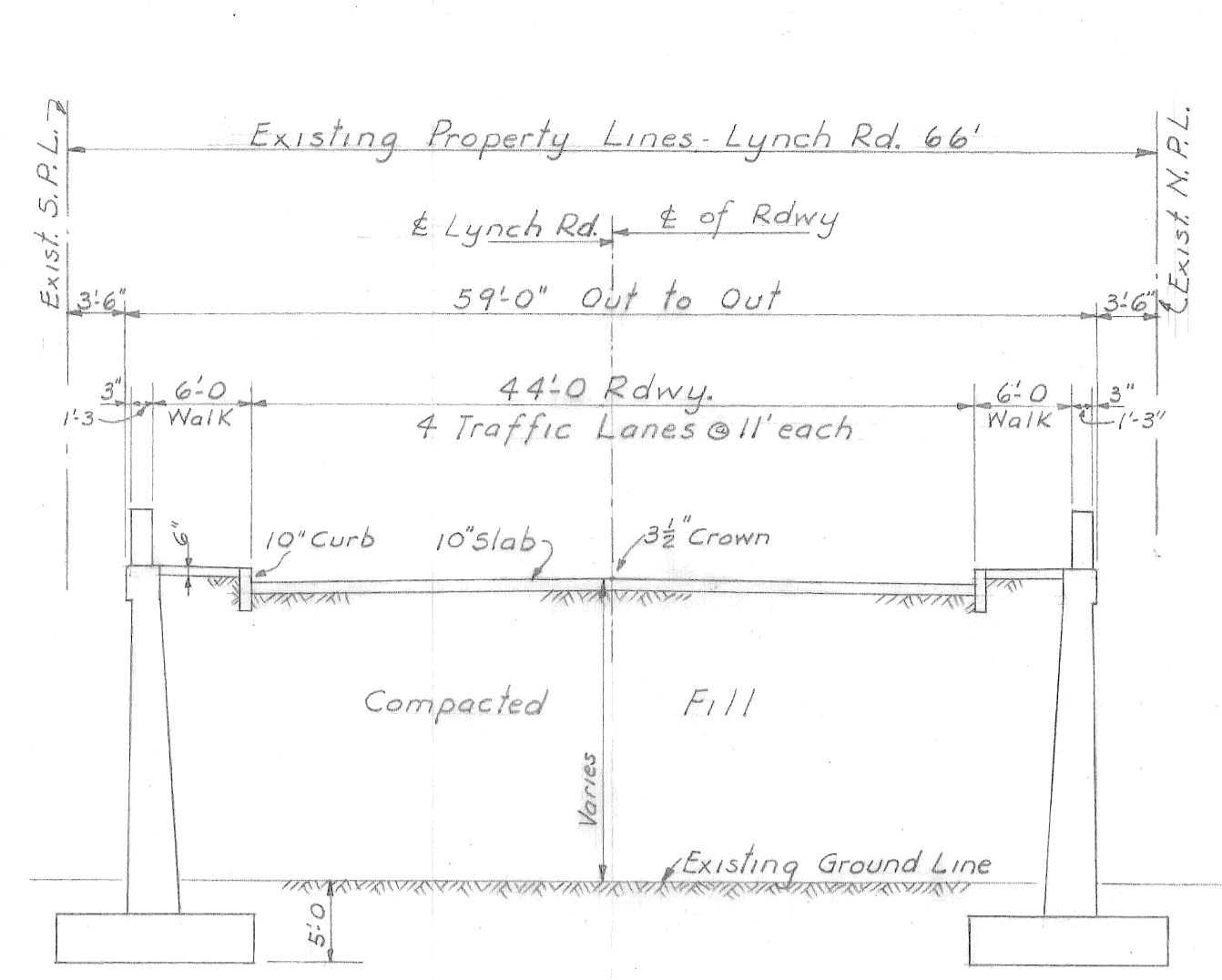

SECTION B-B
RETAINING WALL SECTION
LYNCH ROAD APPROACH
 $\frac{3}{32}'' = 1'-0''$

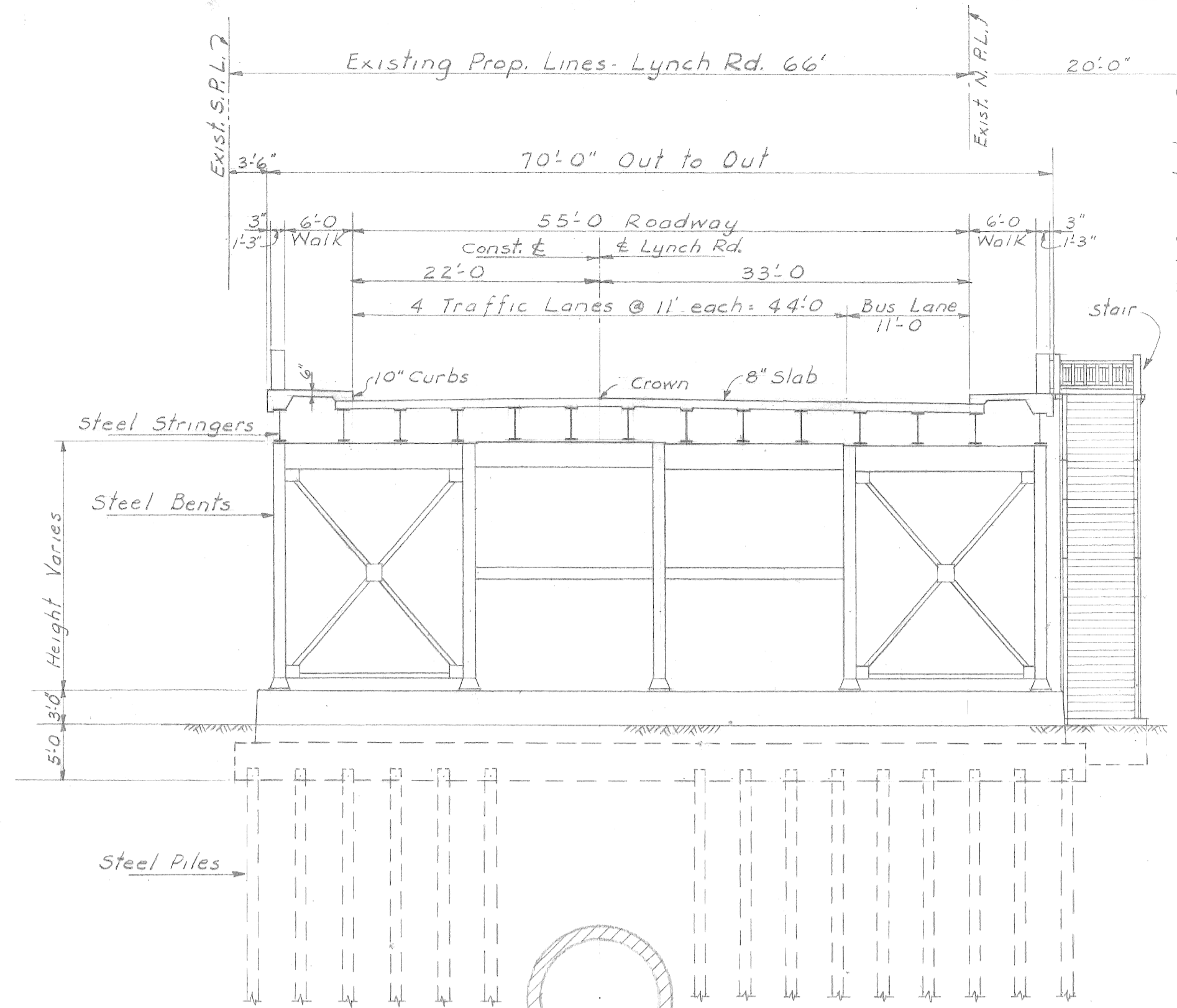
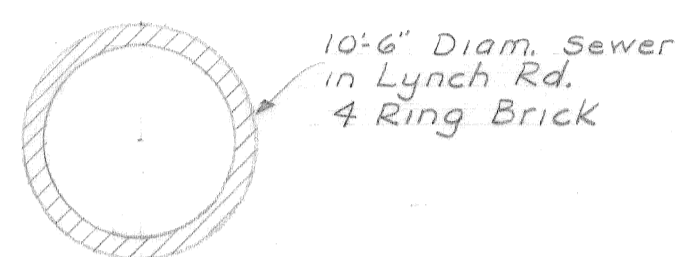

SECTION D-D
LYNCH ROAD APPROACH
VIADUCT SECTION AT BUS LANE
 $\frac{3}{32}'' = 1'-0''$

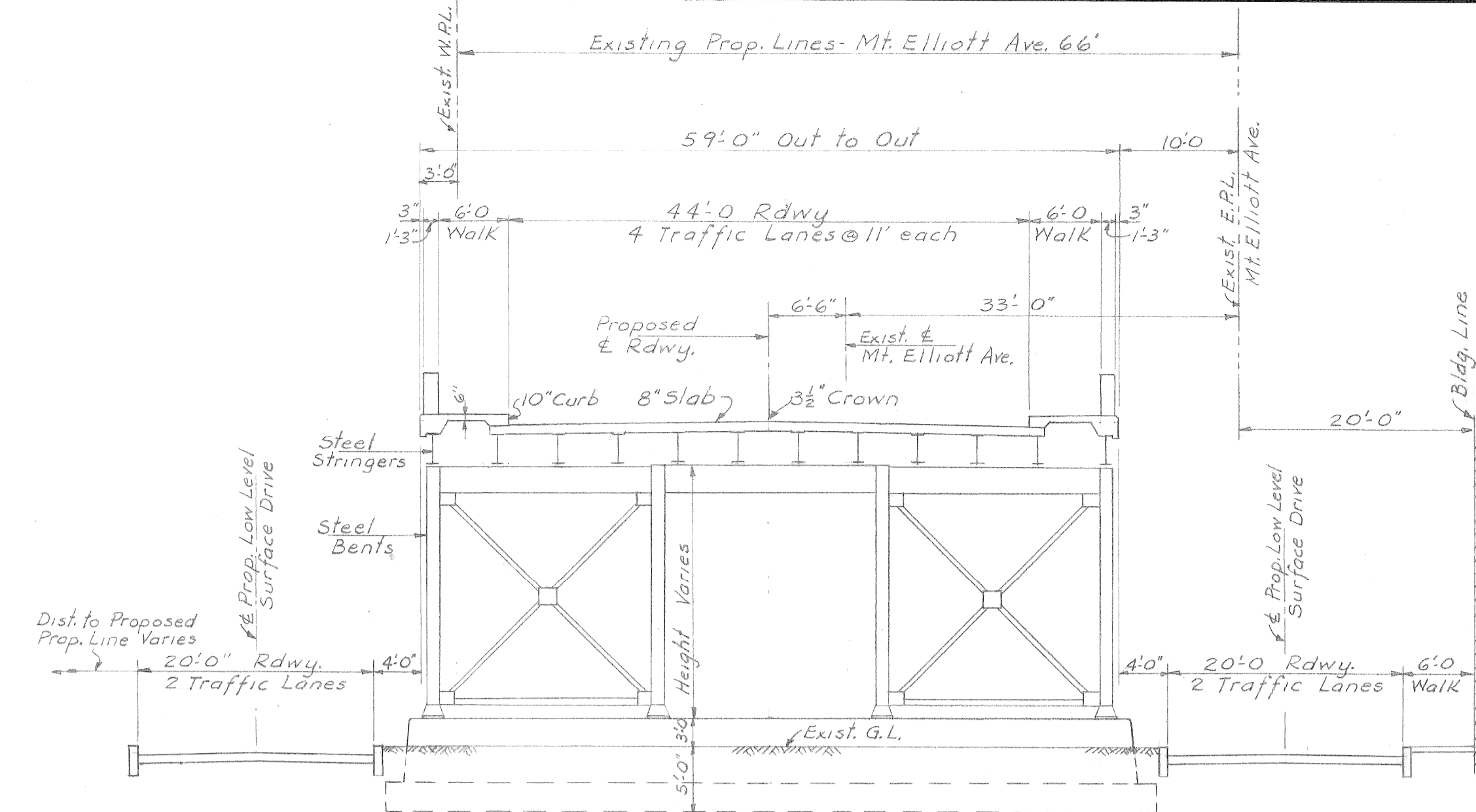
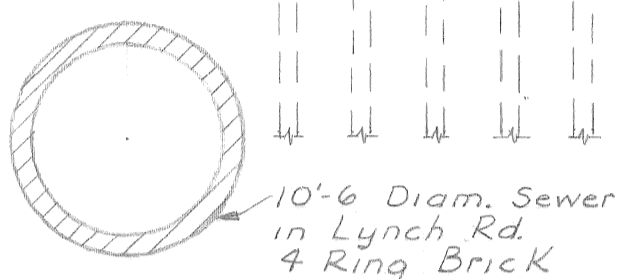

SECTION F-F
MT. ELLIOTT AVE. APPROACH
VIADUCT SECTION
 $\frac{3}{32}'' = 1'-0''$

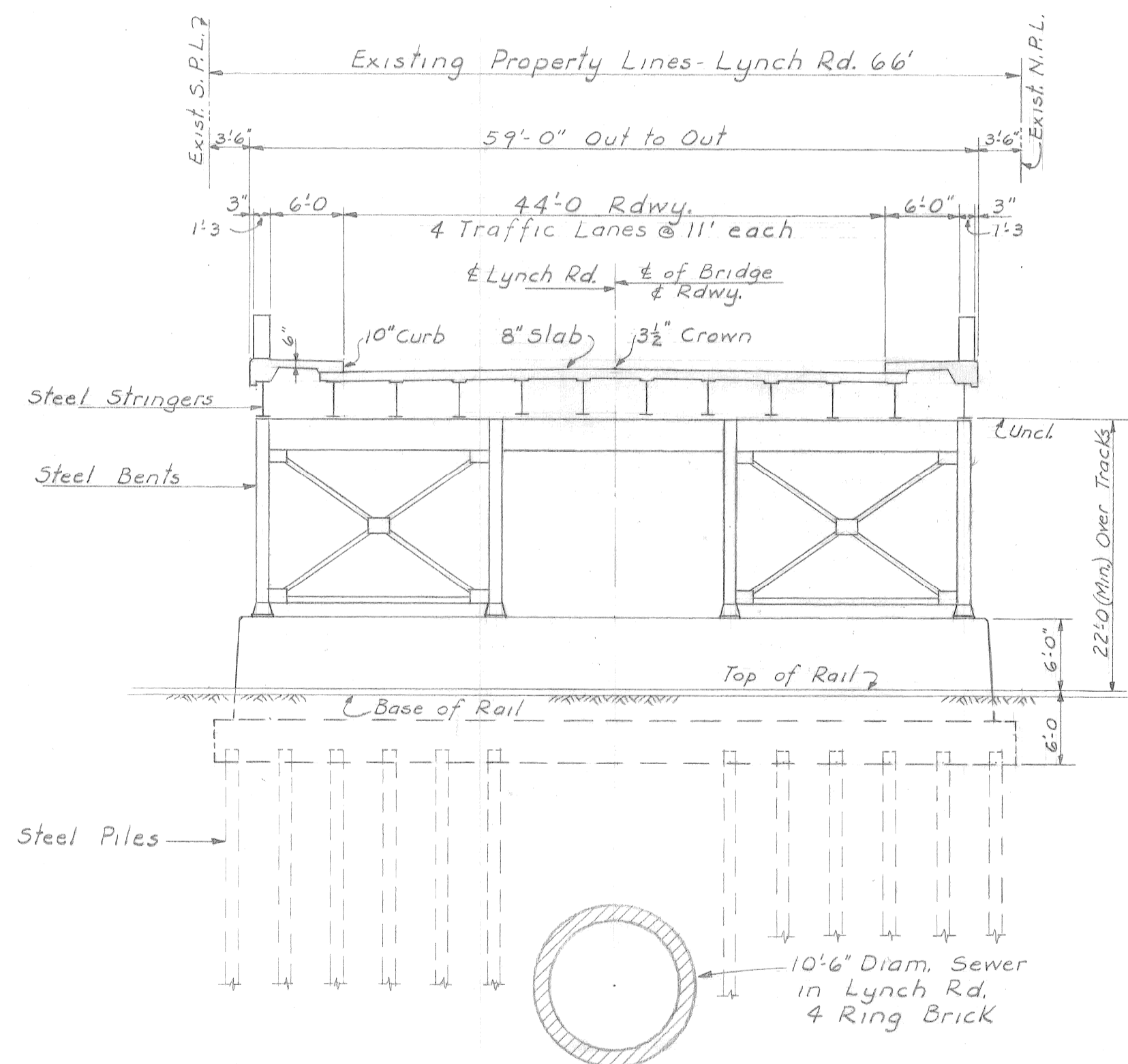

SECTION C-C
VIADUCT SECTION
LYNCH ROAD APPROACH
 $\frac{3}{32}'' = 1'-0''$

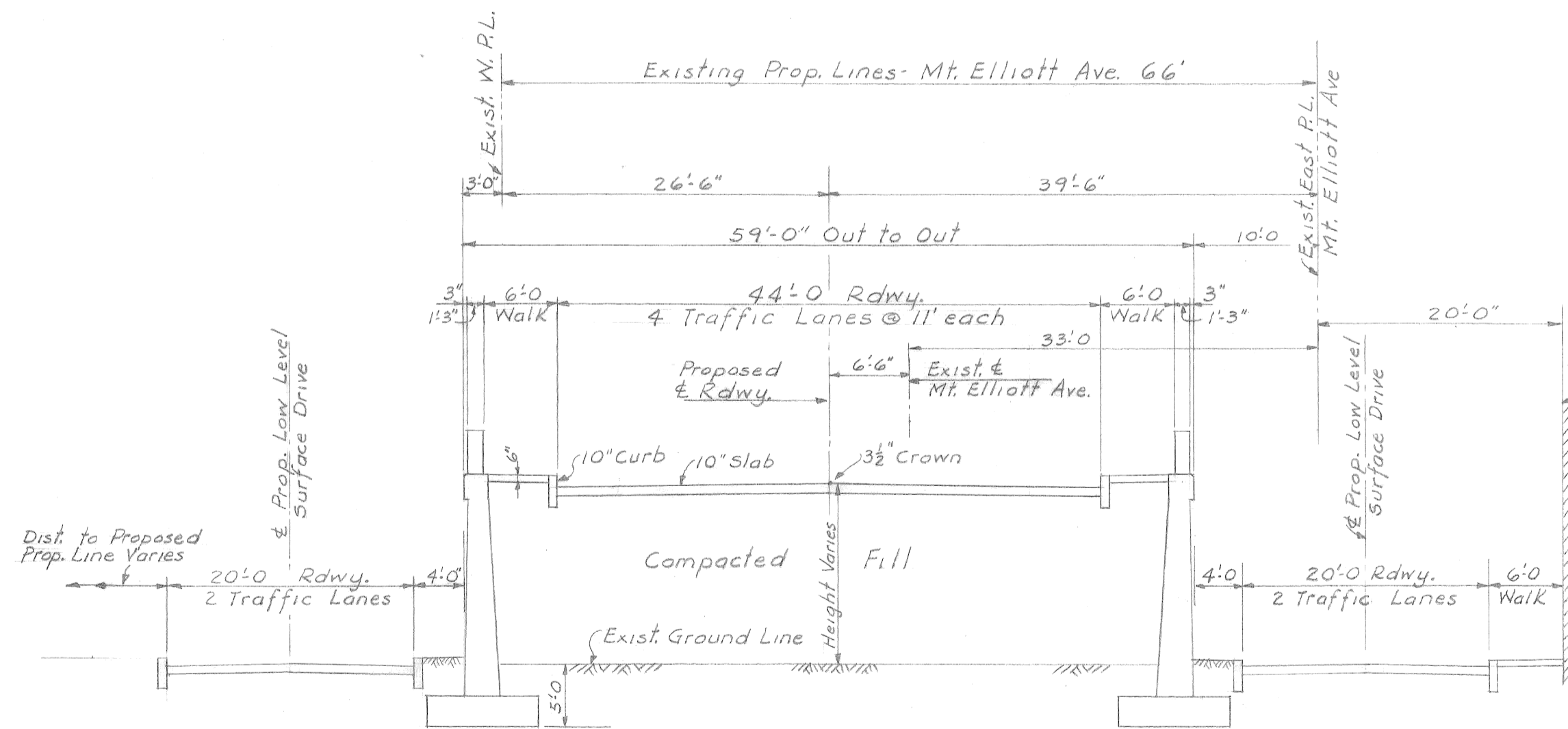
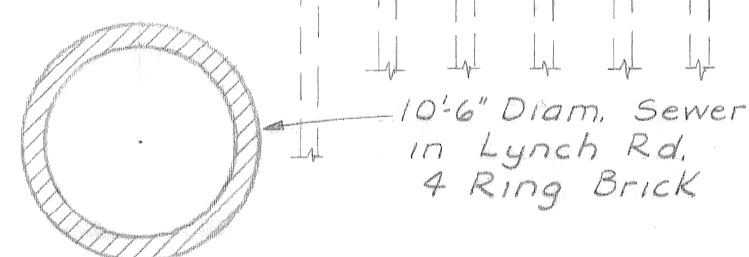

SECTION E-E
MT. ELLIOTT AVE. APPROACH
RETAINING WALL SECTION
 $\frac{3}{32}'' = 1'-0''$

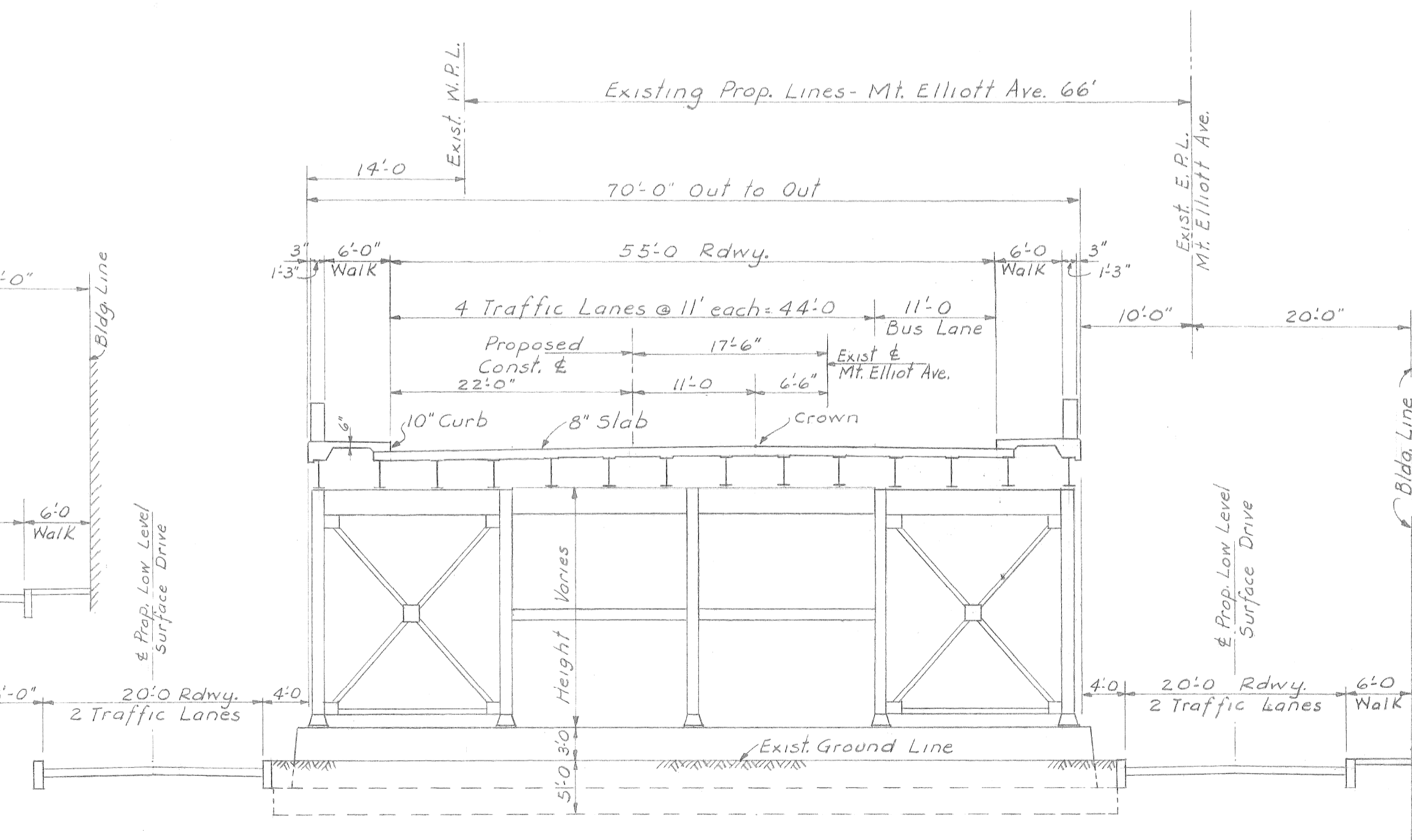

SECTION G-G
MT. ELLIOTT AVE. APPROACH
VIADUCT SECTION AT BUS LANE
 $\frac{3}{32}'' = 1'-0''$

DESIGNED BY	A. Berarducci	APPROVED:	
DRAWN BY	A. Berarducci		
TRACED BY			
CHECKED BY		CITY ENGINEER	
REFERENCE DRAWINGS			
NOTED BY			
DESCRIPTION	DRN	CKD	APVD
REVISIONS			

CITY OF DETROIT
DEPARTMENT OF PUBLIC WORKS
CITY ENGINEERS OFFICE

GRADE SEPARATION
CANIFF AVE., LYNCH ROAD & MT. ELLIOTT AVE.
M.C.R.R., G.T.W.R.R., M.C. BELTLINE & D.T.R.R.

PRELIMINARY PLAN
TYPICAL SECTIONS
ROADWAY OVERPASS

SCALE: AS NOTED

SHEET 3 OF 4 SHEETS
JOB No. GS-RR-2
DRWG No. C-8
DATE 2-22-44

9 B.P. 2-21-44
 2 B.P. 3-27-44
 2 B.P. 6-13-44



SECTION H-H
 CANIFF AVE. APPROACH
 RETAINING WALL SECTION
 $\frac{3}{32}'' = 1'-0''$

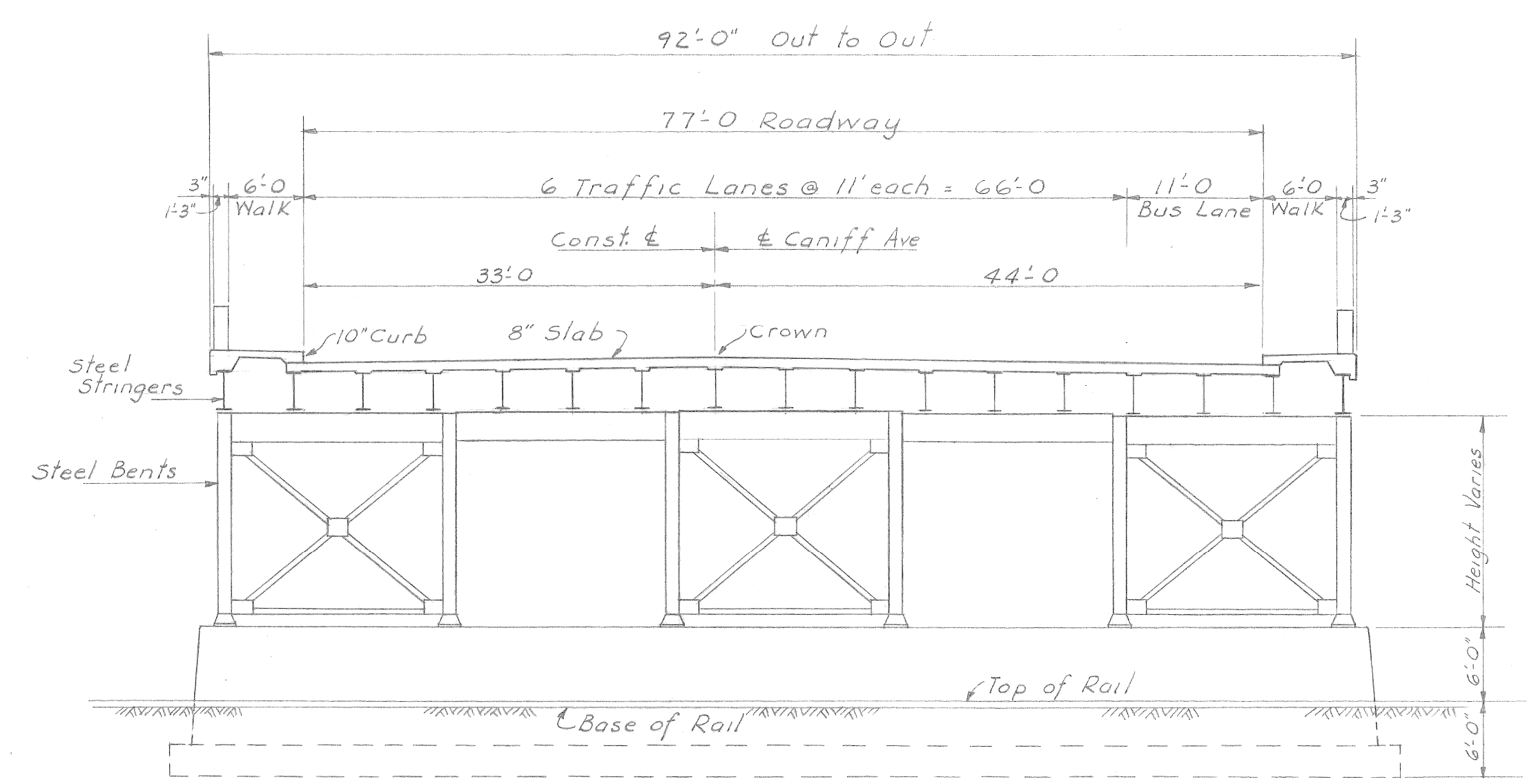

SECTION K-K
 CANIFF AVE. APPROACH
 VIADUCT SECTION AT BUS LANE
 $\frac{3}{32}'' = 1'-0''$

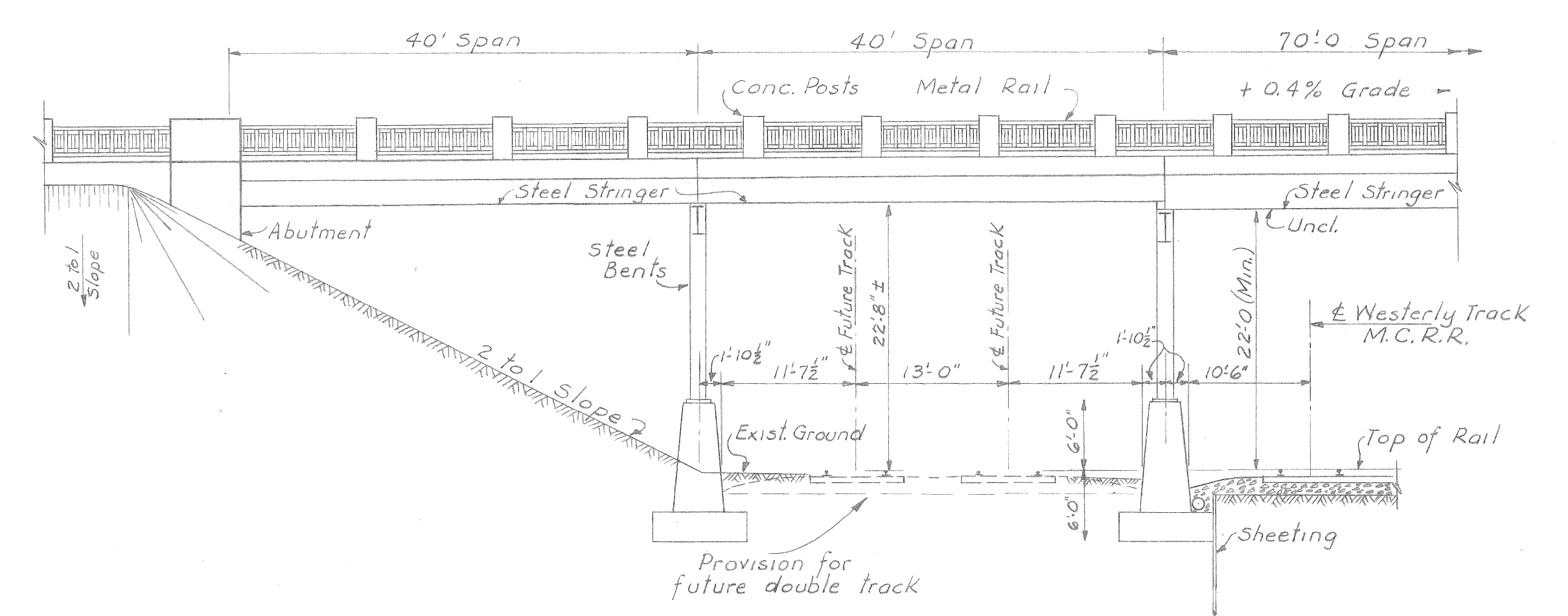

PART ELEVATION
 NEAR STATION 3+00 WEST
 PROVISION FOR FUTURE DOUBLE TRACK
 $\frac{3}{32}'' = 1'-0''$

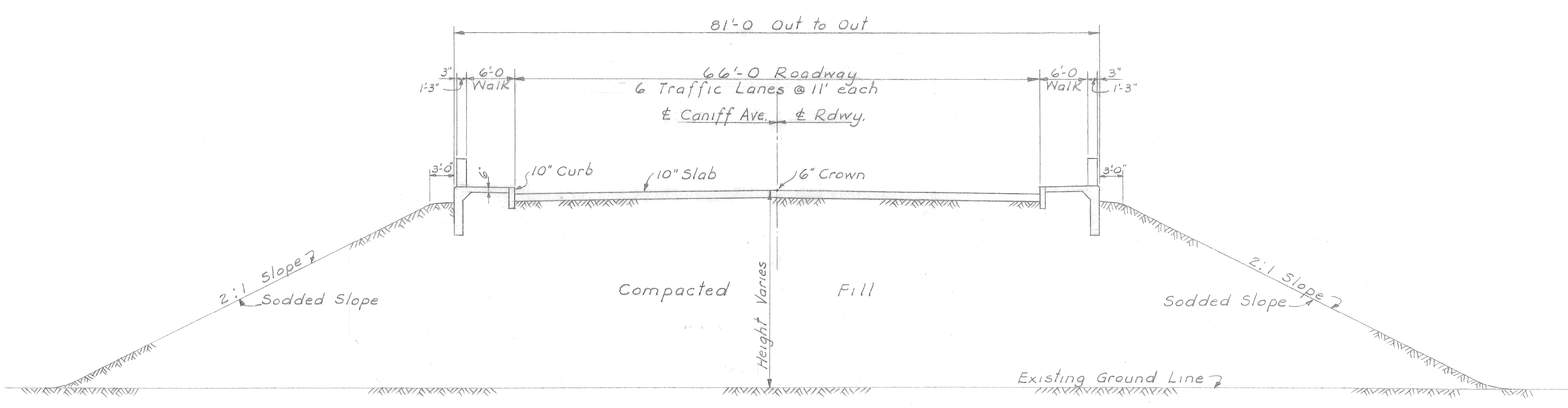

SECTION J-J
 CANIFF AVE. APPROACH
 ROADWAY ON EARTH FILL
 $\frac{3}{32}'' = 1'-0''$

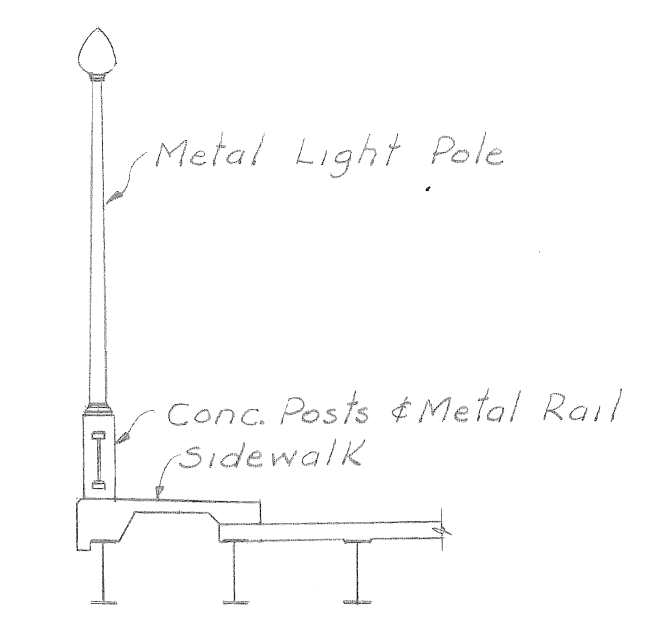

LIGHT POLE DETAIL
 $\frac{1}{8}'' = 1'-0''$

NOTED BY	DESCRIPTION	DRN	CKD	APVD	DATE
REVISIONS					

DESIGNED BY	A. Berarducci	APPROVED:
DRAWN BY	A. Berarducci	
TRACED BY		
CHECKED BY		CITY ENGINEER

CITY OF DETROIT
 DEPARTMENT OF PUBLIC WORKS
 CITY ENGINEERS OFFICE

GRADE SEPARATION
 CANIFF AVE., LYNCH ROAD & MT. ELLIOTT AVE.
 M.C.R.R., G.T.W.R.R., M.C. BELTLINE & D.T.R.R.
 PRELIMINARY PLAN
 TYPICAL CROSS-SECTIONS
 ROADWAY OVERPASS

SCALE - AS NOTED

SHEET 4 OF 4 SHEETS
JOB No. GS-RR-2
DRWG No. C-9
DATE 2-22-44