

PETITION NO. 4118 Addendum  
MOTOR CITY CASINO  
2901 GRAND RIVER  
c/o Michael J. Stratte  
c/o Mike Lawicki, TYJT  
PHONE 313-963-0612

On April 07, 2006 City Council approved Petition No. 4118 of Detroit Entertainment, L.L.C. ("MotorCity Casino --Expansion Site"). That approved petition requested one street and four alleys to vacation, a public access easement to vacation, two overhead walkways and a vehicular bridge crossing city rights-of-way, and easements for building façade projections in the area bounded by Trumbull, Elm, Grand River, Lodge Expressway and Spruce.

City Engineering Division --DPW received design drawings showing underground (subsurface) footings for the planned MotorCity Casino --New Continental Building. The footings will extend into the eastern margin of Brooklyn Avenue, the western margin of John C. Lodge Expressway Service Drive, and two public alleys (vacated, but reserving DWSD sewer provisions). Therefore, said Petition No. 4118, requires an *addendum* to include underground "easement (s) for permissible *BUILDING STREET PROJECTION* purposes".

Vertically, the footings are positioned between City of Detroit elevation **124.7** and City of Detroit elevation **128.7**. The horizontal position is shown in the table.

Requesting Easement(s) for Subsurface (UG) footing(s)

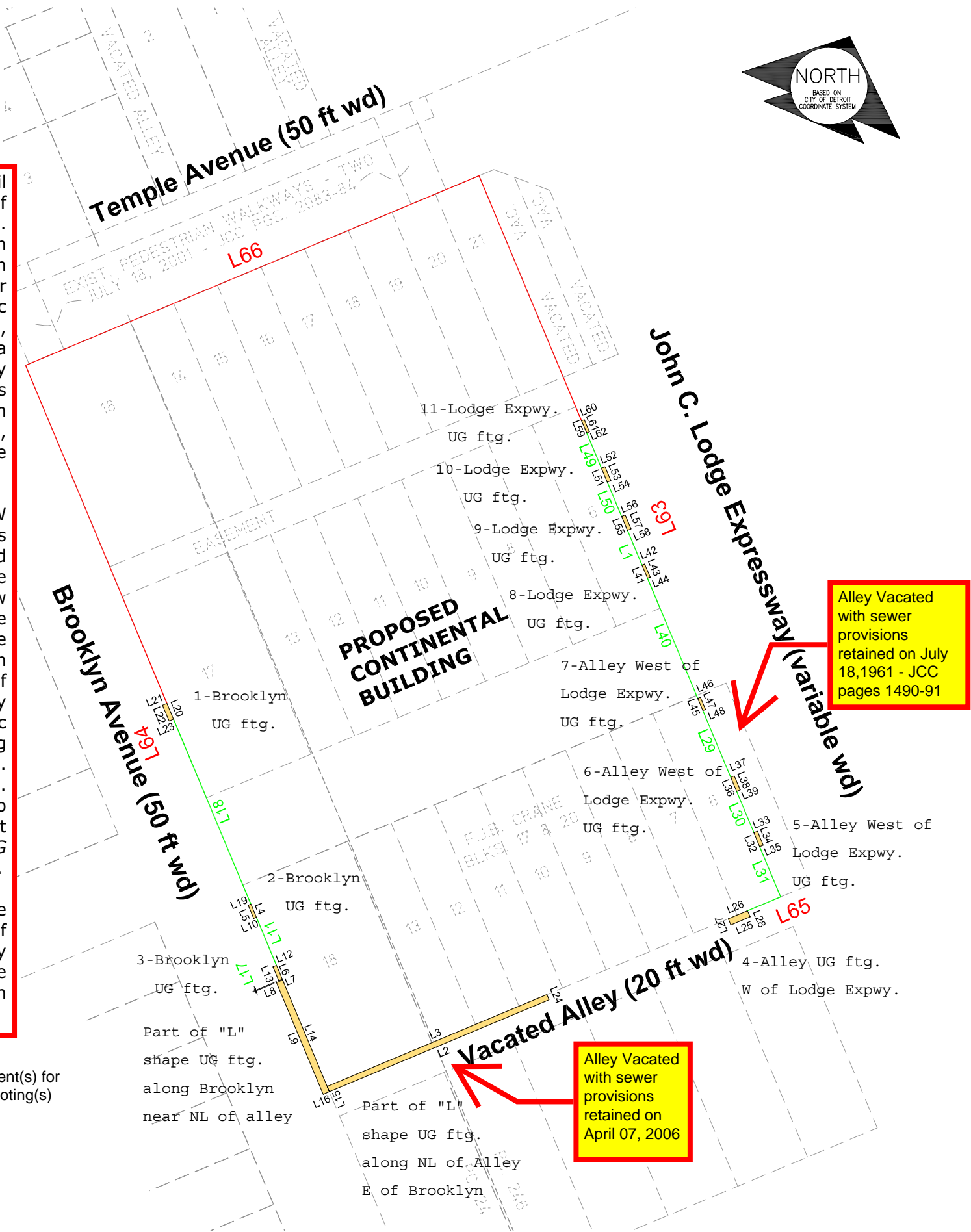

LINE TABLE								
LINE	LENGTH	BEARING	LINE	LENGTH	BEARING	LINE	LENGTH	BEARING
L1	19.92	N22°41'30"W	L23	2.50	S67°18'30"W	L45	7.00	S22°41'30"E
L2	126.00	S67°18'30"W	L24	3.00	S22°41'30"E	L46	1.50	S67°18'30"W
L3	126.00	N67°18'30"E	L25	11.00	S67°18'30"W	L47	7.00	N22°41'30"W
L4	7.50	S22°41'30"E	L26	11.00	N67°18'30"E	L48	1.50	N67°18'30"E
L5	7.50	N22°41'30"W	L27	3.50	N22°41'30"W	L49	20.17	N22°41'30"W
L6	8.00	S22°41'30"E	L28	3.50	S22°41'30"E	L50	19.67	N22°41'30"W
L7	2.00	S67°18'30"W	L29	38.33	N22°41'30"W	L51	8.00	S22°41'30"E
L8	3.50	N67°18'30"E	L30	23.67	N22°41'30"W	L52	2.00	S67°18'30"W
L9	64.00	N22°41'30"W	L31	28.80	N22°41'30"W	L53	8.00	N22°41'30"W
L10	1.50	S67°18'30"W	L32	8.00	S22°14'30"E	L54	2.00	N67°18'30"E
L11	27.58	N22°41'30"W	L33	2.00	S67°18'30"W	L55	8.00	S22°41'30"E
L12	2.00	N67°18'30"E	L34	8.00	N22°14'30"W	L56	2.00	S67°18'30"W
L13	8.00	N22°41'30"W	L35	2.00	N67°18'30"E	L57	8.00	N22°41'30"W
L14	64.00	S22°41'30"E	L36	8.00	S22°41'30"E	L58	2.00	N67°18'30"E
L15	3.00	S22°41'30"E	L37	2.00	S67°18'30"W	L59	7.00	S22°41'30"E
L16	3.50	S67°18'30"W	L38	8.00	N22°41'30"W	L60	1.50	S67°18'30"W
L17	0.46	N22°41'30"W	L39	2.00	N67°18'30"E	L61	7.00	N22°41'30"W
L18	106.08	N22°41'30"W	L40	68.92	N22°41'30"W	L62	1.50	N67°18'30"E
L19	1.50	N67°18'30"E	L41	7.50	S22°41'30"E	L63	413.50	S22°41'30"E
L20	9.00	S22°41'30"E	L42	1.50	S67°18'30"W	L64	413.50	S22°41'30"E
L21	2.50	N67°18'30"E	L43	7.50	N22°41'30"W	L65	19.02	S67°18'30"W
L22	9.00	N22°41'30"W	L44	1.50	N67°18'30"E	L66	260.00	N67°18'30"E

(FOR OFFICE USE ONLY)

CARTO MAP 29 C & D  
SCALE: NOT TO SCALE

B					
A					
DESCRIPTION		DRWN	CHKD	APPD	DATE
REVISIONS					
DRAWN BY	NSE	APPROVED	AM		
TRACED BY		APPROVED			
CHECKED		APPROVED			
CITY ENGINEER					

MotorCity Casino --New Continental Building-- Addendum  
Requesting Easements for UG (subsurface) footings extending into eastern margin of Brooklyn Avenue, western margin of John C. Lodge Expressway Service Drive, and two public alleys (vacated, but reserving DWSD sewer provisions)

CITY OF DETROIT CITY ENGINEERING DEPARTMENT SURVEY BUREAU	
JOB NO.	01-01
DRWG. NO.	X-4118 addendum
DATE:	10-12-2006

**Table MotorCity—New Continental Building**  
**Section “E”—underground (UG) footings**

Vertical elevations—between City of Detroit datum **124.7** bottom and **128.7** top

*Notes: Legal descriptions and elevations are taken from sketch of description drawings prepared for  
Tucker, Young, Jackson, Tull, Inc. (TYJT); 565 E. Larned, Suite 300, Detroit, MI 48226-4316;*

LOCATION	DESCRIPTION
<p>1 – Brooklyn UG footing  within the eastern sidewalk margin of Brooklyn Street, South of Temple Avenue</p>	<p>Commencing at the intersection of the Easterly line of Brooklyn Street (50 feet wide) and the Southerly line of Temple Avenue (50 feet wide);  Thence S22°41'30"E along the Easterly line of said Brooklyn Street, 193.88 feet, to the POB;  Thence S22°41'30"E, 9.00 feet;  Thence S67°18'30"W, 2.50 feet;  Thence N22°41'30"W, 9.00 feet;  Thence N67°18'30"E, 2.50 feet, to the POB;  [The horizontal plane contains about 22.50 square feet or 0.0005 acre more or less.]</p>
<p>2 – Brooklyn UG footing  within the eastern sidewalk margin of Brooklyn Street, South of Temple Avenue</p>	<p>Commencing at the intersection of the Easterly line of Brooklyn Street (50 feet wide) and the Southerly line of Temple Avenue (50 feet wide);  Thence S22°41'30"E along the Easterly line of said Brooklyn Street, 308.96 feet, to the POB;  Thence S22°41'30"E, 7.50 feet;  Thence S67°18'30"W, 1.50 feet;  Thence N22°41'30"W, 7.50 feet;  Thence N67°18'30"E, 1.50 feet, to the POB;  [The horizontal plane contains about 11.25 square feet or 0.0003 acre more or less.]</p>
<p>3 – Brooklyn UG footing  within the eastern sidewalk margin of Brooklyn Street, South of Temple Avenue</p>	<p>Commencing at the intersection of the Easterly line of Brooklyn Street (50 feet wide) and the Southerly line of Temple Avenue (50 feet wide);  Thence S22°41'30"E along the Easterly line of said Brooklyn Street, 344.04 feet, to the POB;  Thence S22°41'30"E, 8.00 feet;  Thence S67°18'30"W, 2.00 feet;  Thence N22°41'30"W, 8.00 feet;  Thence N67°18'30"E, 2.00 feet, to the POB;  [The horizontal plane contains about 16.0 square feet or 0.0004 acre more or less.]</p>
<p>Part of “L”- shape UG footing along Brooklyn,  near NL of Alley  within the eastern sidewalk margin of Brooklyn Street, South of Temple Avenue</p>	<p>Commencing at the intersection of the Easterly line of Brooklyn Street (50 feet wide) and the Southerly line of Temple Avenue (50 feet wide);  Thence S22°41'30"E along the Easterly line of said Brooklyn Street, 352.50 feet, to the POB;  Thence S22°41'30"E, 64.00 feet;  Thence S67°18'30"W, 3.50 feet;  Thence N22°41'30"W, 64.00 feet;  Thence N67°18'30"E, 3.50 feet to the POB;  [The horizontal plane contains about 224.0 square feet or 0.0051 acre more or less.]</p>

**Table MotorCity—New Continental Building**  
**Section “E”—underground (UG) footings**

Vertical elevations—between City of Detroit datum **124.7** bottom and **128.7** top

*Notes: Legal descriptions and elevations are taken from sketch of description drawings prepared for Tucker, Young, Jackson, Tull, Inc. (TYJT); 565 E. Larned, Suite 300, Detroit, MI 48226-4316;*

LOCATION	DESCRIPTION
<p>Part of “L”- shape UG footing along NL of Alley, E of Brooklyn within the northern 3.00 feet of the vacated east- west public alley (block bounded by Brooklyn Avenue, Lodge Expressway, Spruce and Perry Streets; said alley previously vacated with sewer provisions on April 07, 2006)</p>	<p>Commencing at the intersection of the Easterly line of Brooklyn Street (50 feet wide) and the Southerly line of Temple Avenue (50 feet wide); Thence S22°41’30”E along the Easterly line of said Brooklyn Street, 413.50 feet, to the POB; Thence N67°18’30”E along the Northerly line of the vacated east-west public alley (17 feet wide), 126.00 feet; Thence S22°41’30”E, 3.00 feet; Thence S67°18’30”W, 126.00 feet; Thence N22°41’30”W, 3.00 feet to the POB; [The horizontal plane contains about 378.0 square feet or 0.0087 acre more or less.]</p>
<p>4 – Alley UG footing, W of Lodge Expressway within the northern 3.50 feet of the vacated east- west public alley (block bounded by Brooklyn Avenue, Lodge Expressway, Spruce and Perry Streets; said alley previously vacated with sewer provisions on April 07, 2006)</p>	<p>Commencing at the Southeasterly corner of Lot 6, Block 17, of “Plat of F.J.B. Crane’s Subdivision of Part of Blocks 17 and 20, LaBrosse Farm,” City of Detroit, Wayne County, Michigan as recorded in Liber 58, Page 252 of Deeds, Wayne County Records; Thence S67°18’30”W along the Northerly line of the vacated east-west public alley (17 feet wide), 19.02 feet, to the POB; Thence S22°41’30”E, 3.50 feet; Thence S67°18’30”W, 11.00 feet; Thence N22°41’30”W, 3.50 feet; Thence N67°18’30”E, 11.00 feet to the POB; [The horizontal plane contains about 38.5 square feet or 0.0009 acre more or less.]</p>

**Table MotorCity—New Continental Building**  
**Section “E”—underground (UG) footings**

Vertical elevations—between City of Detroit datum **124.7** bottom and **128.7** top

*Notes: Legal descriptions and elevations are taken from sketch of description drawings prepared for Tucker, Young, Jackson, Tull, Inc. (TYJT); 565 E. Larned, Suite 300, Detroit, MI 48226-4316;*

LOCATION	DESCRIPTION
<p>5 – Alley West of Lodge Expressway UG footing within the western 2.00 feet of the vacated north-south public alley (block bounded by Brooklyn Avenue, Lodge Expressway, Spruce and Perry Streets; said alley previously vacated with sewer provisions on July 18, 1961—J.C.C. pages 1490-91)</p>	<p>Commencing at the Southeasterly corner of Lot 6, Block 17, of “Plat of F.J.B. Crane’s Subdivision of Part of Blocks 17 and 20, LaBrosse Farm,” City of Detroit, Wayne County, Michigan as recorded in Liber 58, Page 252 of Deeds, Wayne County Records;  Thence N22°41’30”W along the Easterly line of said Lot 6, 28.80 feet, to the POB;  Thence N22°41’30”W, 8.00 feet;  Thence N67°18’30”E, 2.00 feet;  Thence S22°41’30”E, 8.00 feet;  Thence S67°18’30”W 2.00 feet to the POB;  [The horizontal plane contains about 16.0 square feet or 0.0004 acre more or less.]</p>
<p>6 – Alley West of Lodge Expressway UG footing within the western 2.00 feet of the vacated north-south public alley (block bounded by Brooklyn Avenue, Lodge Expressway, Spruce and Perry Streets; said alley previously vacated with sewer provisions on July 18, 1961—J.C.C. pages 1490-91)</p>	<p>Commencing at the Southeasterly corner of Lot 6, Block 17, of “Plat of F.J.B. Crane’s Subdivision of Part of Blocks 17 and 20, LaBrosse Farm,” City of Detroit, Wayne County, Michigan as recorded in Liber 58, Page 252 of Deeds, Wayne County Records;  Thence N22°41’30”W along the Easterly line of said Lot 6, 60.47 feet, to the POB;  Thence N22°41’30”W, 8.00 feet;  Thence N67°18’30”E, 2.00 feet;  Thence S22°41’30”E, 8.00 feet;  Thence S67°18’30”W, 2.00 feet to the POB;  [The horizontal plane contains about 16.0 square feet or 0.0004 acre more or less.]</p>

**Table MotorCity—New Continental Building**  
**Section “E”—underground (UG) footings**

Vertical elevations—between City of Detroit datum **124.7** bottom and **128.7** top

*Notes: Legal descriptions and elevations are taken from sketch of description drawings prepared for Tucker, Young, Jackson, Tull, Inc. (TYJT); 565 E. Larned, Suite 300, Detroit, MI 48226-4316;*

LOCATION	DESCRIPTION
<p>7 – Alley West of Lodge Expressway UG footing within the western 1.50 feet of the vacated north-south public alley (block bounded by Brooklyn Avenue, Lodge Expressway, Spruce and Perry Streets; said alley previously vacated with sewer provisions on July 18, 1961—J.C.C. pages 1490-91)</p>	<p>Commencing at the Southeasterly corner of Lot 6, Block 17, of “Plat of F.J.B. Crane’s Subdivision of Part of Blocks 17 and 20, LaBrosse Farm,” City of Detroit, Wayne County, Michigan as recorded in Liber 58, Page 252 of Deeds, Wayne County Records;  Thence N22°41’30”W along the Easterly line of said Lot 6, 106.80 feet, to the POB;  Thence N22°41’30”W, 7.00 feet;  Thence N67°18’30”E, 1.50 feet;  Thence S22°41’30”E, 7.00 feet;  Thence S67°18’30”W, 1.50 feet to the POB;  [The horizontal plane contains about 10.5 square feet or 0.0002 acre more or less.]</p>
<p>8 – Lodge Expressway UG footing within the western sidewalk margin (service drive space) of the limited access right-of-way of the John C. Lodge Expressway, Northerly of Perry Street (M-DOT ROW maps, Wayne County, for John C. Lodge Expressway, File No. 82-R-1, Route US-10, Project 82-127, Control Section 82111, Sheets 170 and 171-1);</p>	<p>Commencing at the Southeasterly corner of Lot 6, Block 17, of “Plat of F.J.B. Crane’s Subdivision of Part of Blocks 17 and 20, LaBrosse Farm,” City of Detroit, Wayne County, Michigan as recorded in Liber 58, Page 252 of Deeds, Wayne County Records;  Thence N22°41’30”W along the Easterly line extended Northerly of said Lot 6, being the Westerly right-of-way line of the John C. Lodge Expressway, 182.72 feet, to the POB;  Thence N22°41’30”W, 7.50 feet;  Thence N67°18’30”E, 1.50 feet;  Thence S22°41’30”E, 7.50 feet;  Thence S67°18’30”W, 1.50 feet to the POB;  [The horizontal plane contains about 11.25 square feet or 0.0005 acre more or less.]  [NOTES: The limited access right-of-way, John C. Lodge Expressway, is under the jurisdiction of the Michigan Department of Transportation (M-DOT). Any grant of easement into the “expressway right-of-way” must be approved by M-DOT. However, if the City of Detroit had jurisdiction, this resolution would <i>recommend</i> granting an easement for underground building street projection purposes.]</p>

**Table MotorCity—New Continental Building**  
**Section “E”—underground (UG) footings**

Vertical elevations—between City of Detroit datum **124.7** bottom and **128.7** top

*Notes: Legal descriptions and elevations are taken from sketch of description drawings prepared for Tucker, Young, Jackson, Tull, Inc. (TYJT); 565 E. Larned, Suite 300, Detroit, MI 48226-4316;*

LOCATION	DESCRIPTION
<p style="text-align: center;">9 – Lodge Expressway UG footing</p> <p>within the western sidewalk margin (service drive space) of the limited access right-of-way of the John C. Lodge Expressway, Northerly of Perry Street (M-DOT ROW maps, Wayne County, for John C. Lodge Expressway, File No. 82-R-1, Route US-10, Project 82-127, Control Section 82111, Sheets 170 and 171-1);</p>	<p>Commencing at the Southeasterly corner of Lot 6, Block 17, of “Plat of F.J.B. Crane’s Subdivision of Part of Blocks 17 and 20, LaBrosse Farm,” City of Detroit, Wayne County, Michigan as recorded in Liber 58, Page 252 of Deeds, Wayne County Records;  Thence N22°41’30”W along the Easterly line extended Northerly of said Lot 6, being the Westerly right-of-way line of the John C. Lodge Expressway, 210.14 feet, to the POB;  Thence N22°41’30”W, 8.00 feet;  Thence N67°18’30”E, 2.00 feet;  Thence S22°41’30”E, 8.00 feet;  Thence S67°18’30”W, 2.00 feet to the POB;  [The horizontal plane contains about 16.0 square feet or 0.0004 acre more or less.]</p> <p>[NOTES: The limited access right-of-way, John C. Lodge Expressway, is under the jurisdiction of the Michigan Department of Transportation (M-DOT). Any grant of easement into the “expressway right-of-way” must be approved by M-DOT. However, if the City of Detroit had jurisdiction, this resolution would <i>recommend</i> granting an easement for underground building street projection purposes.]</p>
<p style="text-align: center;">10 – Lodge Expressway UG footing</p> <p>within the western sidewalk margin (service drive space) of the limited access right-of-way of the John C. Lodge Expressway, Northerly of Perry Street (M-DOT ROW maps, Wayne County, for John C. Lodge Expressway, File No. 82-R-1, Route US-10, Project 82-127, Control Section 82111, Sheets 170 and 171-1);</p>	<p>Commencing at the Southeasterly corner of Lot 6, Block 17, of “Plat of F.J.B. Crane’s Subdivision of Part of Blocks 17 and 20, LaBrosse Farm,” City of Detroit, Wayne County, Michigan as recorded in Liber 58, Page 252 of Deeds, Wayne County Records;  Thence N22°41’30”W along the Easterly line extended Northerly of said Lot 6, being the Westerly right-of-way line of the John C. Lodge Expressway, 237.81 feet, to the POB;  Thence N22°41’30”W, 8.00 feet;  Thence N67°18’30”E, 2.00 feet;  Thence S22°41’30”E, 8.00 feet;  Thence S67°18’30”W, 2.00 feet to the POB;  [The horizontal plane contains about 16.0 square feet or 0.0004 acre more or less.]</p> <p>[NOTES: The limited access right-of-way, John C. Lodge Expressway, is under the jurisdiction of the Michigan Department of Transportation (M-DOT). Any grant of easement into the “expressway right-of-way” must be approved by M-DOT. However, if the City of Detroit had jurisdiction, this resolution would <i>recommend</i> granting an easement for underground building street projection purposes.]</p>

**Table MotorCity—New Continental Building**  
**Section “E”—underground (UG) footings**

Vertical elevations—between City of Detroit datum **124.7** bottom and **128.7** top

*Notes: Legal descriptions and elevations are taken from sketch of description drawings prepared for Tucker, Young, Jackson, Tull, Inc. (TYJT); 565 E. Larned, Suite 300, Detroit, MI 48226-4316;*

LOCATION	DESCRIPTION
<p style="text-align: center;">11 – Lodge Expressway UG footing</p> <p>within the western sidewalk margin (service drive space) of the limited access right-of-way of the John C. Lodge Expressway, Northerly of Perry Street (M-DOT ROW maps, Wayne County, for John C. Lodge Expressway, File No. 82-R-1, Route US-10, Project 82-127, Control Section 82111, Sheets 170 and 171-1);</p>	<p>Commencing at the Southeasterly corner of Lot 6, Block 17, of “Plat of F.J.B. Crane’s Subdivision of Part of Blocks 17 and 20, LaBrosse Farm,” City of Detroit, Wayne County, Michigan as recorded in Liber 58, Page 252 of Deeds, Wayne County Records;</p> <p>Thence N22°41’30”W along the Easterly line extended Northerly of said Lot 6, being the Westerly right-of-way line of the John C. Lodge Expressway, 265.98 feet, to the POB;</p> <p>Thence N22°41’30”W, 7.00 feet;</p> <p>Thence N67°18’30”E, 1.50 feet;</p> <p>Thence S22°41’30”E, 7.00 feet;</p> <p>Thence S67°18’30”W, 1.50 feet to the POB;</p> <p>[The horizontal plane contains about 10.5 square feet or 0.0002 acre more or less.]</p> <p>[NOTES: The limited access right-of-way, John C. Lodge Expressway, is under the jurisdiction of the Michigan Department of Transportation (M-DOT). Any grant of easement into the “expressway right-of-way” must be approved by M-DOT. However, if the City of Detroit had jurisdiction, this resolution would <i>recommend</i> granting an easement for underground building street projection purposes.]</p>

On April 07, 2006 City Council approved Petition No. 4118 of Detroit Entertainment, L.L.C. (“MotorCity Casino --Expansion Site”). That approved petition requested one street and four alleys to vacation, a public access easement to vacation, two overhead walkways and a vehicular bridge crossing city rights-of-way, and easements for building façade projections in the area bounded by Trumbull, Elm, Grand River, Lodge Expressway and Spruce.

City Engineering Division --DPW received design drawings showing underground (subsurface) footings for the planned MotorCity Casino --New Continental Building. The footings will extend into the eastern margin of Brooklyn Avenue, the western margin of John C. Lodge Expressway Service Drive, and two public alleys (vacated, but reserving DWSD sewer provisions). Therefore, said Petition No. 4118, requires an *addendum* to include underground “easement(s) for permissible *BUILDING STREET PROJECTION* purposes”.

Vertically, the footings are positioned between City of Detroit elevation **124.7** and City of Detroit elevation **128.7**. The horizontal position is shown in the table above.