

HARBOR ISLAND CANAL

SCRIPPS' AVE. 60' WD.

HARBOR ISLAND AVE. 60' WD.

ASHLAND AVE. 80' WD.

BRUSH FORD PARK

LAKWOOD AVE. 60' WD.

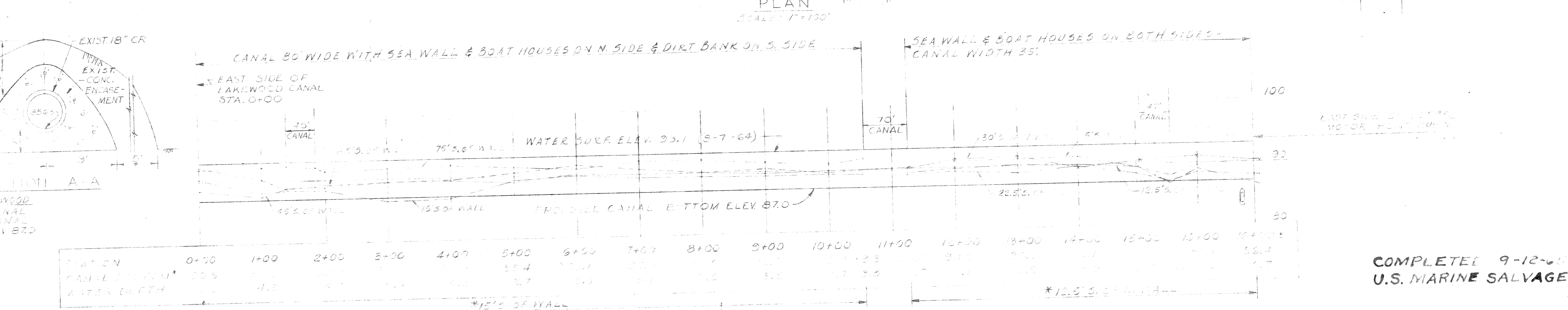
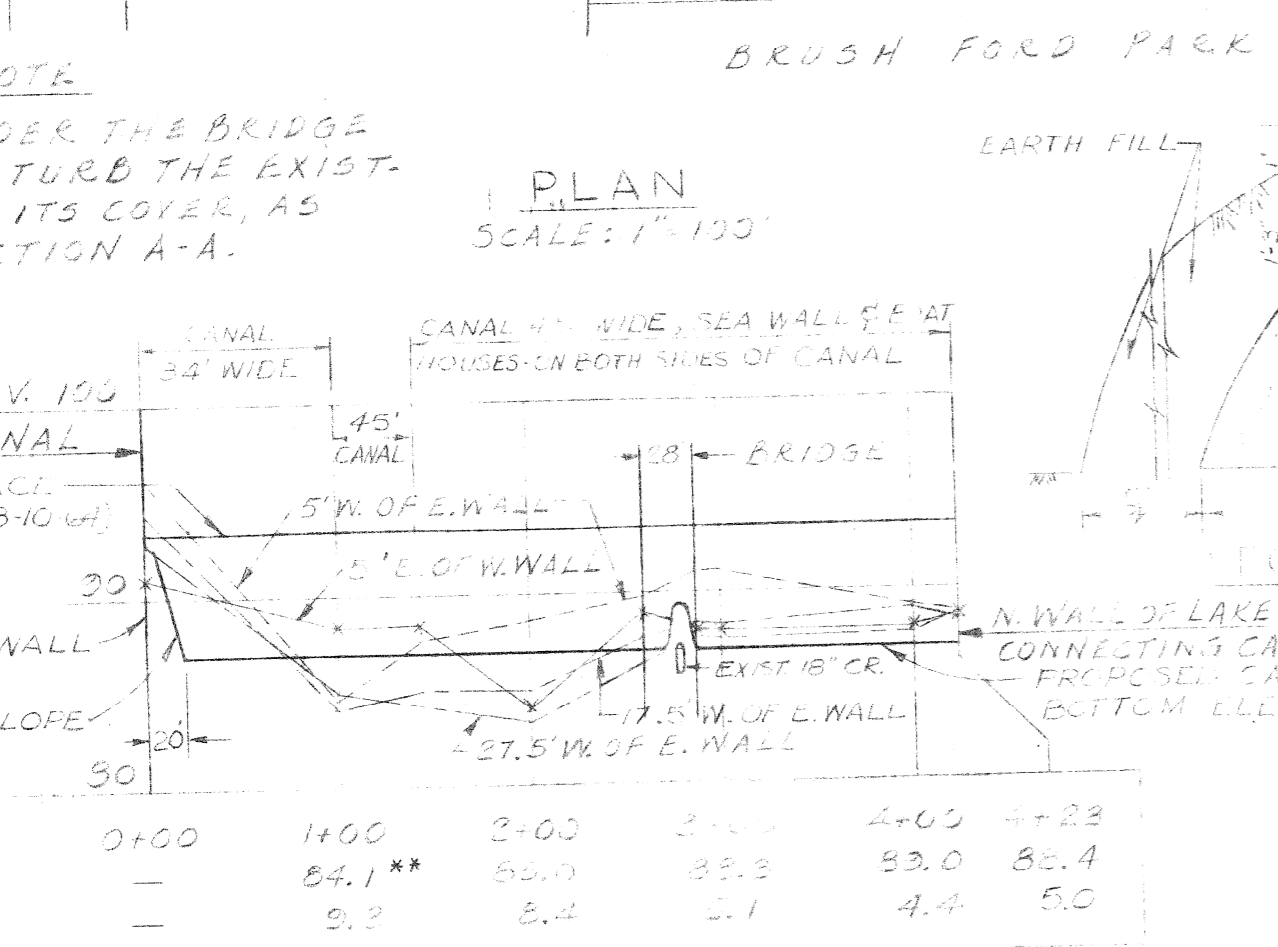
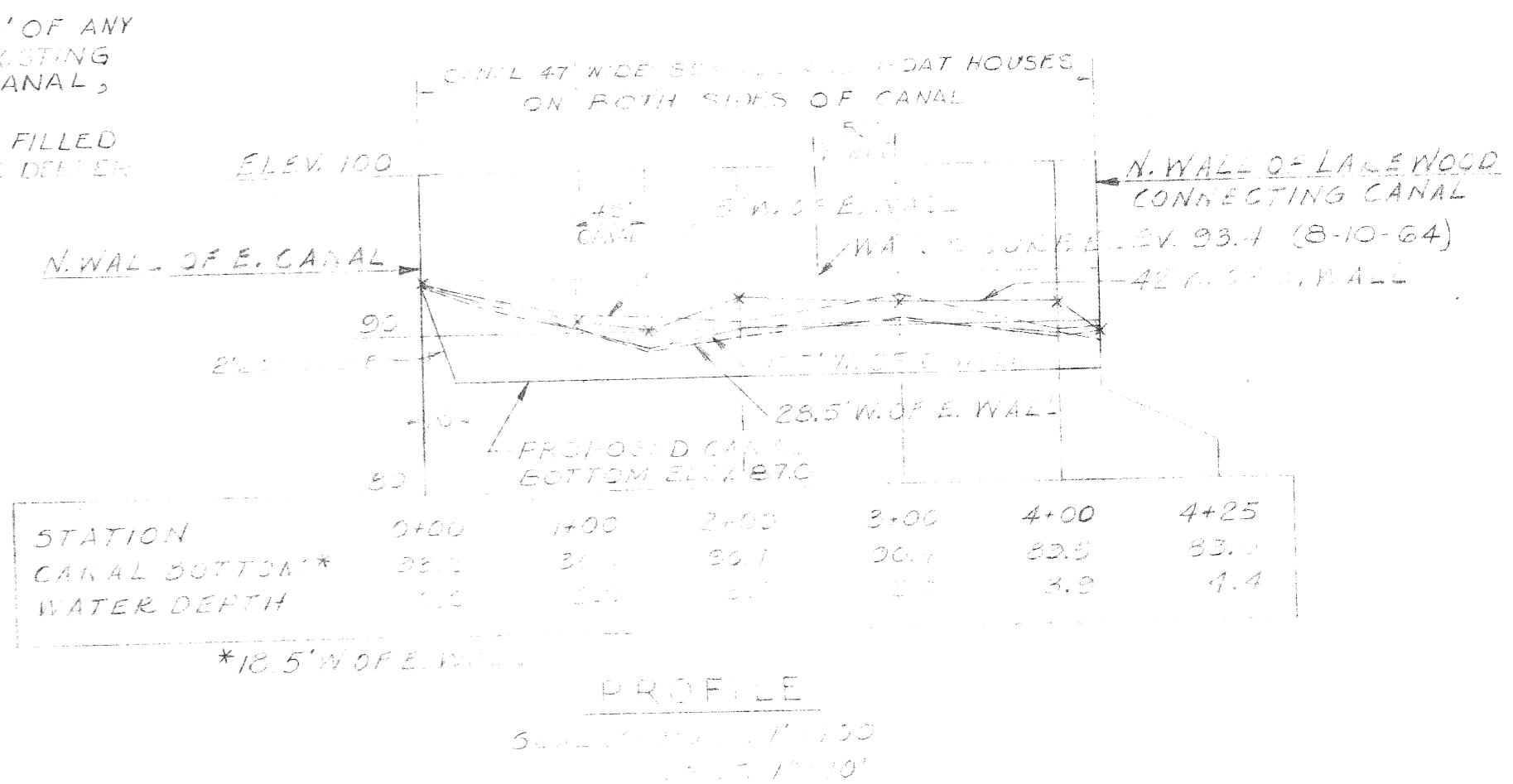
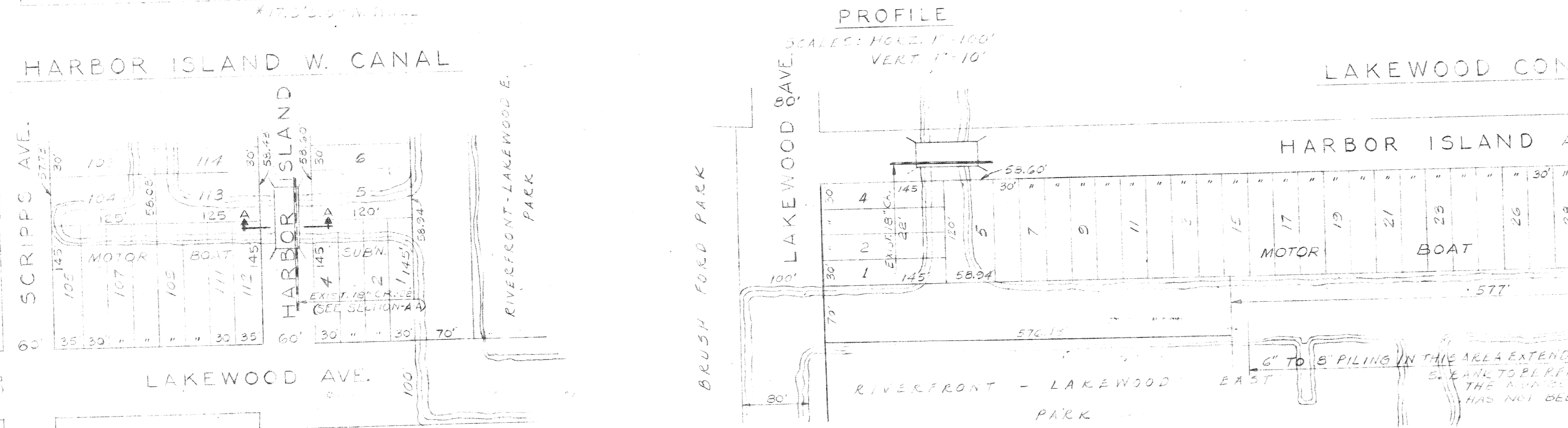
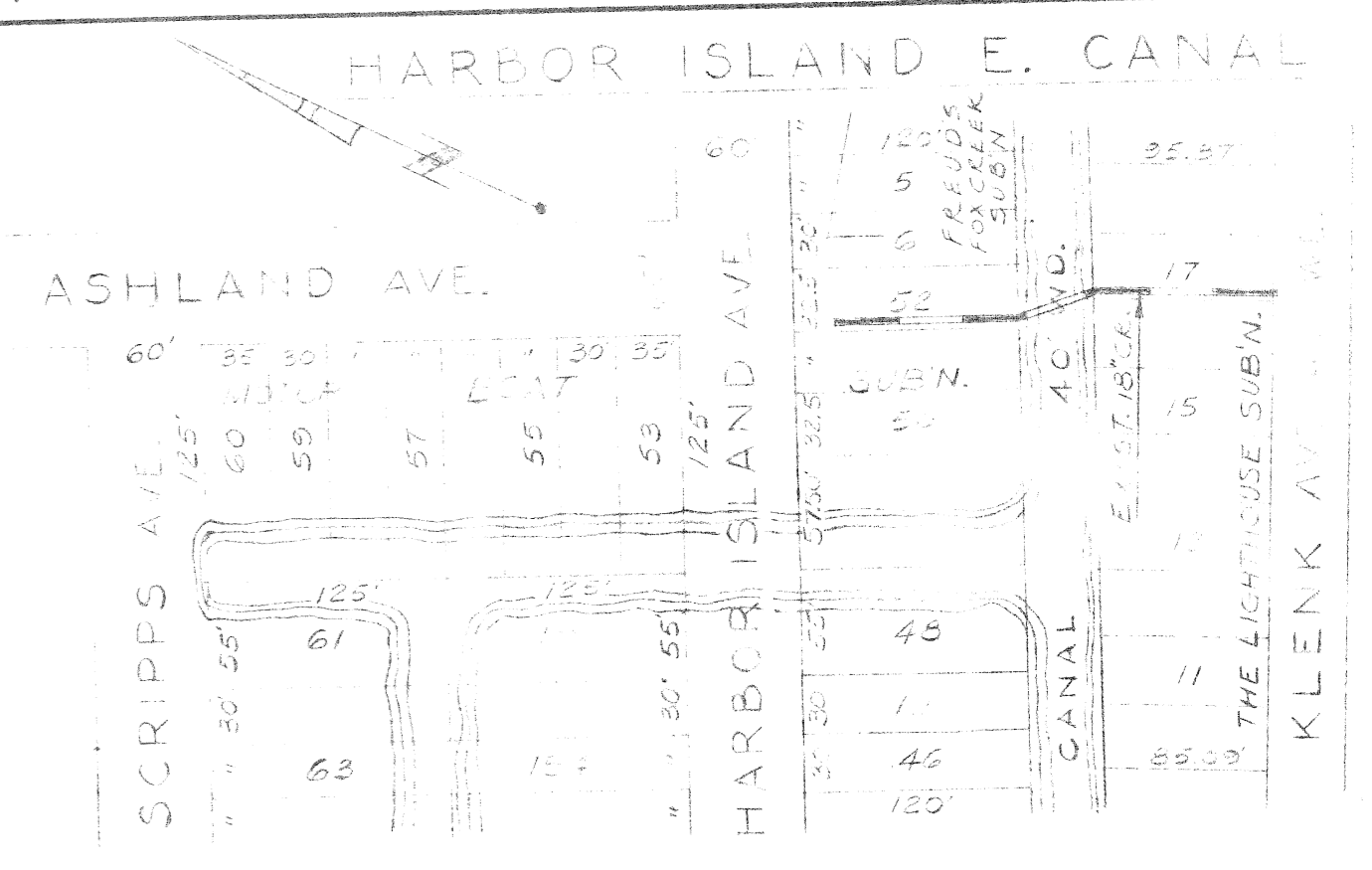
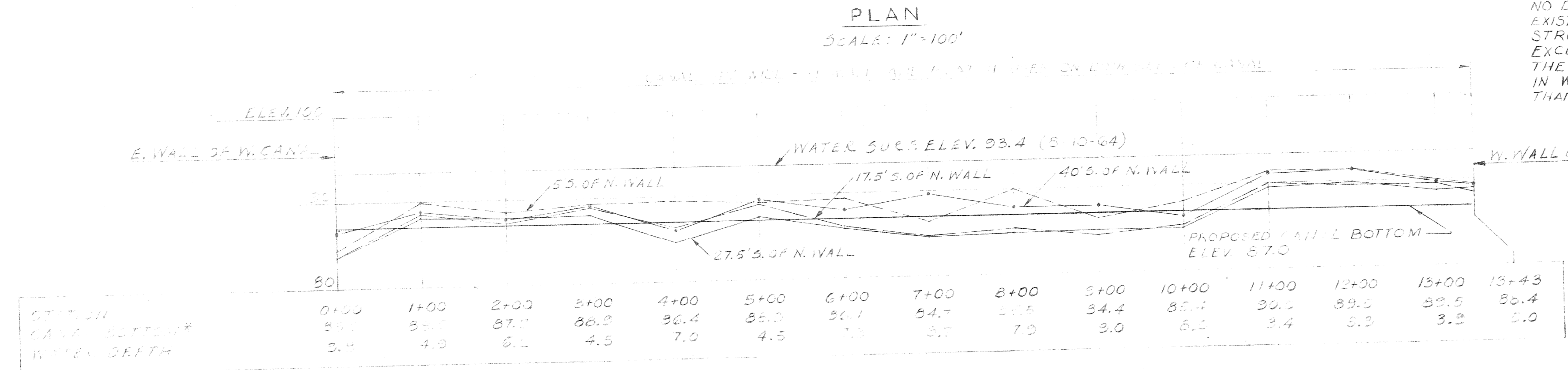

NOTE: DREDGING UNDER THE BRIDGE SHALL NOT DISTURB THE EXISTING SEWAGE ON ITS COVER, AS SHOWN IN SECTION A-A.

PLAN SCALE: 1"=100'

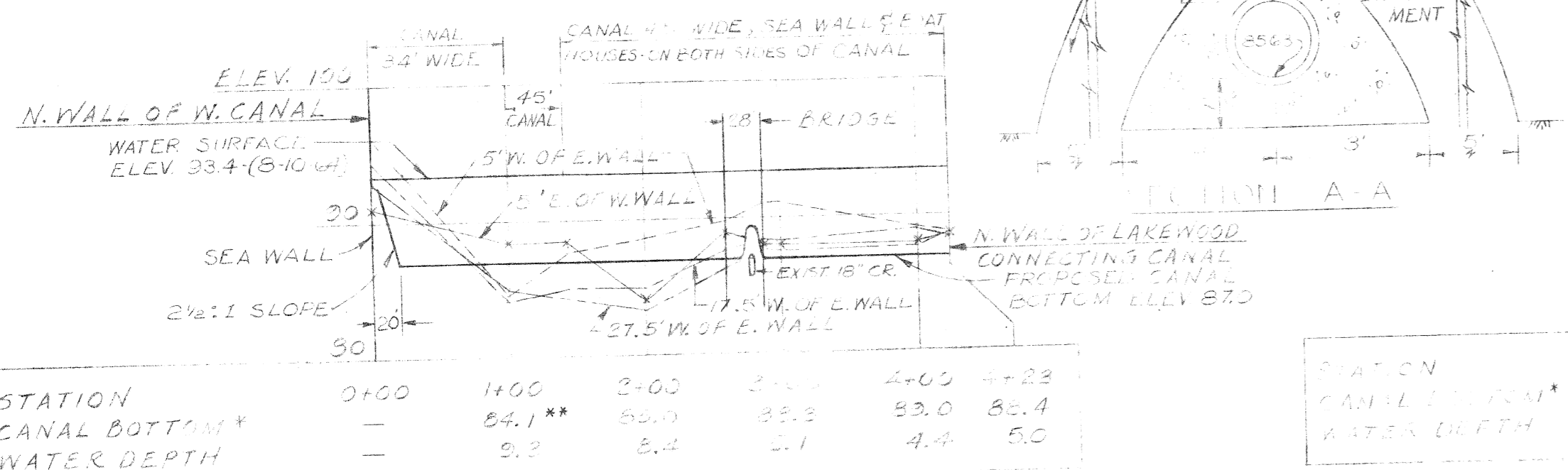
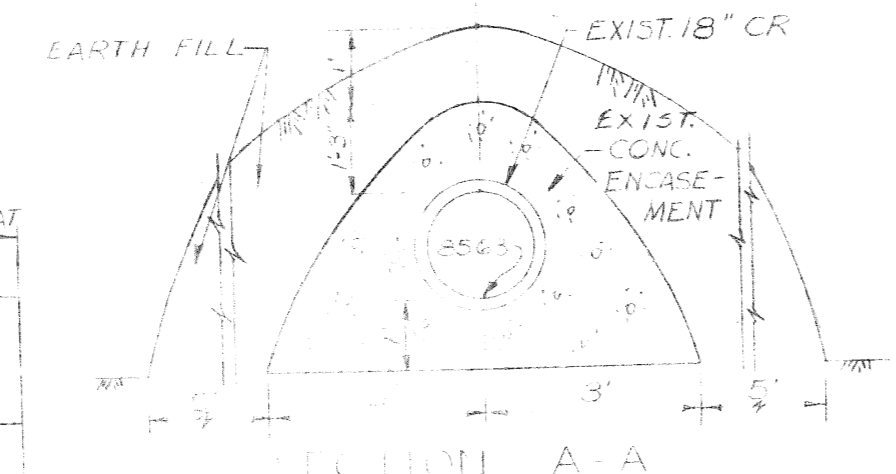

PROFILE SCALE: HORIZ. 1"=100' VERT. 1"=10'

COMPLETED 9-12-60
U.S. MARINE SALVAGE

DESIGNED BY	A.H. Hale	APPROVED:	[Signature]
DRAWN BY	P. [Signature]	CITY ENGINEER	[Signature]
TRACED BY	P. [Signature]		
CHECKED BY	J.E. [Signature]		

CITY OF DETROIT
DEPARTMENT OF PUBLIC WORKS
CITY ENGINEERS OFFICE
FOR
THE DEPARTMENT OF PUBLIC WORKS

DREDGING OF HARBOR ISLAND
& LAKWOOD CONNECTING CANALS
PLANS AND PROFILES OF CANALS

DFC-12-311
SHEET 2 OF 4 SHEETS
CONTRACT NO. PW. 4588
DRWG NO. 1976-
DATE AUGUST 27, 1960

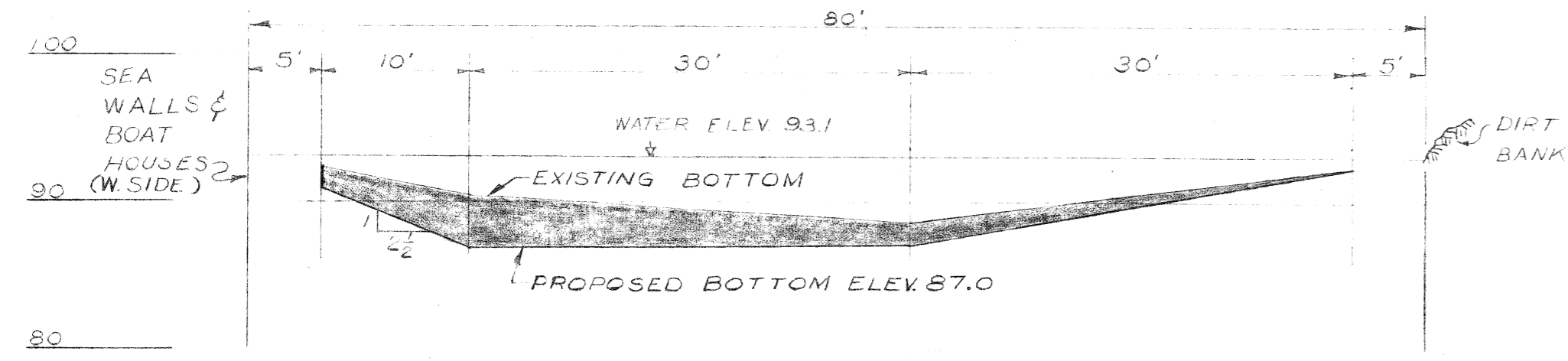

STA. 0+00

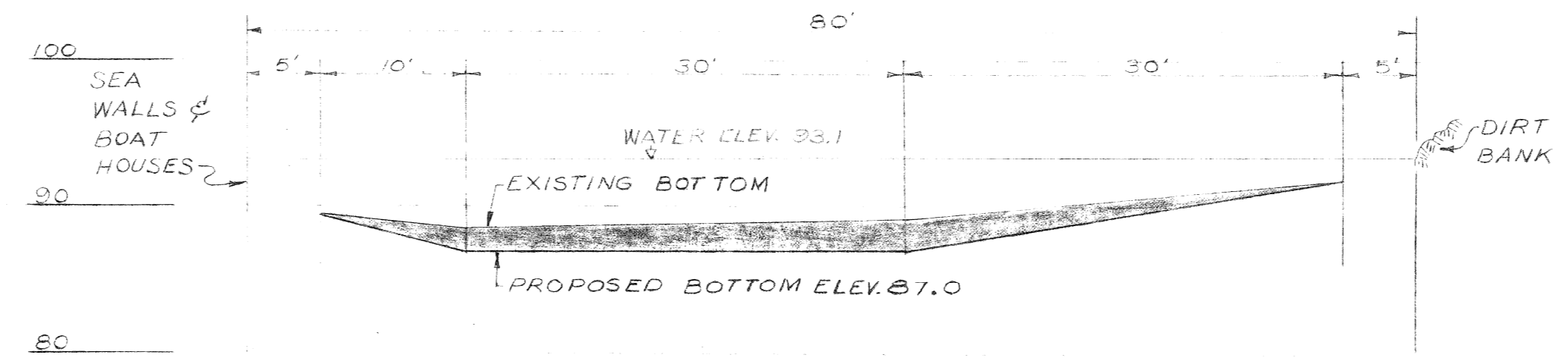

STA. 2+00

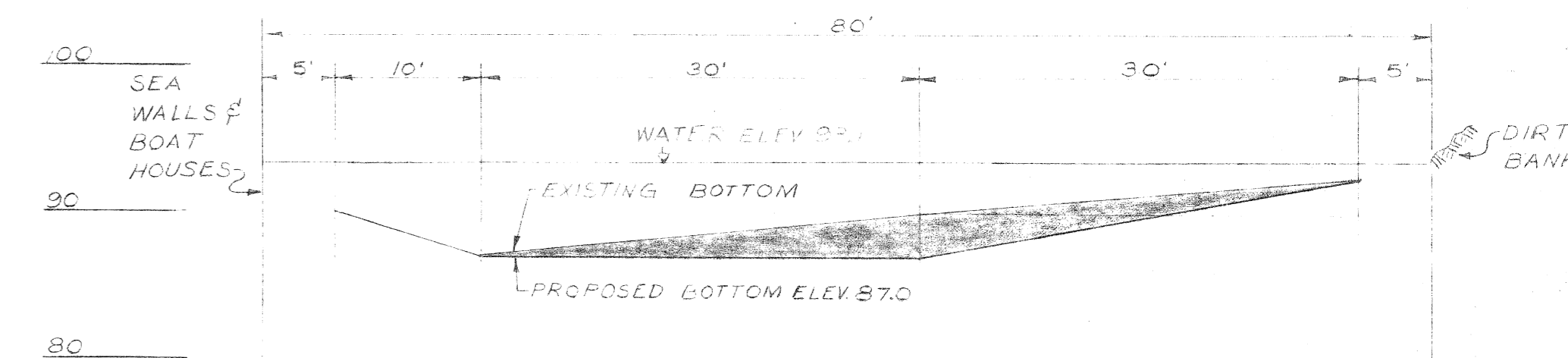

STA. 4+00

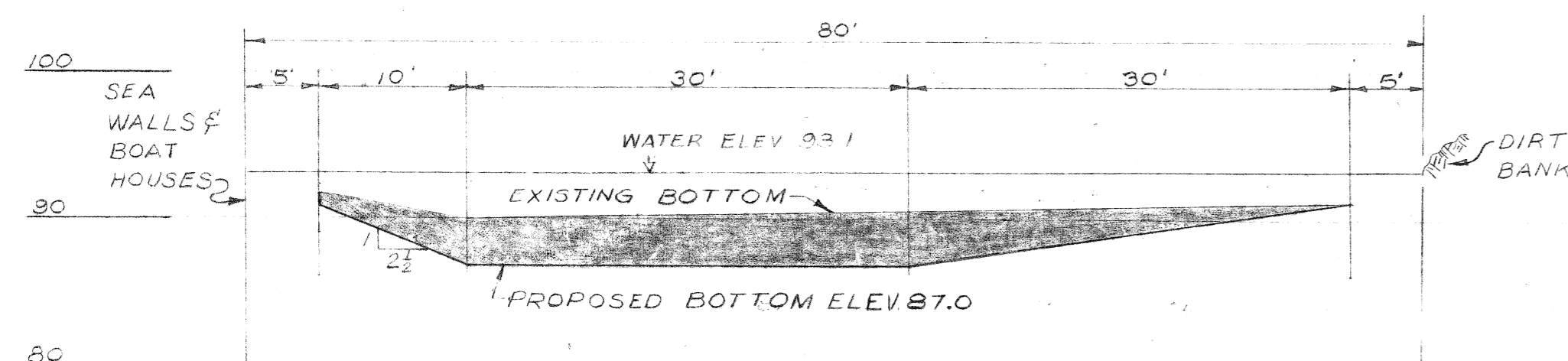

STA. 6+00

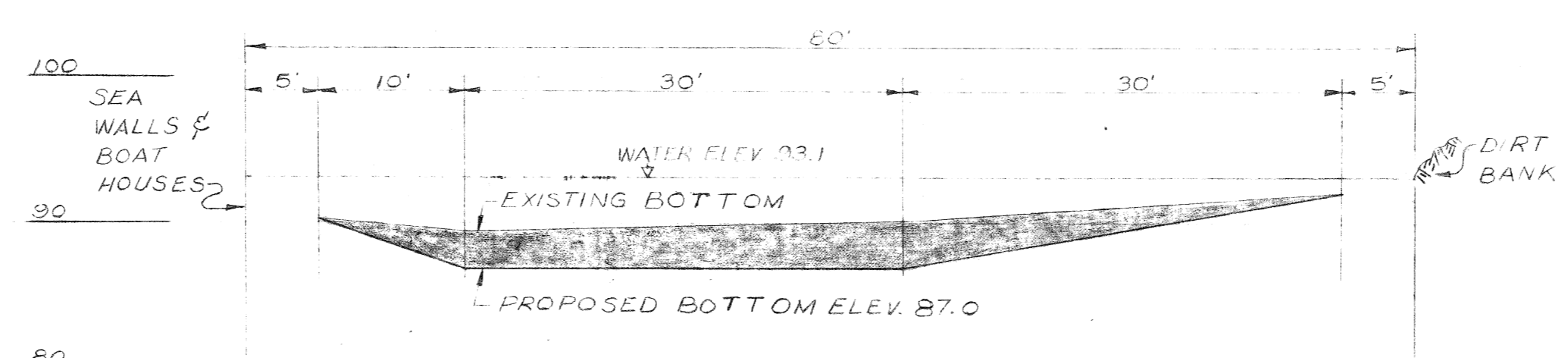

STA. 8+00

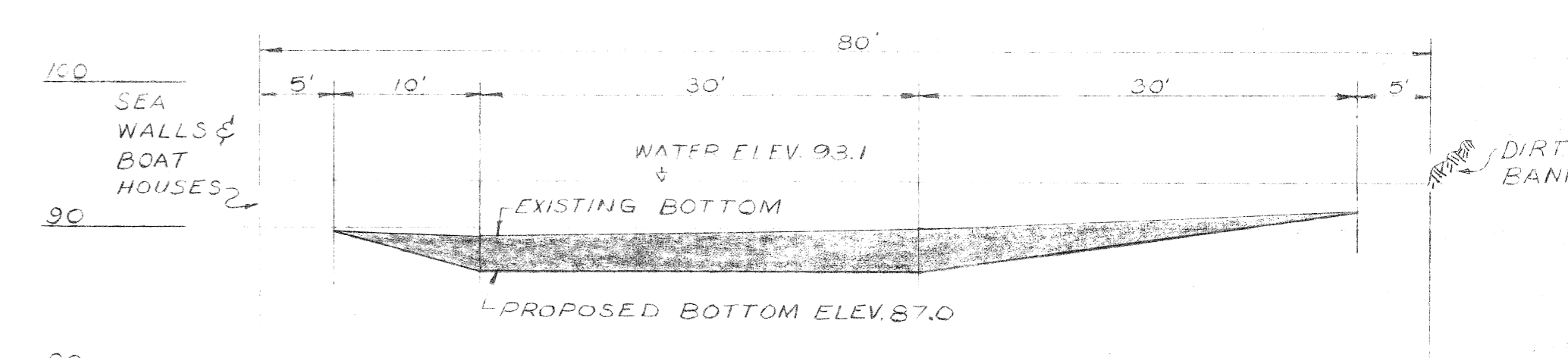

STA. 10+00

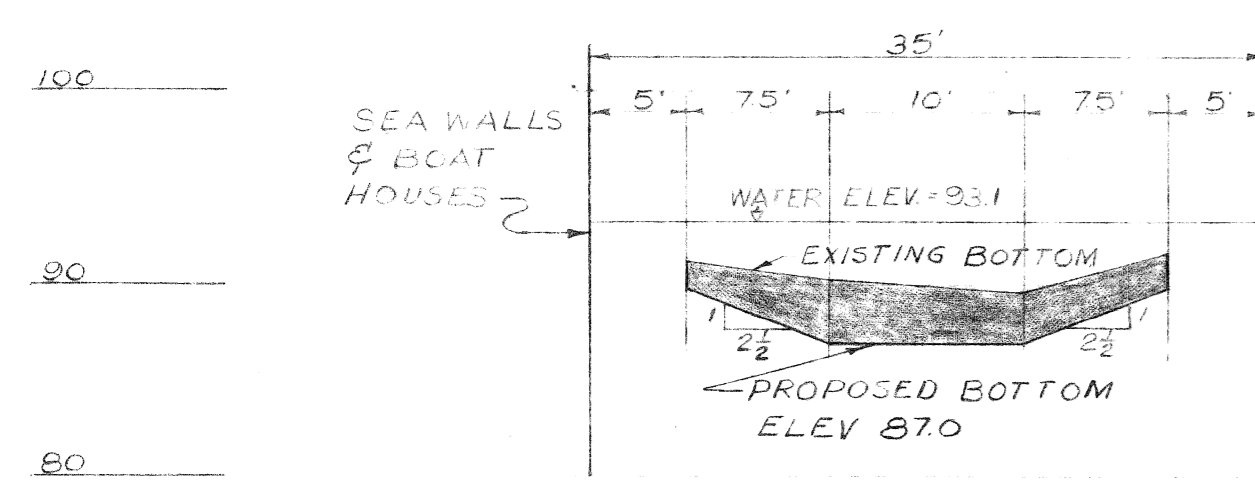

STA. 12+00

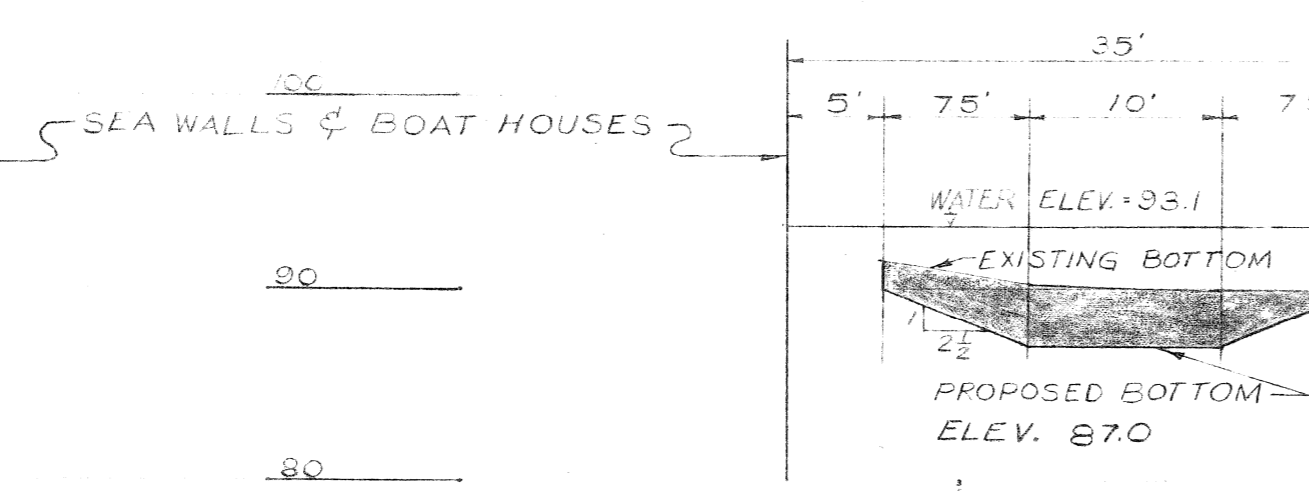

STA. 14+00

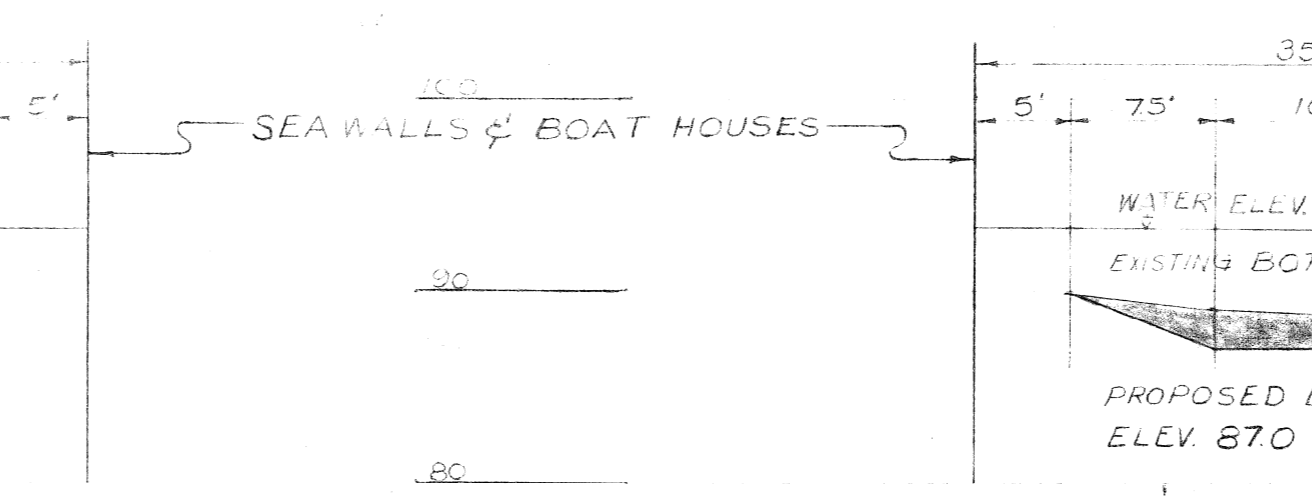

STA. 16+00

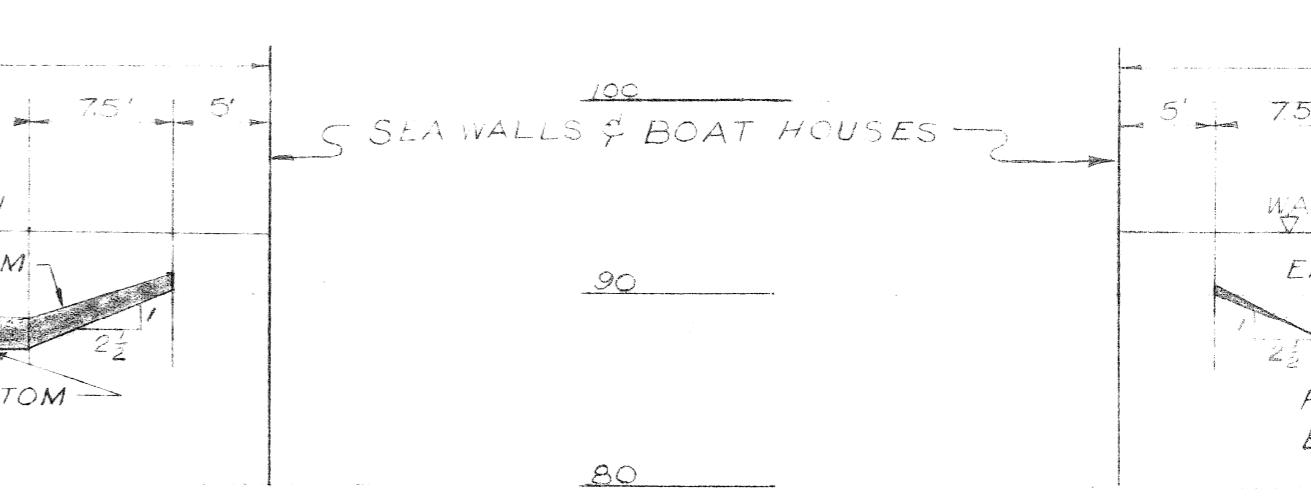

STA. 16+90 ±

LAST SECTION IS 1/2 IN THE ACTUAL BOAT SLURK.

NOTES
 NO DREDGING SHALL BE DONE WITHIN 5' OF ANY EXISTING SEA WALL OR ANY OTHER EXISTING STRUCTURE ALONG OR WITHIN THE CANAL, EXCEPT AS OTHERWISE SHOWN.
 SIDE SLOPES OF PROPOSED CANAL BOTTOM SHALL BE A MAXIMUM OF 2 1/2:1 OR AS SHOWN ON CROSS SECTIONS.
 THE CANAL BOTTOM SHALL NOT BE FILLED IN WHERE THE EXISTING BOTTOM IS DEEPER THAN ELEV. 87.0.

COMPLETED 9-12-65
 U.S. MARINE SALVAGE

REFERENCE: SURVEY 61-2 WATER SURFACE ELEV. 93.1 AUGUST 7, 1964

SCALE: 1" = 10'

DESIGNED BY <i>A. J. White</i> DRAWN BY <i>B. E. Hill</i> TRACED BY <i>B. E. Hill</i> CHECKED BY <i>A. E. Burke</i>		APPROVED: <i>A. Burke</i> SANITARY ENGINEER <i>W. Keenan</i> ASSIST. CITY ENGINEER <i>Quayle K. Palmer</i> CITY ENGINEER		CITY OF DETROIT DEPARTMENT OF PUBLIC WORKS CITY ENGINEERS OFFICE FOR THE DEPARTMENT OF PUBLIC WORKS.				DREDGING OF HARBOR ISLAND AND LAKEWOOD CONNECTING CANALS CROSS SECTIONS FOR LAKEWOOD CONNECTING CANAL				DFC - 12 - 312 SHEET 3 OF 4 SHEETS CONTRACT No. PW. 4588 DRWG No. 1976-3 DATE August 27, 1964	
--	--	---	--	---	--	--	--	--	--	--	--	---	--

REVISIONS LOCATED BY COORDINATES ON SHEET

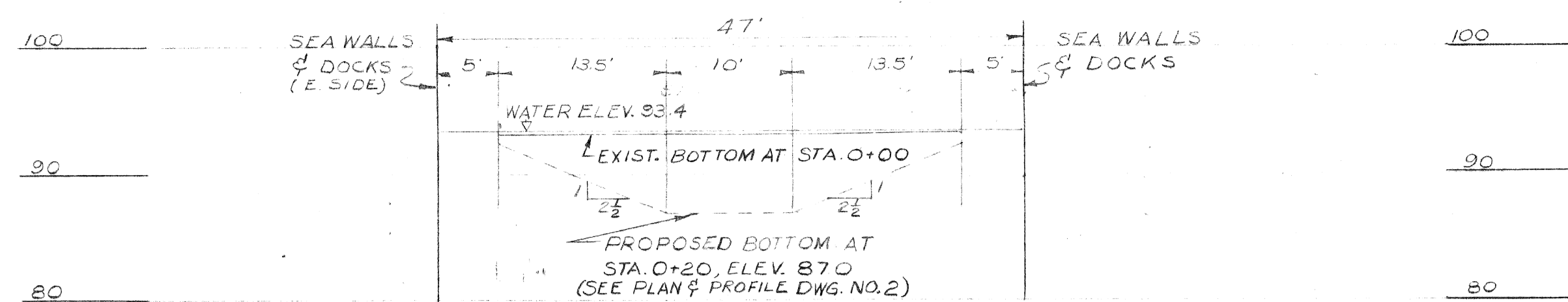

STA. 0+00
(AT RETAINING WALL)

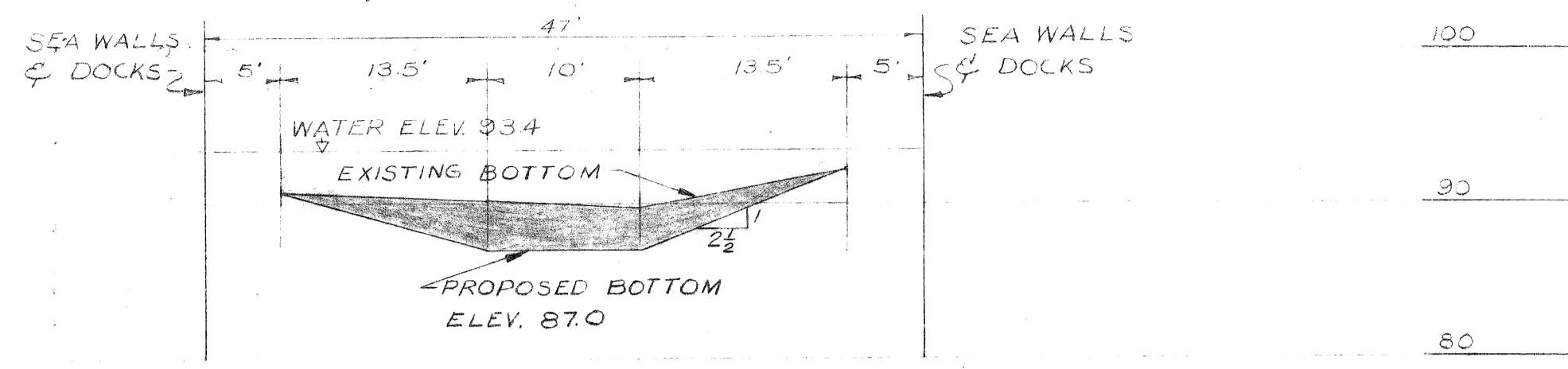

STA. 2+00

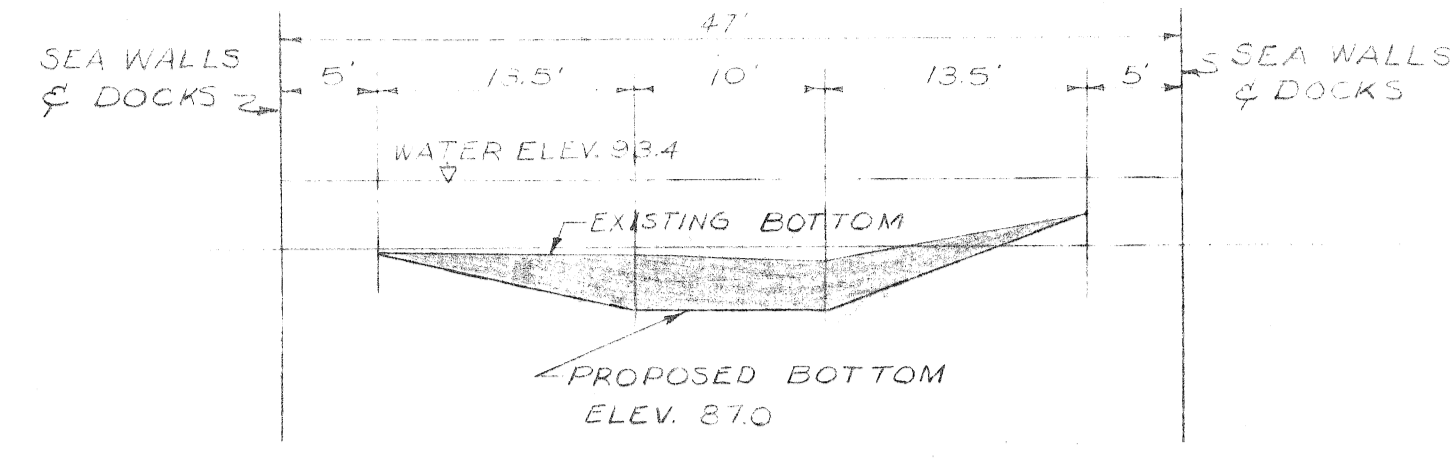

STA. 4+00

HARBOR ISLAND E. CANAL
SCALE: 1"=10'

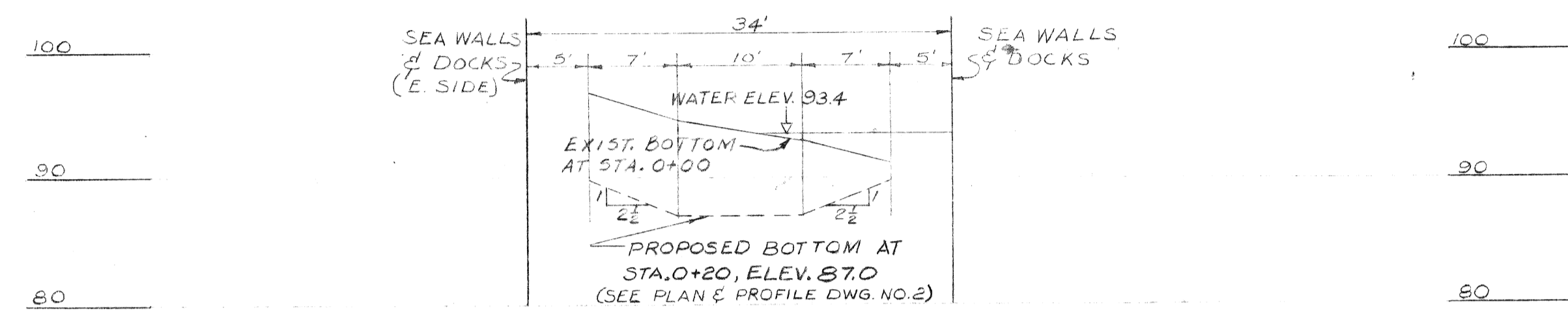

STA. 0+00
(AT RETAINING WALL)

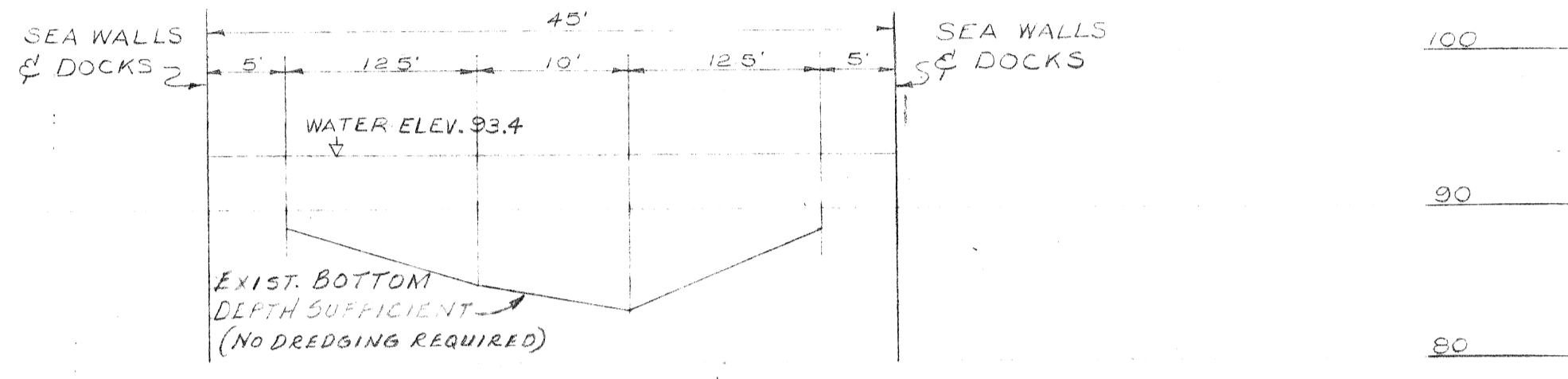

STA. 2+00

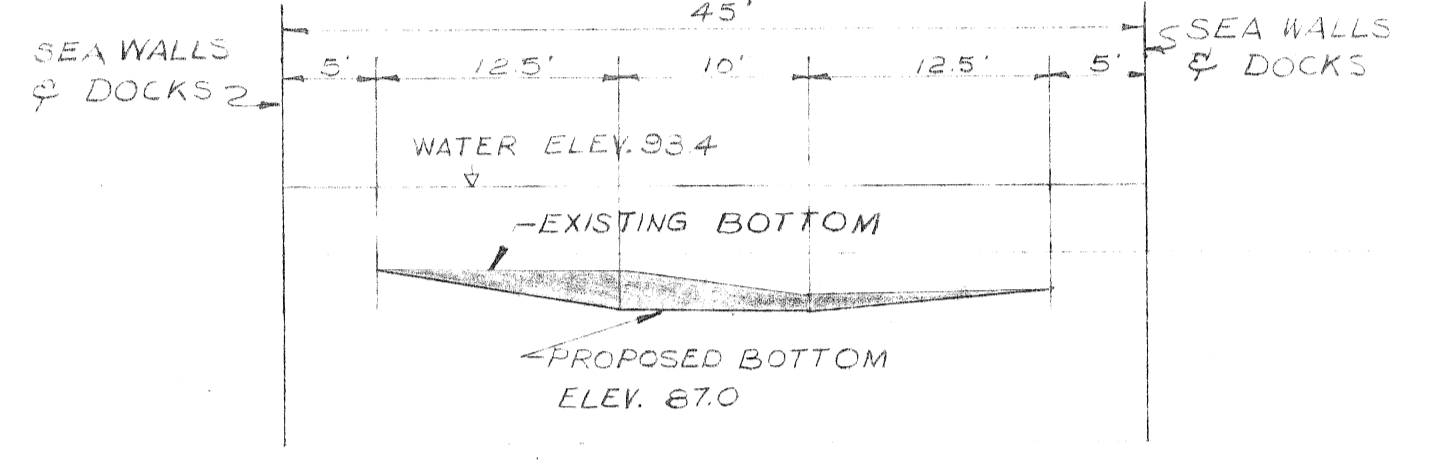

STA. 4+00

HARBOR ISLAND W. CANAL
SCALE: 1"=10'

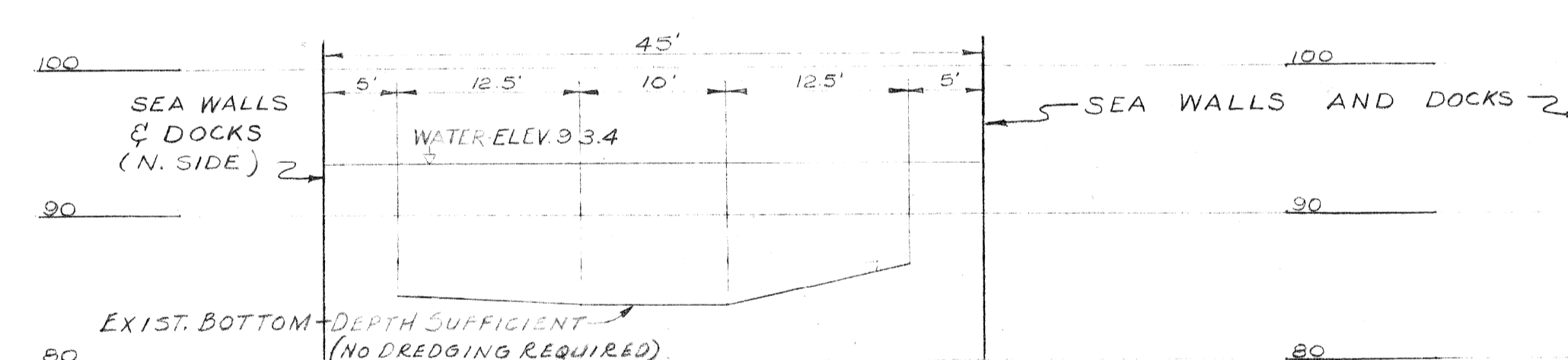

STA. 0+00

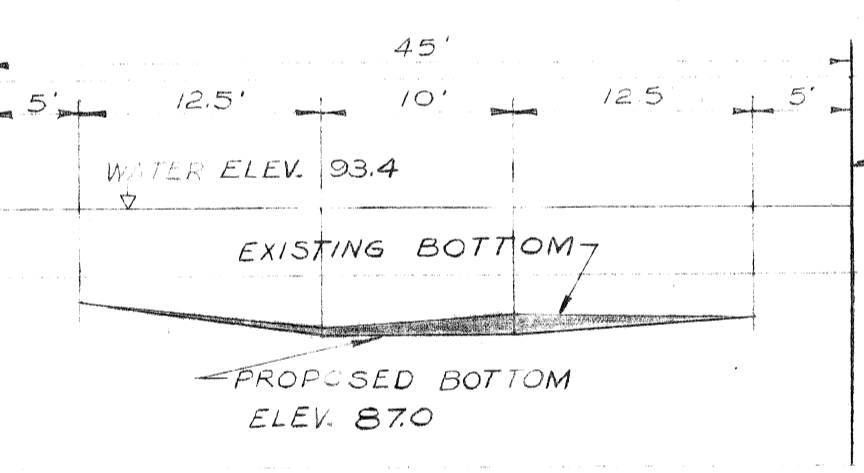

STA. 2+00

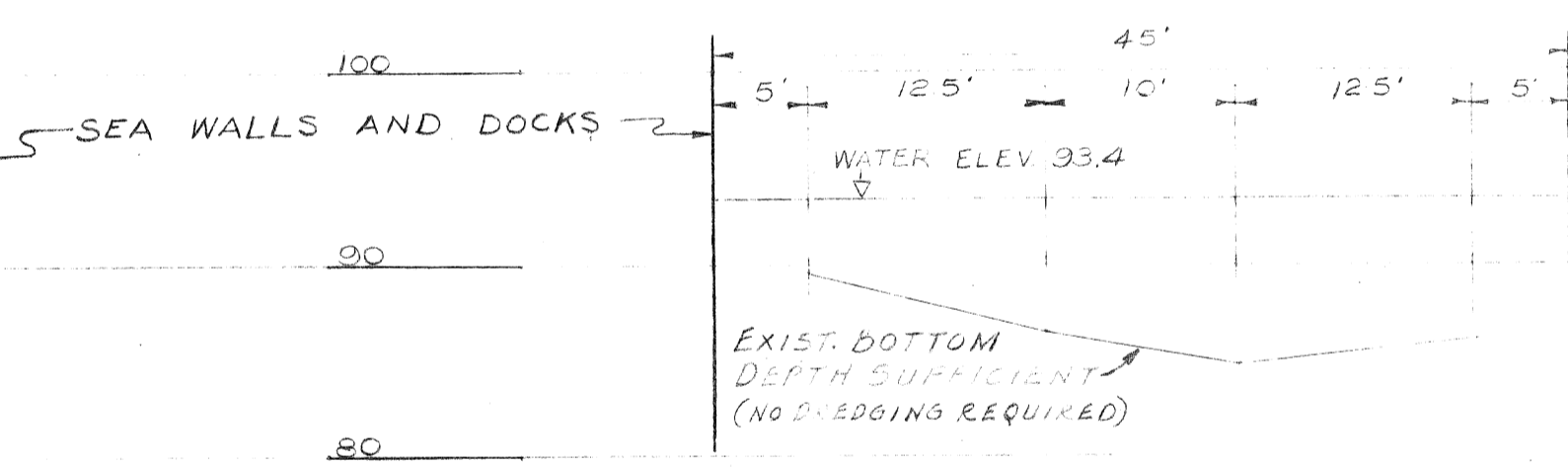

STA. 4+00

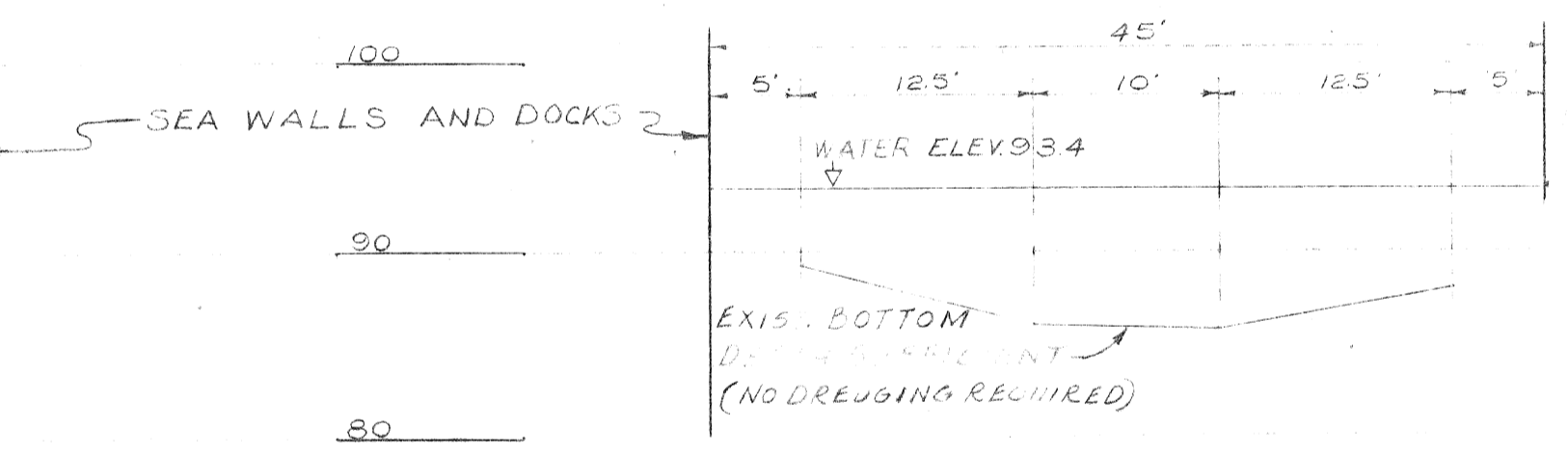

STA. 6+00

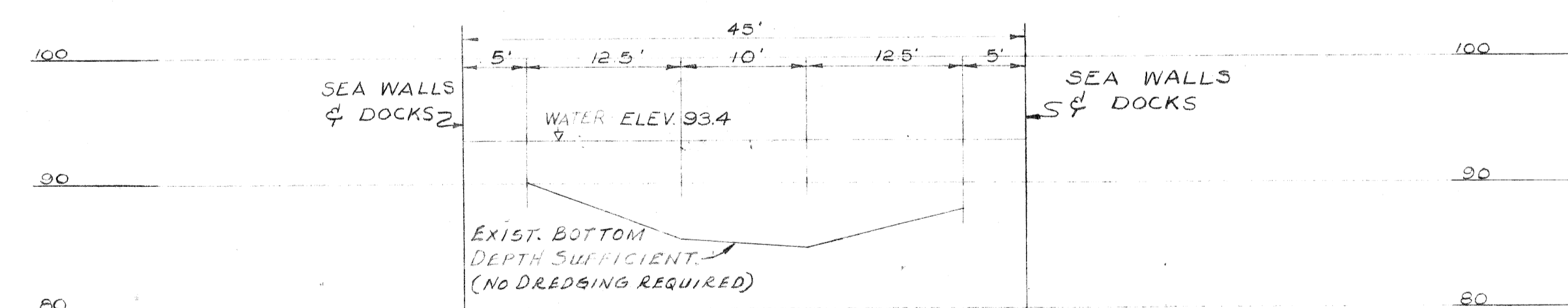

STA. 8+00

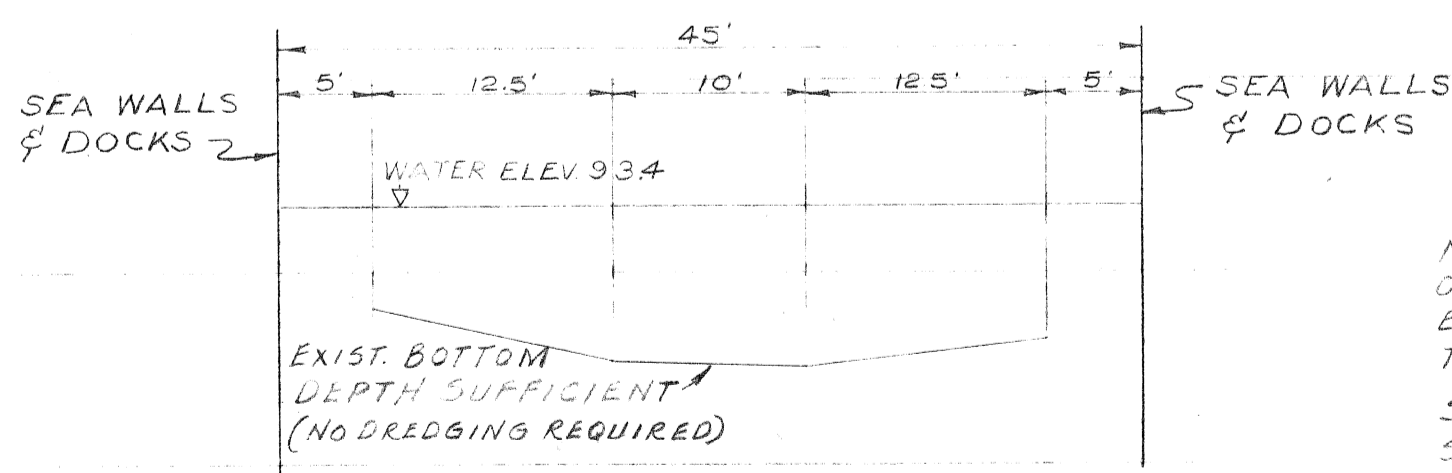

STA. 10+00

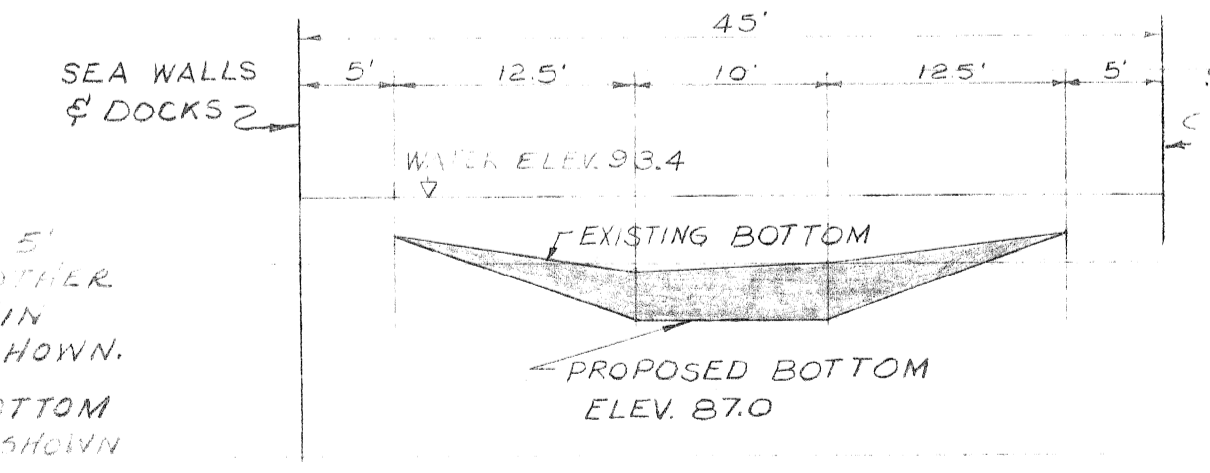

STA. 12+00

NOTES
NO DREDGING SHALL BE DONE WITHIN 5' OF ANY EXISTING SEA WALL OR ANY OTHER EXISTING STRUCTURE ALONG OR WITHIN THE CANAL, EXCEPT AS OTHERWISE SHOWN. SIDE SLOPES OF PROPOSED CANAL BOTTOM SHALL BE A MINIMUM OF 2 1/2:1 OR AS SHOWN ON CROSS-SECTIONS. THE CANAL BOTTOM SHALL NOT BE FILLED IN WHERE THE EXISTING BOTTOM IS DEEPER THAN ELEV. 87.0.

HARBOR ISLAND CANAL
SCALE: 1"=10'

CONF
U.S.F.

REFERENCE: SURVEY 61-2 WATER SURFACE ELEV. 93.4 AUGUST 10, 1964

DESIGNED BY	H. W. Hale	APPROVED	R. Luke
DRAWN BY	C. B. Hill	SANITARY ENGINEER	
TRACED BY	C. B. Hill	ASST. CITY ENGINEER	
CHECKED BY	H. E. Luke	CITY ENGINEER	

CITY OF DETROIT
DEPARTMENT OF PUBLIC WORKS
CITY ENGINEERS OFFICE
FOR
THE DEPARTMENT OF PUBLIC WORKS

DREDGING OF HARBOR ISLAND AND LAKEWOOD CONNECTING CANALS
FOR
CROSS SECTIONS FOR HARBOR ISLAND CANALS

REVISIONS LOCATED BY COORDINATES ON SHEET