

1 copy

REDFORD TWP  
CITY OF DETROIT

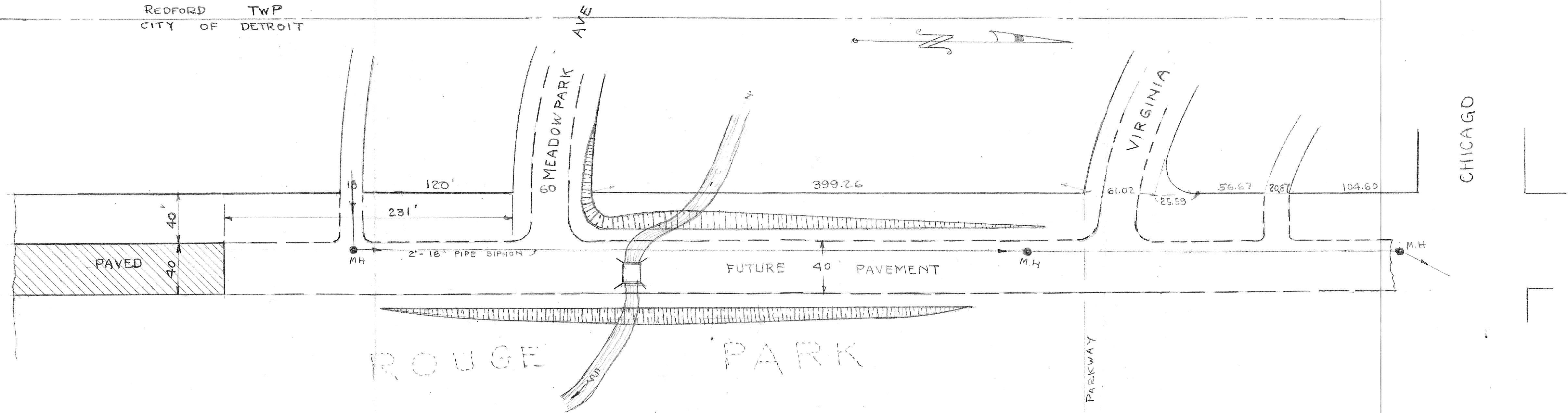

ROUGE PARK

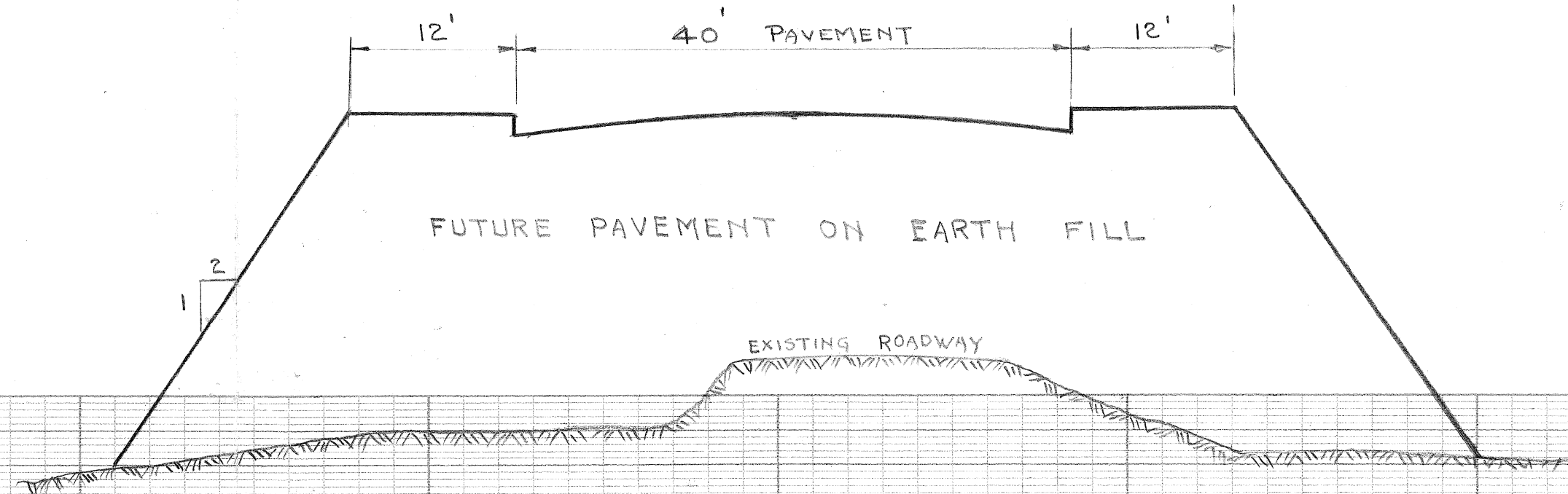

X SECTION 100' N. OF MEADOWBROOK

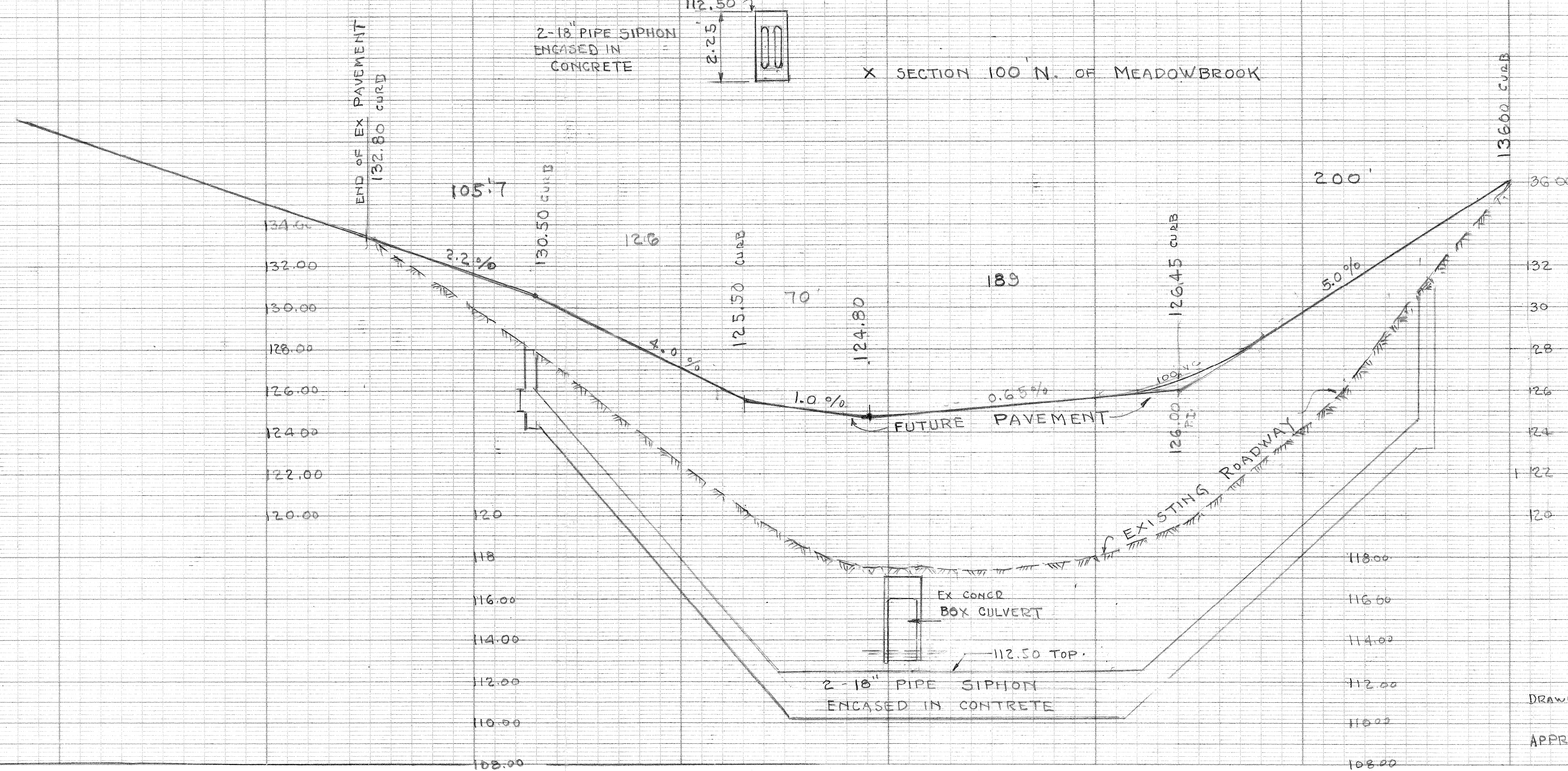

SCALE { HORIZ 1" = 50 FT  
VERT 1" = 4 FT

411394

SKETCH OF PROPOSED PAVEMENT AND  
EARTH FILL ON WEST PARKWAY AVE  
BETWEEN MEADOWPARK & VIRGINIA AVE

DRAWN BY H. J. SMART APRIL 9, 1937 GRADE BY J. ERICKSON

APPROVED BY *Behm*

OK