

**PLAN**

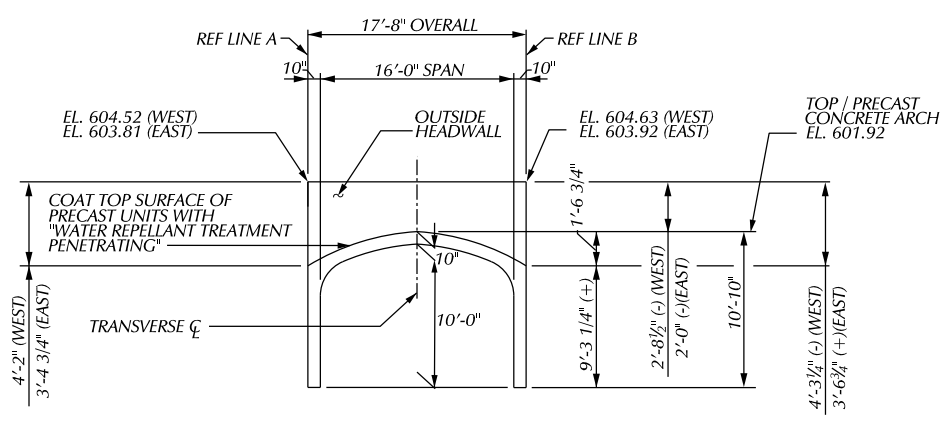

**SECTION A-A (WEST HEADWALL)  
SECTION D-D (EAST HEADWALL)**  
(ED BARS NOT SHOWN)

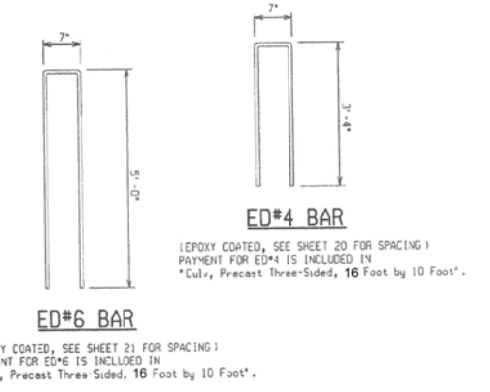

**MISCELLANEOUS QUANTITIES**

62 FT	CULV. PRECAST THREE-SIDED OR ARCH, 16 FOOT BY 10 FOOT
100 SYD	WATER REPELLANT TREATMENT, PENETRATING

**NOTES:**

DESIGN ALL CULVERT / HEADWALL CONNECTIONS FOR TRAFFIC LOADS.

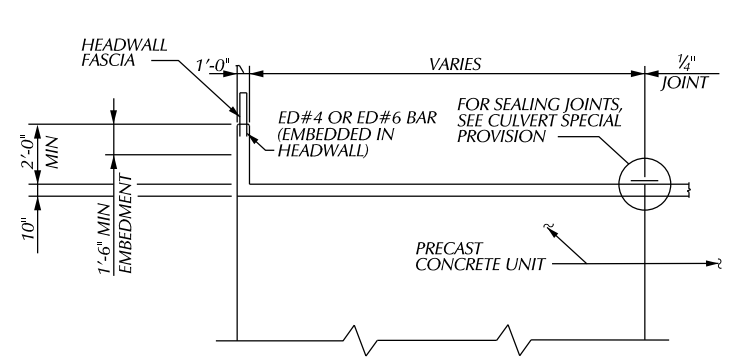

**SECTION B-B**

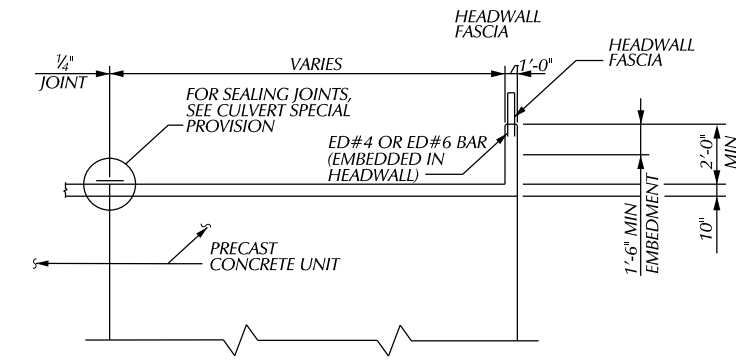

**SECTION C-C**

PLAN	BY	CHECKED BY	APPROVED
GRADE			
ESTIMATE			
FINAL	****	****	

CITY OF DETROIT  
CITY ENGINEERING DIVISION - D.P.W.  
BUREAUS OF STREETS AND HIGHWAYS  
FOR

**WEST PARKWAY CULVERT OVER ASHCROFT - SHERWOOD DRAIN**

**CONCRETE ARCH DETAILS**

SHEET	OF	SHEETS
CONTRACT		
NO.		
ASSIGNMENT		
NO.		
DATE		