

BENCHMARKS	
BM#1	ELEV = 616.82
CHISEL MARK 26.4 FEET RIGHT OF STA 4+81	
BM#2	ELEV = 605.44
CHISEL MARK SW COR. W. PARKWAY & MEADOWPARK	

WITNESSES	
WITNESSES TO CP#2 EAST - W. PARKWAY, NORTH HAZELTON 55' FRONT LIGHTPOLE NORTH	
CP#86 SW COR. W. PARKWAY & MEADOWPARK 5' N. FIRE HYDRANT 7' W. CURB LINE 30' S. SOUTH CURB LINE OF MEADOWPARK	

REF PT COORDINATES	
REF PT A	X=5000.00 Y=5092.93
REF PT B	X=5040.57 Y=4555.99

**NOTES:**

THE WORK COVERED BY THESE PLANS INCLUDED REMOVAL OF THE EXISTING METAL CORRUGATED STEEL CULVERT. CONSTRUCTION OF THE PROPOSED CULVERT & RETAINING WALL AND PLACING RIPRAP TO THE LIMITS SHOWN. ALL OTHER WORK IS INCLUDED IN THE ROAD PLANS THAT ARE PART OF THE PACKAGE.

THE STATIONING SHOWN IS UNIQUE TO THIS PROJECT AND CANNOT BE RELATED TO ANY OTHER EXISTING STATIONING.

W. PARKWAY TRAFFIC IS TO BE DETOURED OVER OTHER EXISTING ROADS.

THE CONTRACTOR SHALL LOCATE ALL ACTIVE UNDERGROUND UTILITIES PRIOR TO STARTING WORK AND SHALL CONDUCT HIS OPERATIONS IN SUCH A MANNER AS TO ENSURE THAT THOSE UTILITIES NOT REQUIRING RELOCATION WILL NOT BE DISTURBED.

WATER LEVEL IS SUBJECT TO CHANGE. THE CONTRACTOR IS RESPONSIBLE FOR MAKING A DETERMINATION OF WATER LEVELS THAT MAY EXIST DURING CONSTRUCTION.

MEASURES SHALL BE TAKEN TO PREVENT DEBRIS FROM FALLING FROM THE STRUCTURES, IF DEBRIS FALLS INTO THE THE WATERWAY, IT SHALL BE REMOVED WITHIN 24 HOURS. SINCE DISTURBANCE OF THE WATERWAY BOTTOM MAY BE AS HARMFUL AS THE DEBRIS ITSELF, THE PREVENTIVE MEASURES MUST BE EFFECTIVE.

IMMEDIATELY AFTER THE CONSTRUCTION OF A CULVERT SLOPE IS COMPLETED, SLOPE PROTECTION AND SEEDING OR SODDING SHALL BE PLACED ON THE ADJACENT EMBANKMENT SLOPES.

PLANS REFER TO THE NAVD88 DATUM.

THE SURVEY INFORMATION ON THIS PROJECT WAS ACQUIRED BY THE CITY OF DETROIT DEPARTMENT OF PUBLIC WORKS, CITY ENGINEER DIVISION SURVEYOR.

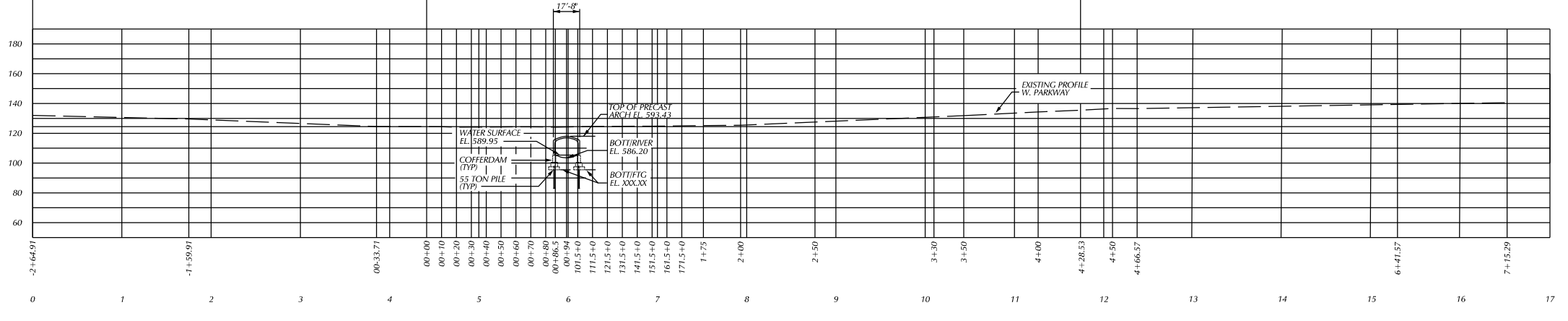
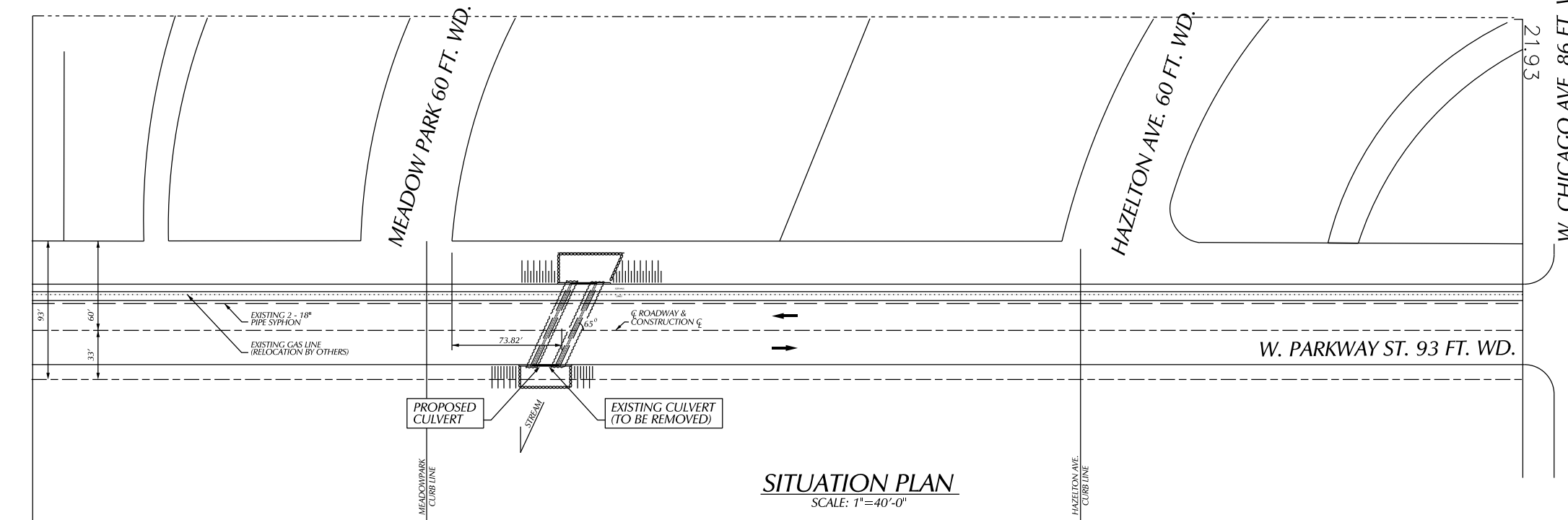

PROPOSED PROFILE ALONG W. PARKWAY GRADE  
VERT. SCALE: 1"=10'  
HOR. SCALE: 1"=40'

DESCRIPTION	DATE	BY	CHECKED BY	APPROVED:
PLAN				
GRADE				
ESTIMATE				
FINAL				

CITY OF DETROIT  
CITY ENGINEERING DIVISION - D.P.W.  
BUREAU OF STREETS AND HIGHWAYS  
FOR

WEST PARKWAY CULVERT OVER ROUGE RIVER	SHEET _____ OF _____ SHEETS
	CONTRACT NO.
GENERAL PLAN OF SITE	ASSIGNMENT NO.
	DATE