

BENCHMARKS

BM#1 ELEV = 616.82
CHISEL MARK 26.4 FEET
RIGHT OF STA 4+81

BM#2 ELEV = 605.44
CHISEL MARK SW COR.
W. PARKWAY & MEADOWPARK

WITNESSES

WITNESSES TO CP#2 EAST - W. PARKWAY, NORTH HAZELTON
55' FRONT LIGHTPOLE NORTH

CP#86 SW COR. W. PARKWAY & MEADOWPARK
5' N. FIRE HYDRANT
7' W. CURB LINE
30' S. SOUTH CURB LINE OF MEADOWPARK

REF PT COORDINATES

REF PT A X=5000.00
Y=5092.93

REF PT B X=5040.57
Y=4555.99

NOTES:

THE WORK COVERED BY THESE PLANS INCLUDED REMOVAL OF THE EXISTING METAL CORRUGATED STEEL CULVERT. CONSTRUCTION OF THE PROPOSED CULVERT & RETAINING WALL. PLACING RIPRAP TO THE LIMITS SHOWN, RE-WORK APPROACHES AND MAINTAINING TRAFFIC. ALL OTHER WORK NOT INCLUDED IN THESE PLANS THAT AREN'T PART OF THE PACKAGE.

THE STATIONING SHOWN IS UNIQUE TO THIS PROJECT AND CANNOT BE RELATED TO ANY OTHER EXISTING STATIONING.

W. PARKWAY TRAFFIC IS TO BE DETOURED OVER OTHER EXISTING ROADS.

THE CONTRACTOR SHALL LOCATE ALL ACTIVE UNDERGROUND UTILITIES PRIOR TO STARTING WORK AND SHALL CONDUCT HIS OPERATIONS IN SUCH A MANNER AS TO ENSURE THAT THOSE UTILITIES NOT REQUIRING RELOCATION WILL NOT BE DISTURBED.

WATER LEVEL IS SUBJECT TO CHANGE. THE CONTRACTOR IS RESPONSIBLE FOR MAKING A DETERMINATION OF WATER LEVELS THAT MAY EXIST DURING CONSTRUCTION.

MEASURES SHALL BE TAKEN TO PREVENT DEBRIS FROM FALLING FROM THE STRUCTURES, IF DEBRIS FALLS INTO THE WATERWAY, IT SHALL BE REMOVED WITHIN 24 HOURS. SINCE DISTURBANCE OF THE WATERWAY BOTTOM MAY BE AS HARMFUL AS THE DEBRIS ITSELF, THE PREVENTIVE MEASURES MUST BE EFFECTIVE.

IMMEDIATELY AFTER THE CONSTRUCTION OF A CULVERT SLOPE IS COMPLETED, SLOPE PROTECTION AND SEEDING OR SODDING SHALL BE PLACED ON THE ADJACENT EMBANKMENT SLOPES.

PLANS REFER TO THE NAVD88 DATUM.

THE SURVEY INFORMATION ON THIS PROJECT WAS ACQUIRED BY THE CITY OF DETROIT DEPARTMENT OF PUBLIC WORKS, CITY ENGINEER DIVISION SURVEYOR.

SCALE	HORIZONTAL VERTICAL	BOOK NO.	PG.	LEVEL DATE	BEFORE STARTING CONSTRUCTION MUST CHECK WITH UTILITIES FOR LOCATIONS OF EXISTING STRUCTURES WHETHER OR NOT INDICATED ON PLANS.	CONTRACTOR
-------	------------------------	-------------	-----	---------------	--	------------

BENCH MARKS ELEV

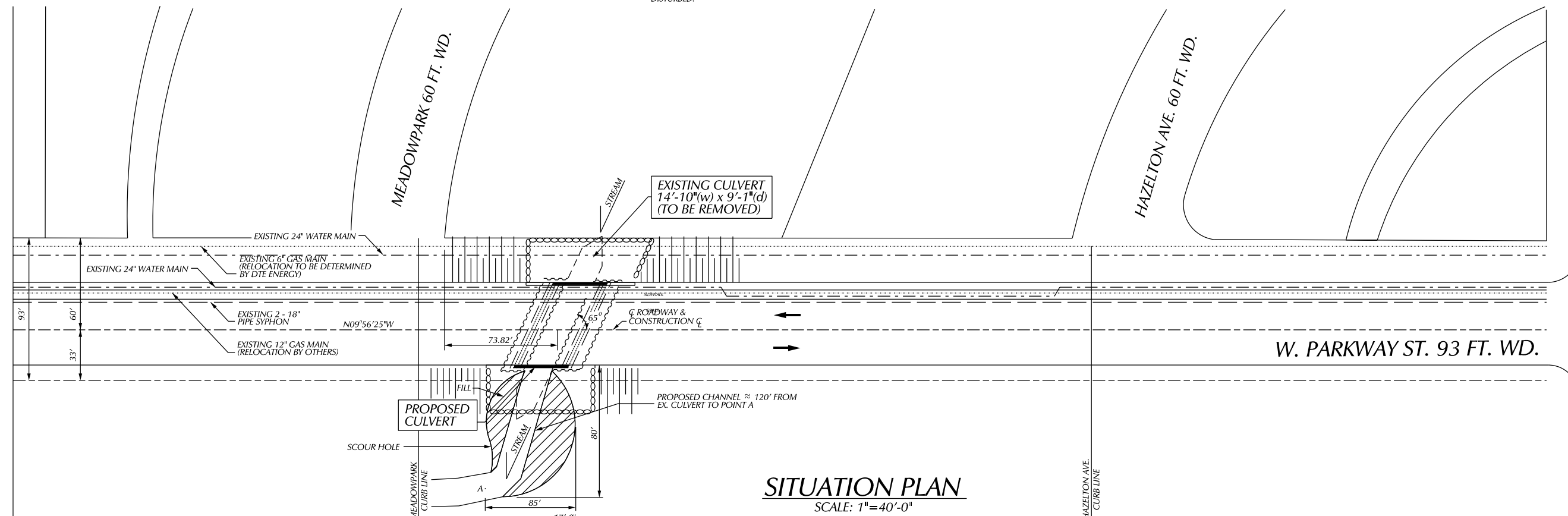

SITUATION PLAN
SCALE: 1"=40'-0"

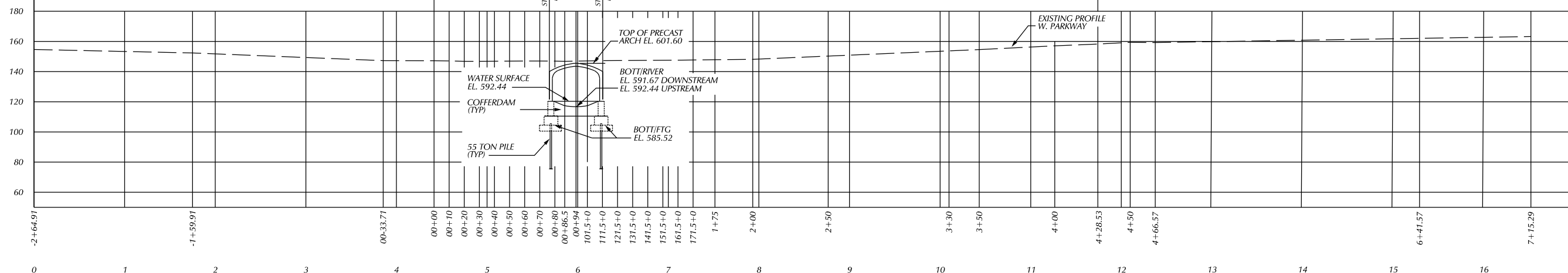

PROPOSED PROFILE ALONG W. PARKWAY GRADE
VERT. SCALE: 1"=10'
HOR. SCALE: 1"=40'

BY	CHECKED BY	APPROVED:
PLAN		
GRADE		
ESTIMATE		
DESCRIPTION	DR	CHK
REVISIONS	DATE	

CITY OF DETROIT
CITY ENGINEERING DIVISION - D.P.W.
BUREAUS OF STREETS AND HIGHWAYS
FOR

WEST PARKWAY CULVERT OVER ASHCROFT - SHERWOOD DRAIN

GENERAL PLAN OF SITE

SHEET	2	OF	39	SHEETS
CONTRACT NO.	PW-6987			
ASSIGNMENT NO.				
DATE	01/24/2018			

W. CHICAGO AVE. 86 FT. WD.