

DATE	REVISIONS
	OLD MAP 3-30-15
	Added Note 'X' 6-12-59 J.E.
	QUANTITY CHANGE FOR ALLEY RETURN REMOVAL SEE SHEET 52 FOR QUANTITIES

ADJUST W. M.H. (RAISE M.N. 10') EA.
REMOVED CONC. MANHOLE TOP 100
PAVING 8" 18" 30 YDS 432' 18"

FILL SAND GRAVEL " 2712' 364'
FULL SAND GRAVEL " 4027'
ARCH CULVERT 24"
18" GUARD RAIL 121'

ESTIMATE

QUANTITIES	LOIS	CITY
EXCAVATION CU. YDS.	761	713
NEW CURB LIN. FT.		105
PAVING 10'-8" 10' SQ. YDS.	4008	369
2" x 10" UNIF. 30 YDS.		498
2" x 10" UNIF. 24 YDS.		318
TEST CORES	5	
SIDEWALK 4" CONC. SQ. FT.	2836	
MANHOLES	1	1
CONSTRUCT CONC. RECONSTRUCT		
ADJUST		
CONSTRUCT		
SEWER-12" LIN. FT.	500	

PETITION NO. FCC	PETITION DATE 6-4-57
ASSIGNMENT NO. 225-CO-2	GROUP NO.
BOOK 935 44	LEVEL 3 24-53
NO. 1696 PG. 30	DATE 10-12-56
LOIS 21 2039.62	LENGTH 1019.81
CITY 21 232.88	LENGTH 116.44
TOTAL 2272.50	LENGTH 1136.25
DATE OF DRAWING	

MADE BY	CHECKED BY
PROFILE	
ESTIMATE	
SEWER APPROVED	
FINAL CHECK	
APPROVED	

58-4	INDEX NO.
77	
117	INDEXED

CONTRACT NO. P.W. 3249 F

STREET PAVING PLAN

CITY OF DETROIT

DEPARTMENT OF PUBLIC WORKS - CITY ENGINEERS OFFICE

NAME OF STREET **WEST PARKWAY**

FROM **959.21' S. OF S.L. CHICAGO**

TO **33 N. OF S.L. CHICAGO**

TYPE OF PAVEMENT **10'-8-10 ONE COURSE CONCRETE INTEGRAL CURB**

10' UNIFORM AT STREET INTERSECTION EXCEPT AS NOTED

FORCED COMMON COUNCIL **6-4-57**

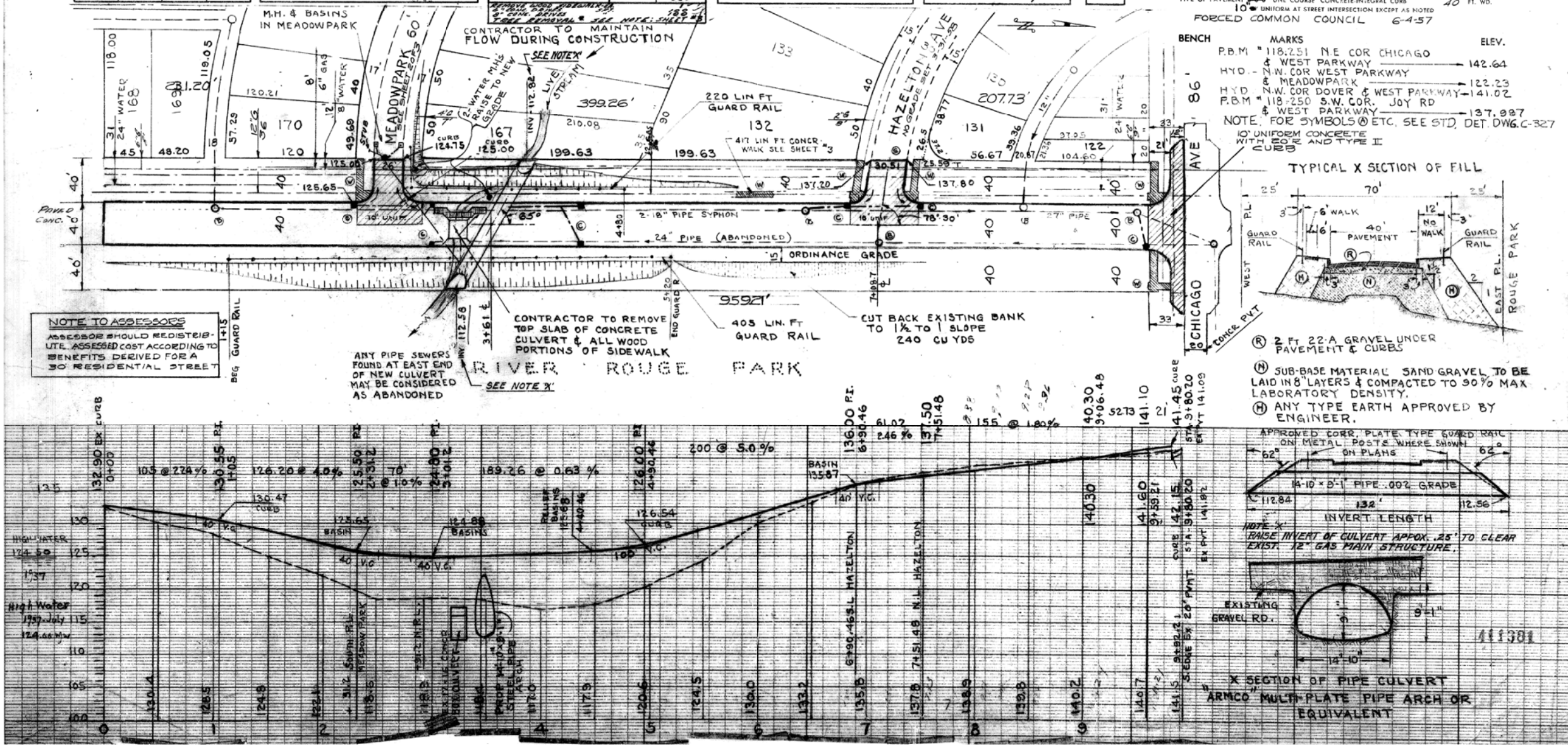

EXISTING

FOR INFORMATION ONLY

DO NOT WORK FROM THIS SHEET. THE INFORMATION SHOWN HERE IS FOR REFERENCE ONLY. NO PAY ITEMS ARE SHOWN.