

BENCH MARKS ELEV

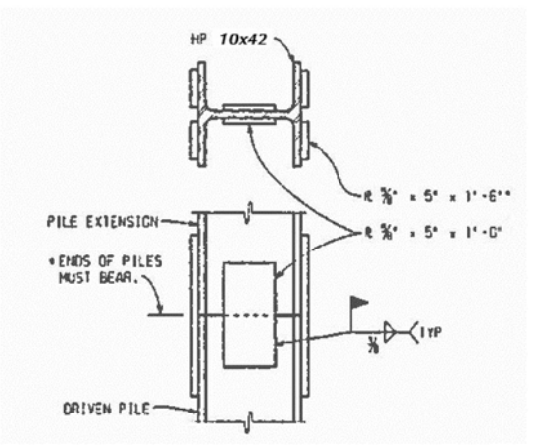
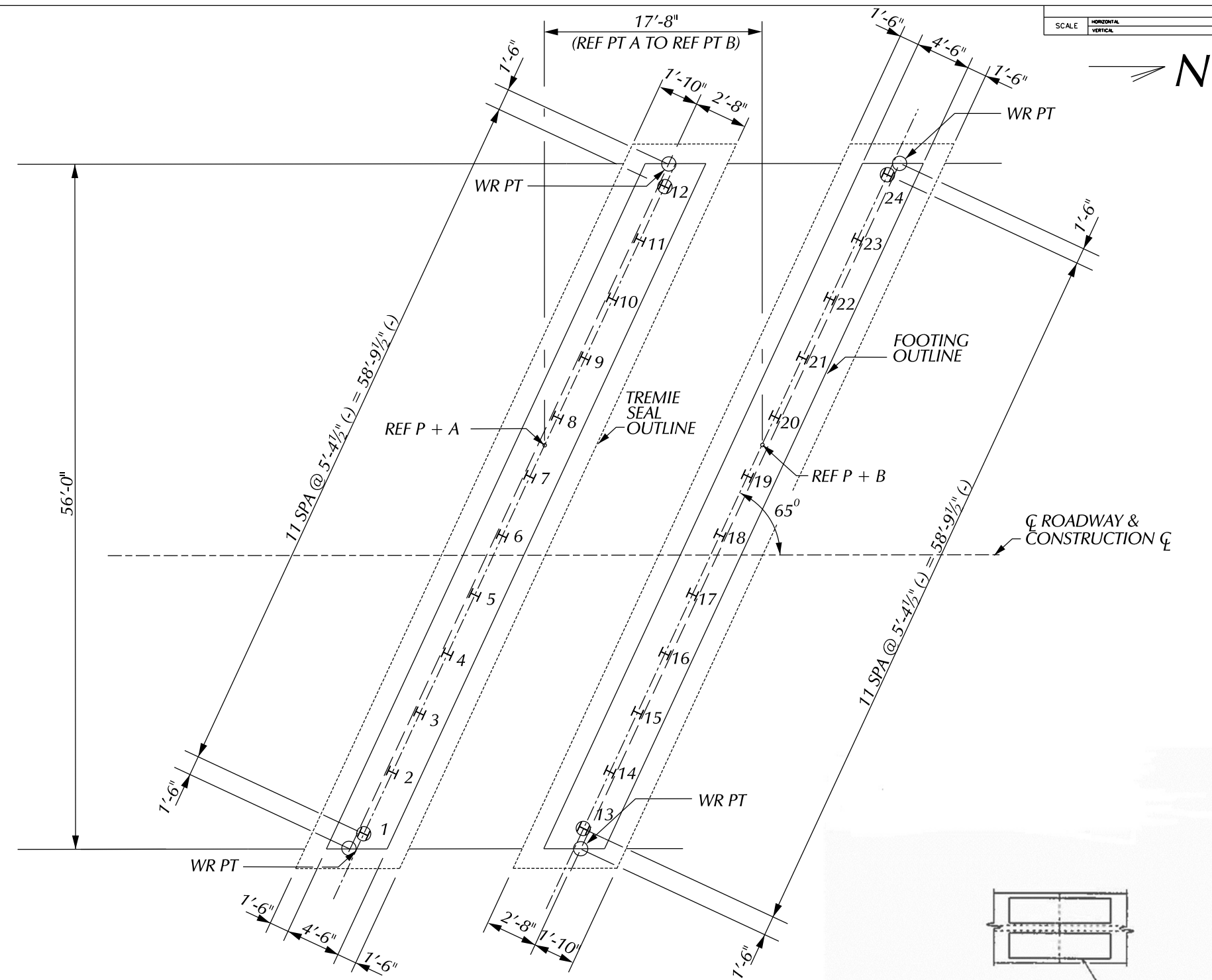

**SPlice DETAILS**

\* SET PILE EXTENSION IN PLACE WITH SPlice PLATES ATTACHED. TAP SEVERAL TIMES WITH THE HAMMER TO IMPROVE BEARING CONTACT, THEN COMPLETE WELDING OF PLATES TO THE LOWER SECTION.

55 TON STEEL "H" PILES					
LOCATION	PILE TYPE	NUMBER OF PILES	ESTIMATED LENGTH FURNISHED & DRIVEN EACH LFT	TOTAL LFT	CUT-OFF ELEV.
FTG A	TEST	2	50	100	669.00
	VERTICAL	22	40	720	669.00
FTG B	TEST	2	50	100	669.00
	VERTICAL	22	40	720	669.00
TOTAL				1640	

**MISCELLANEOUS QUANTITIES**

1 LS	PILE DRIVING EQUIPMENT, FURN
1640 FT	PILE STEEL, FURN AND DRIVEN, 10 INCH
4 EA	TEST PILE STEEL 10 INCH

**NOTES:**

- H - DENOTES VERTICAL PILES.
- (H) - DENOTES VERTICAL TEST PILES.
- ALL PILES SHALL BE DRIVEN TO A MINIMUM BEARING CAPACITY OF 55 TONS.
- STEEL PILES SHALL BE HP 10 X 42.
- ESTIMATED PILE PENETRATIONS HAVE BEEN DETERMINED BY USE OF THE STATIC FORMULA.
- THE PILE DRIVING FORMULAS IN THE STANDARD SPECIFICATIONS ARE NOT TO BE USED TO DETERMINE BATTERED PILE CAPACITY. BATTERED PILES ARE TO BE DRIVEN TO THE ELEVATION ESTABLISHED FOR VERTICAL FILES.
- THE USE OF VIBRATORY HAMMERS FOR INSTALLING H-PILES SHALL NOT BE ALLOWED.

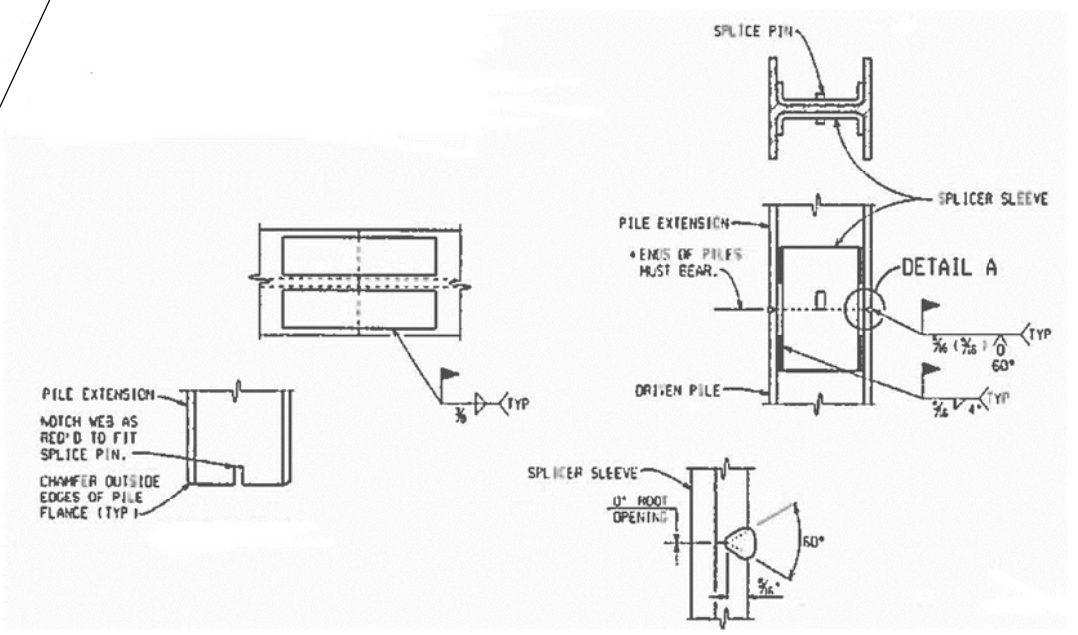

NOTCH DETAIL

DETAIL A

**ALTERNATE SPlice DETAILS**

\* SET PILE EXTENSION IN PLACE WITH SPlice PLATES ATTACHED. TAP SEVERAL TIMES WITH THE HAMMER TO IMPROVE BEARING CONTACT, THEN COMPLETE WELDING OF PLATES TO THE LOWER SECTION.

PLAN	BY	CHECKED BY	APPROVED
GRADE			
ESTIMATE			
REVISIONS	DR	CHK	DATE
	FINAL	****	****

CITY OF DETROIT  
CITY ENGINEERING DIVISION - D.P.W.  
BUREAUS OF STREETS AND HIGHWAYS  
FOR

**WEST PARKWAY CULVERT OVER ROUGE RIVER**

**CULVERT H PILE DETAILS**

SHEET	OF	SHEETS
CONTRACT		
NO.		
ASSIGNMENT		
NO.		
DATE		