

1-BP 10/24/67

**STEEL REINFORCEMENT BAR LIST**

Location	Mark	Size	No.	Dimensions	Length	Weight
				a b c d		
Footings	A1	1/4"	32	5'-6"		5'-6"
Footings and Abutment	A2	3/8"	68	22'-0"		22'-0"
Slab	A3	3/8"	6	34'-3"		34'-3"
Slab and beam encasing	A4	3/8"	59	38'-2"		38'-2"
Existing beam encasing	A5	3/8"	4	33'-8"		33'-8"
End beam of slab	A6	3/8"	8	22'-4"		22'-4"
do	A7	3/8"	16	4'-6"		4'-6"
Existing beam encasing	D1	1/4"	70	2'-11"		1'-3"
Abutment walls	E1	1/4"	124	9'-8"	6"	4 1/2"
Slab	F1	3/8"	60	23'-4"	4"	3 1/2"
Footings	G1	1/4"	124	3'-1"	6"	4 1/2"
Slab	HA1	3/8"	30	22'-0"	1'-0"	4"
Beam encasing	HA2	1/4"	150	1'-3"	1 1/2"	3"
Slab	HB1	3/8"	30	23'-8"	9"	4"
End beam of slab	HB2	1/4"	44	1'-0"	1'-0"	3"

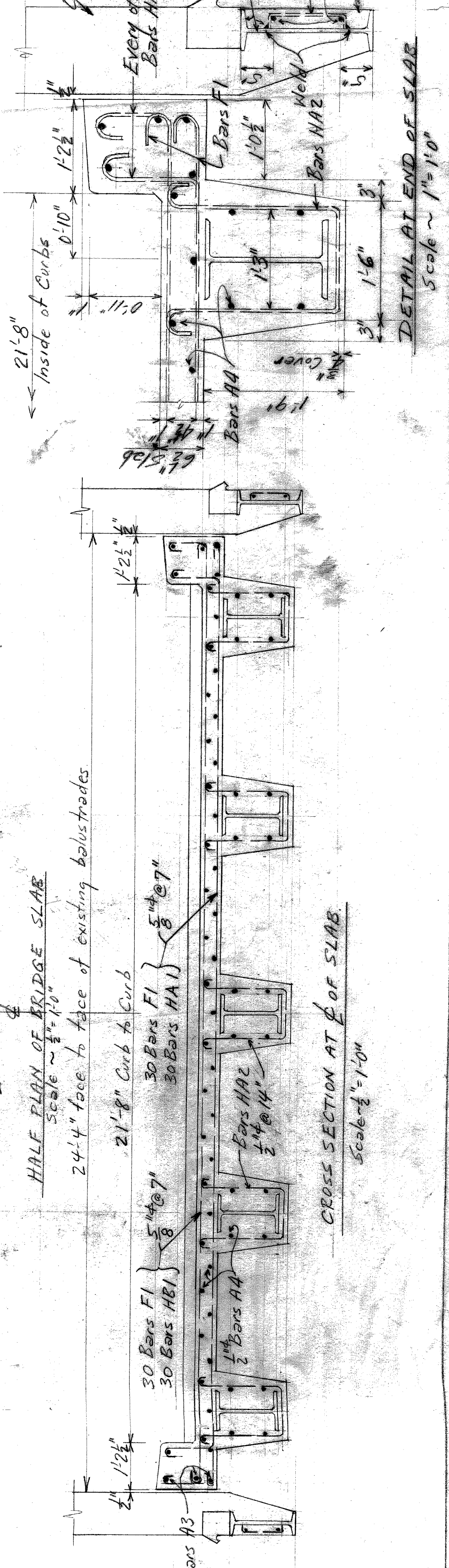
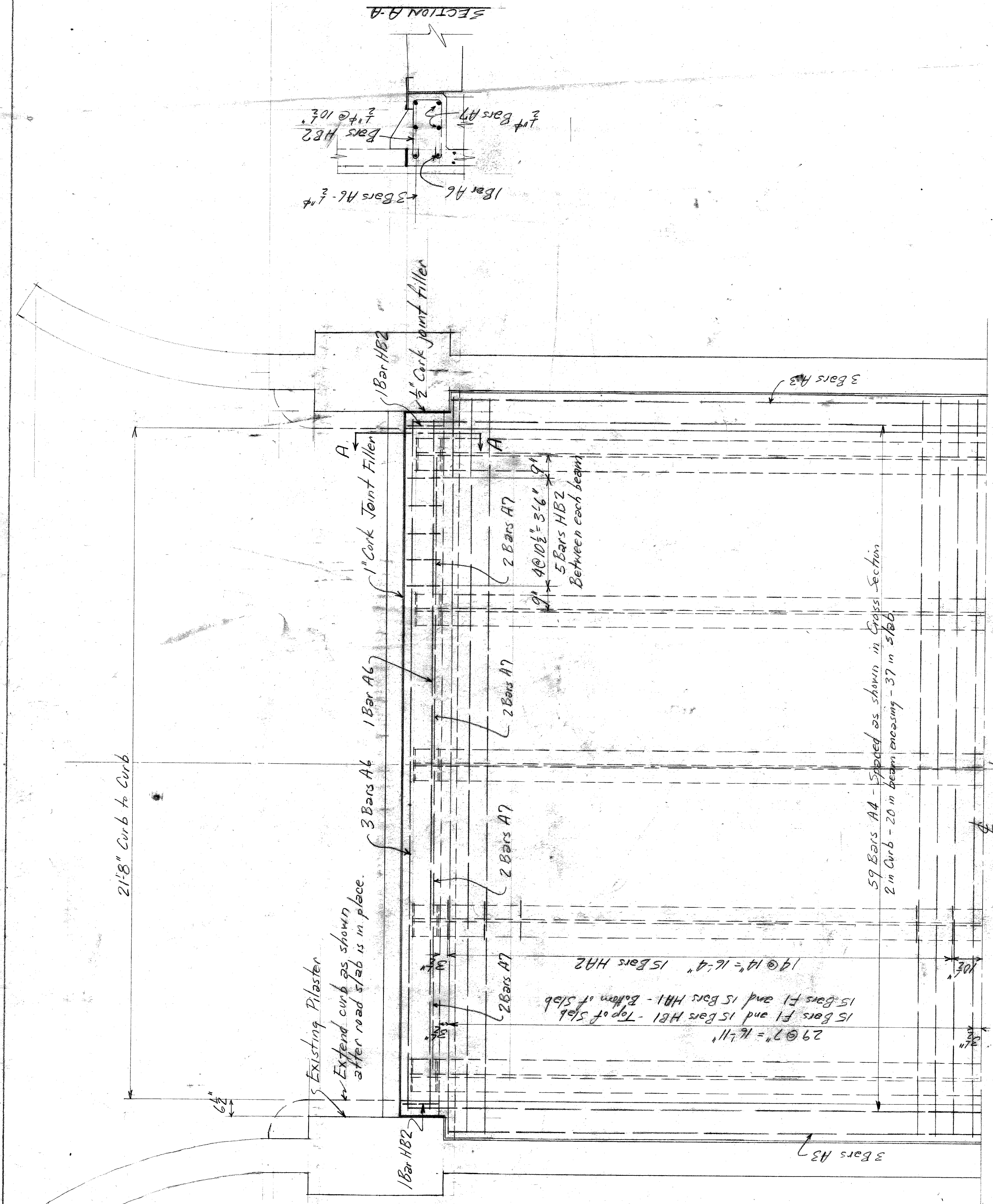
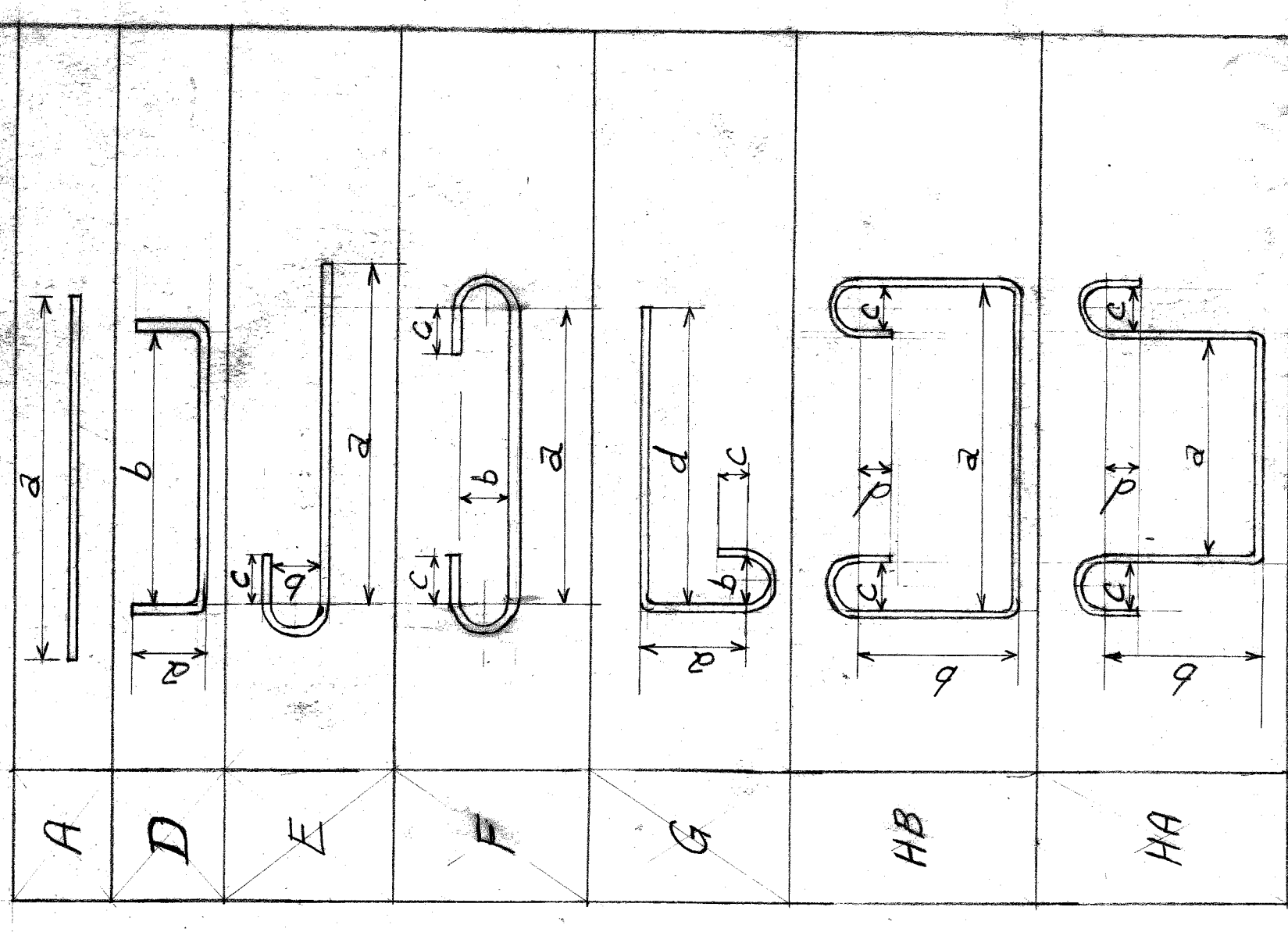

In office only  
 A.P. 69  
 Bridge No. 11  
 B.I. 19  
 Draw 4  
 10/24/67

DW 211-1



BW211-2

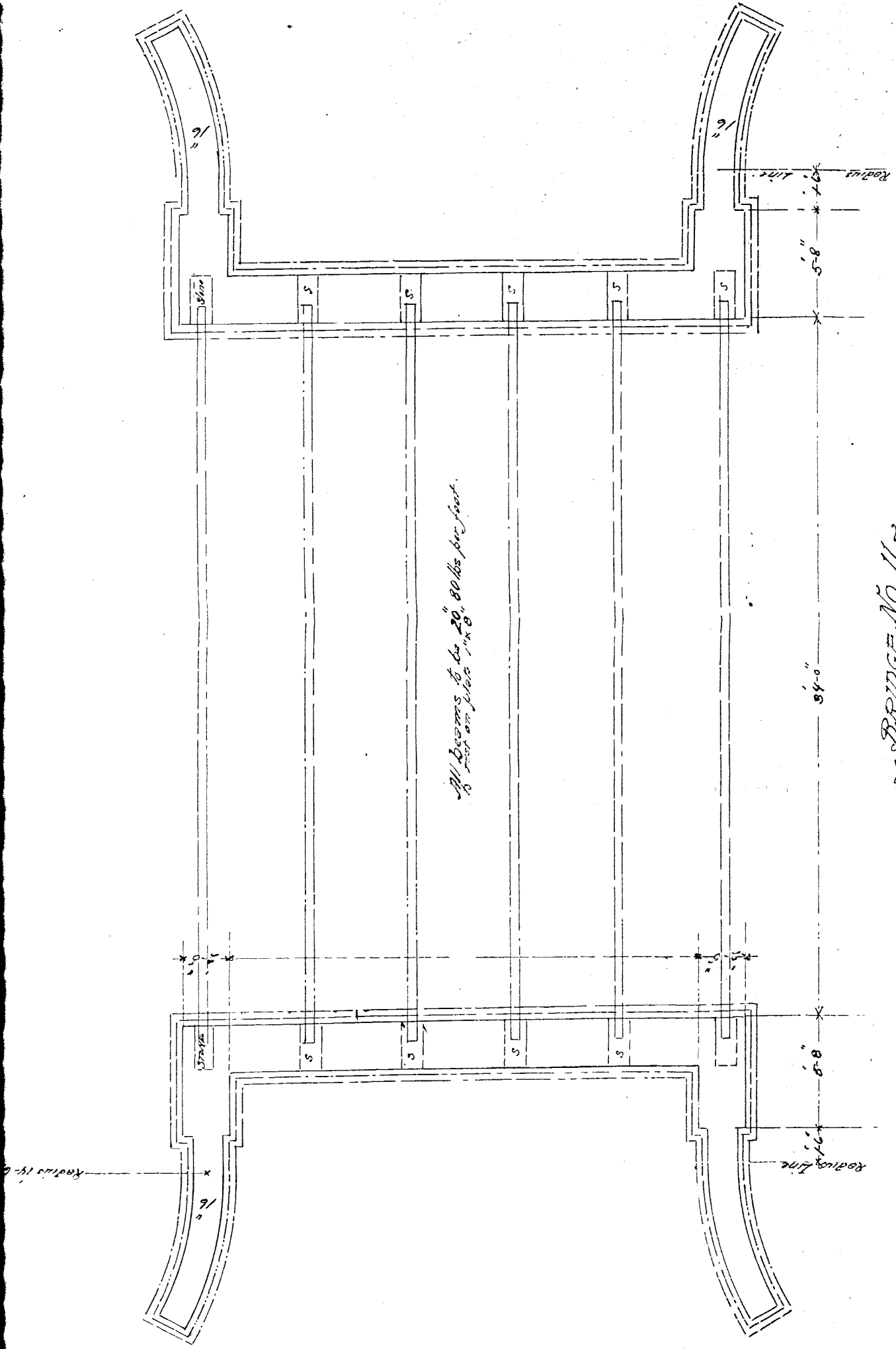

All Beams to be 20" 80 lbs per foot.

BRIDGE NO. 112  
FOUNDATION PLAN  
SCALE: 1/4" = 1'-0"

Bwall-3

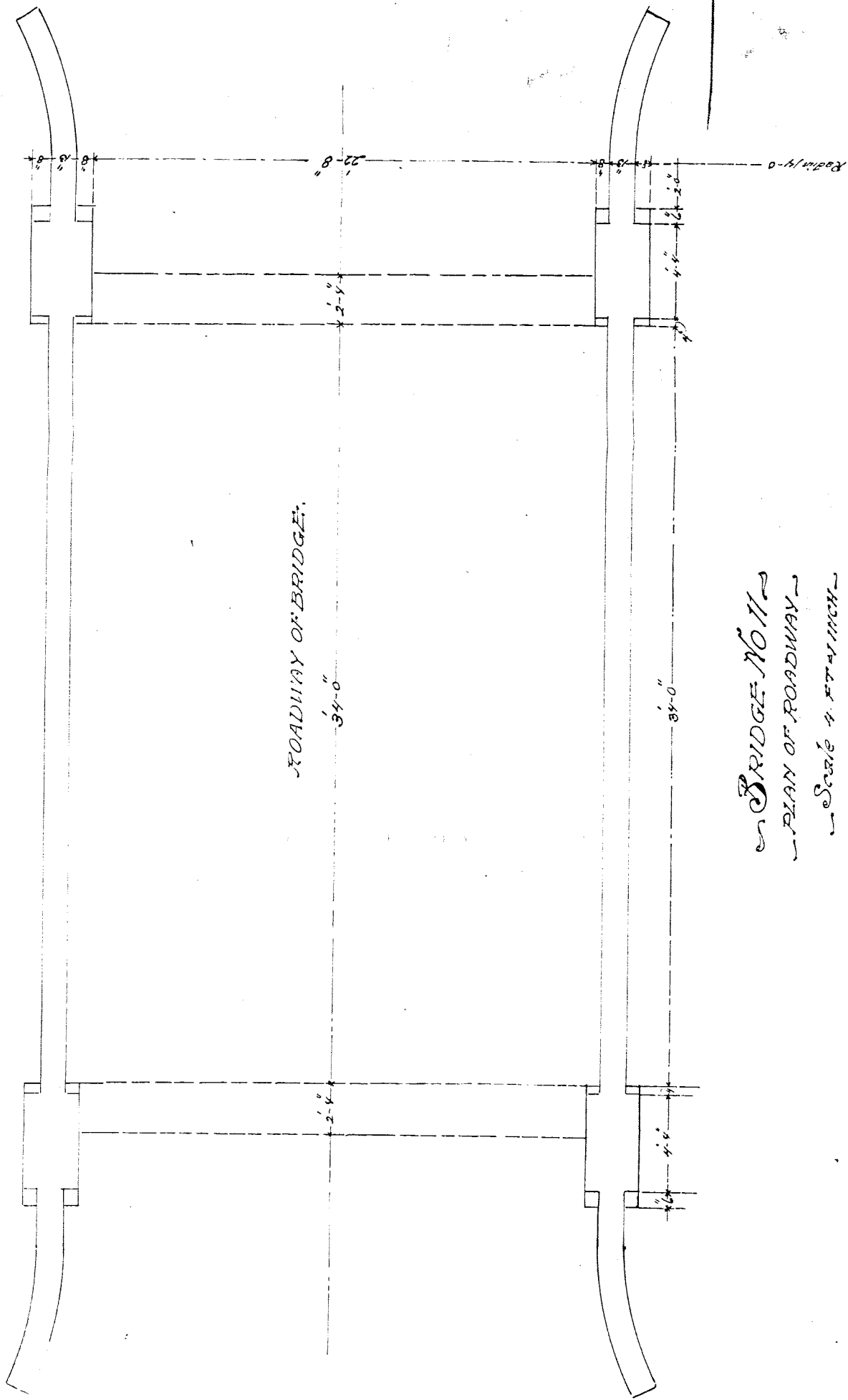

ROADWAY OF BRIDGE.

BRIDGE No 11

PLAN OF ROADWAY

Scale 1/4" = 1' INCH

BW 211-4

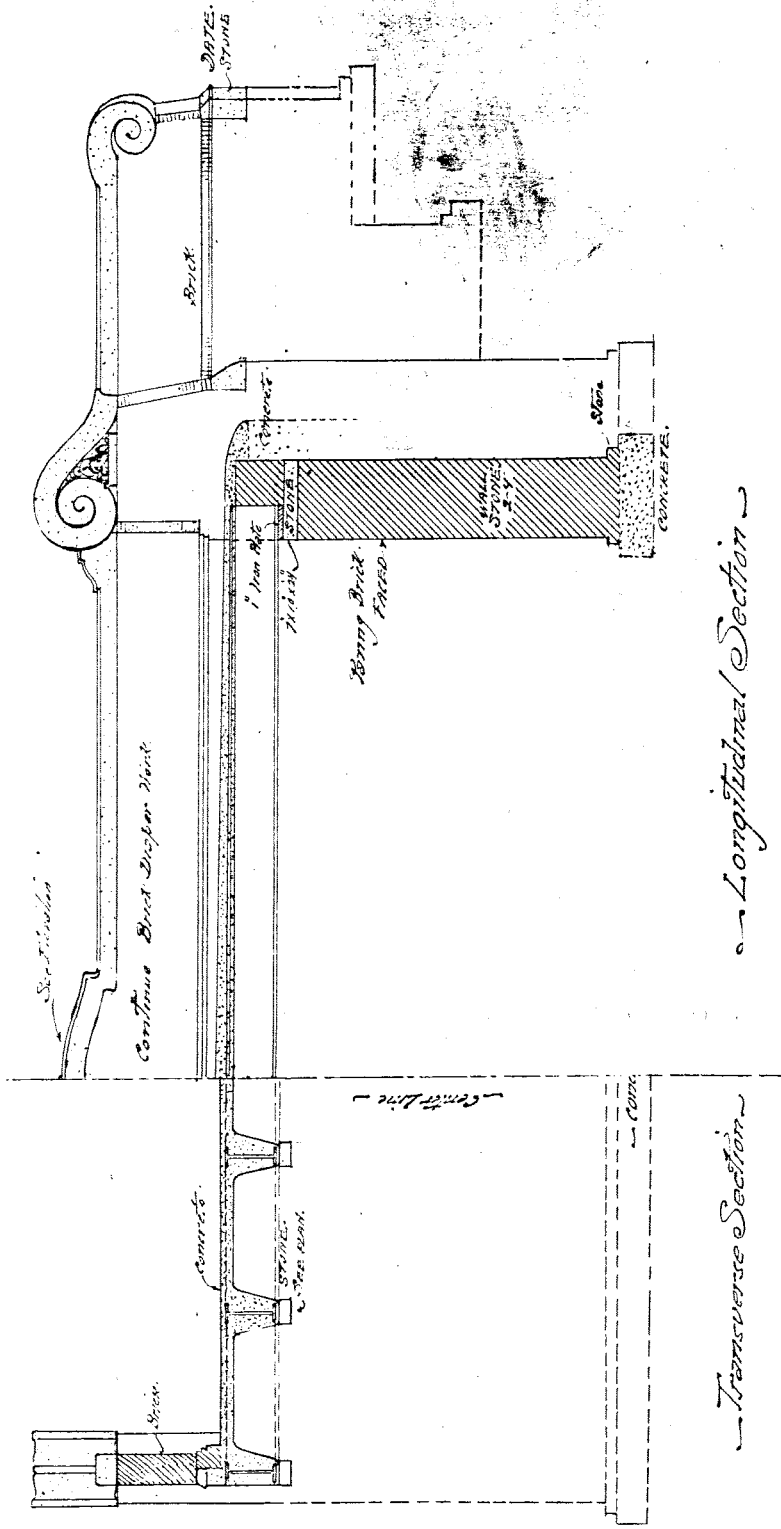

Longitudinal Section

Transverse Section

BRIDGE NO 11

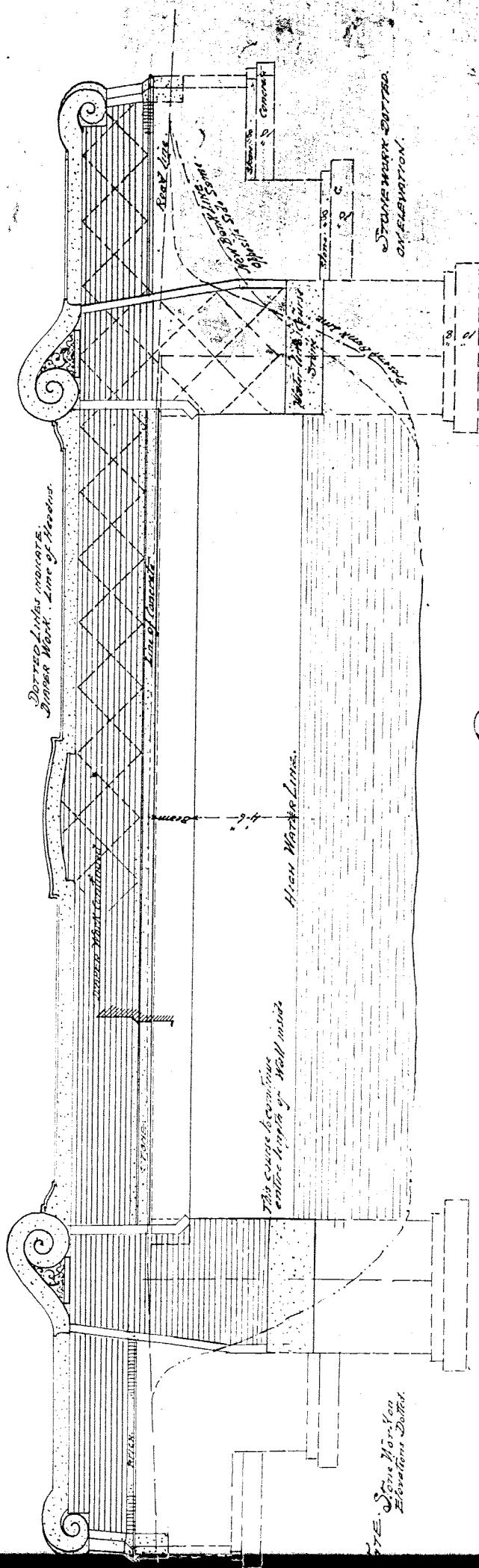

*Elevation Bridge No. 11*

*For exact lengths & other measurement See the plan.*

*Scale 1/4" = 1' max.*

*Fred J. Schilling  
ARCHITECT.  
DETROIT, MICH.*

*NOTE: Stone Masonry Elevations Detail.*

BW 2/1-5

121

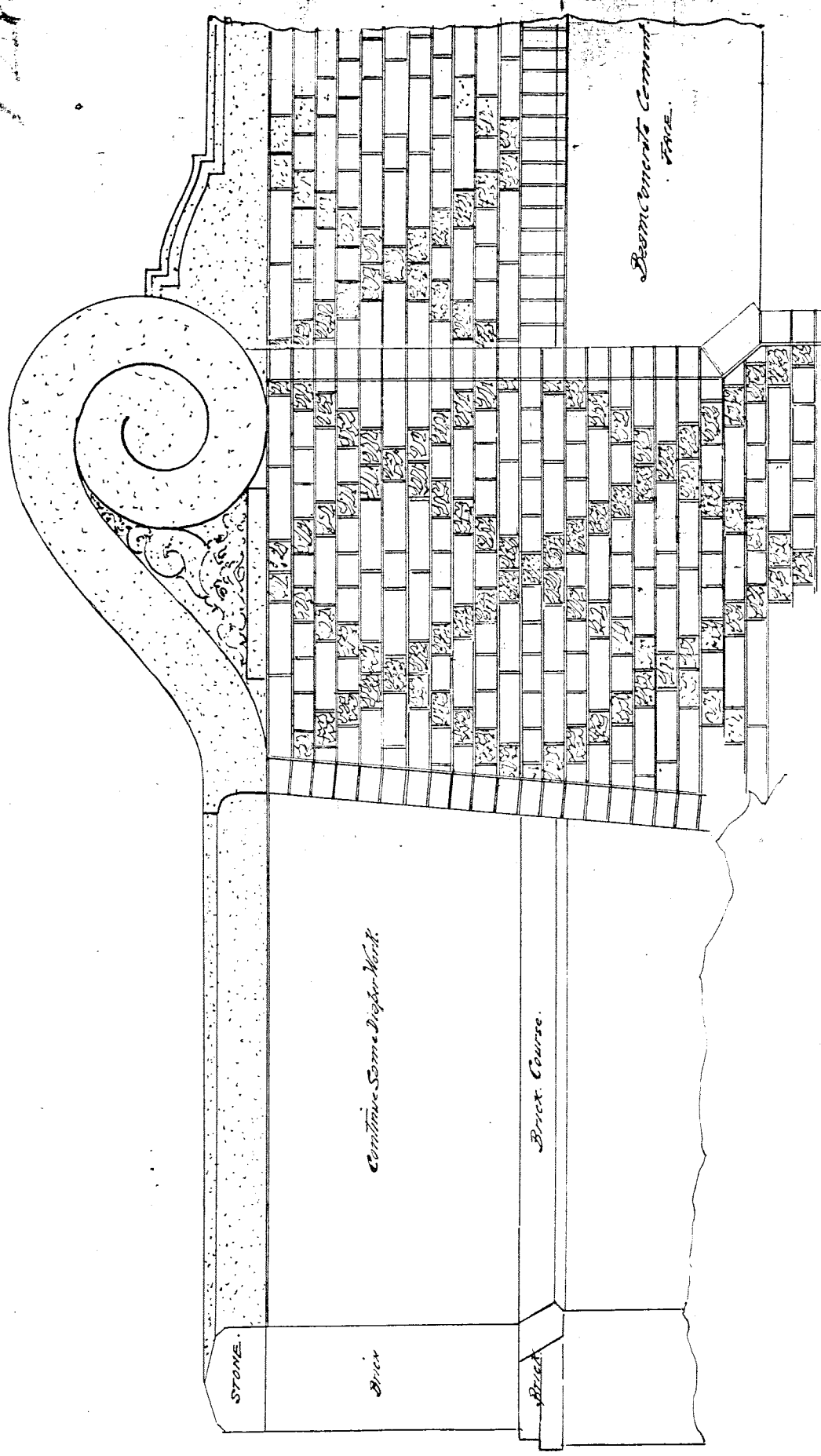
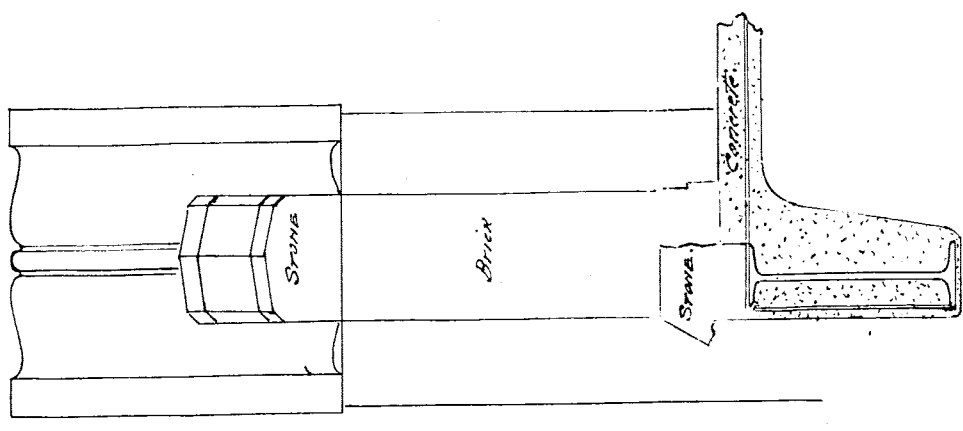

SECTION. SCALE. 1. INCH.

DETAIL SHOWING POST.

SCALE. 1:1/4" = 1. FOOT.

Approved by Commissioner  
 August 1901  
 M. P. Hurlbut  
 Secy

Edw. H. Schilling  
 Architect.  
 Detroit Mich.

# 1

FOLDER 31

BW 211-6