

OPENING OF SCHOOLCRAFT AVE (RDS. 21-29)
FROM GREENFIELD TO BEECH RD.
H. WILLMARTH & DAVID LYON, BEDFORD HWY. COMMS.
APRIL 4, 1835.

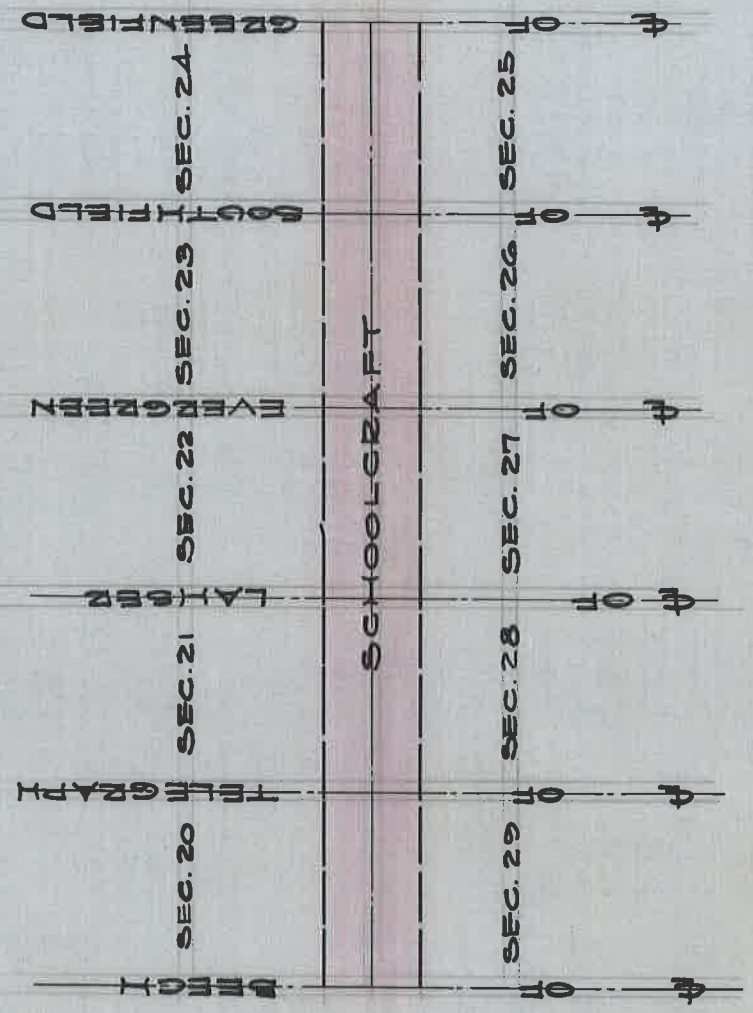

DEPARTMENT OF PUBLIC WORKS
CITY ENGINEER'S OFFICE
412 CITY HALL
SCALE 1" = 80' SCALE
G.F.C.