

TRIANGULAR PORTION OF LAND FOR SCHOOLCRAFT AVE.,  
FROM LAMPHERE AVE. TO 396 FT. EAST  
PURCHASED FROM LEMAN CANFIELD APRIL 5, 1861

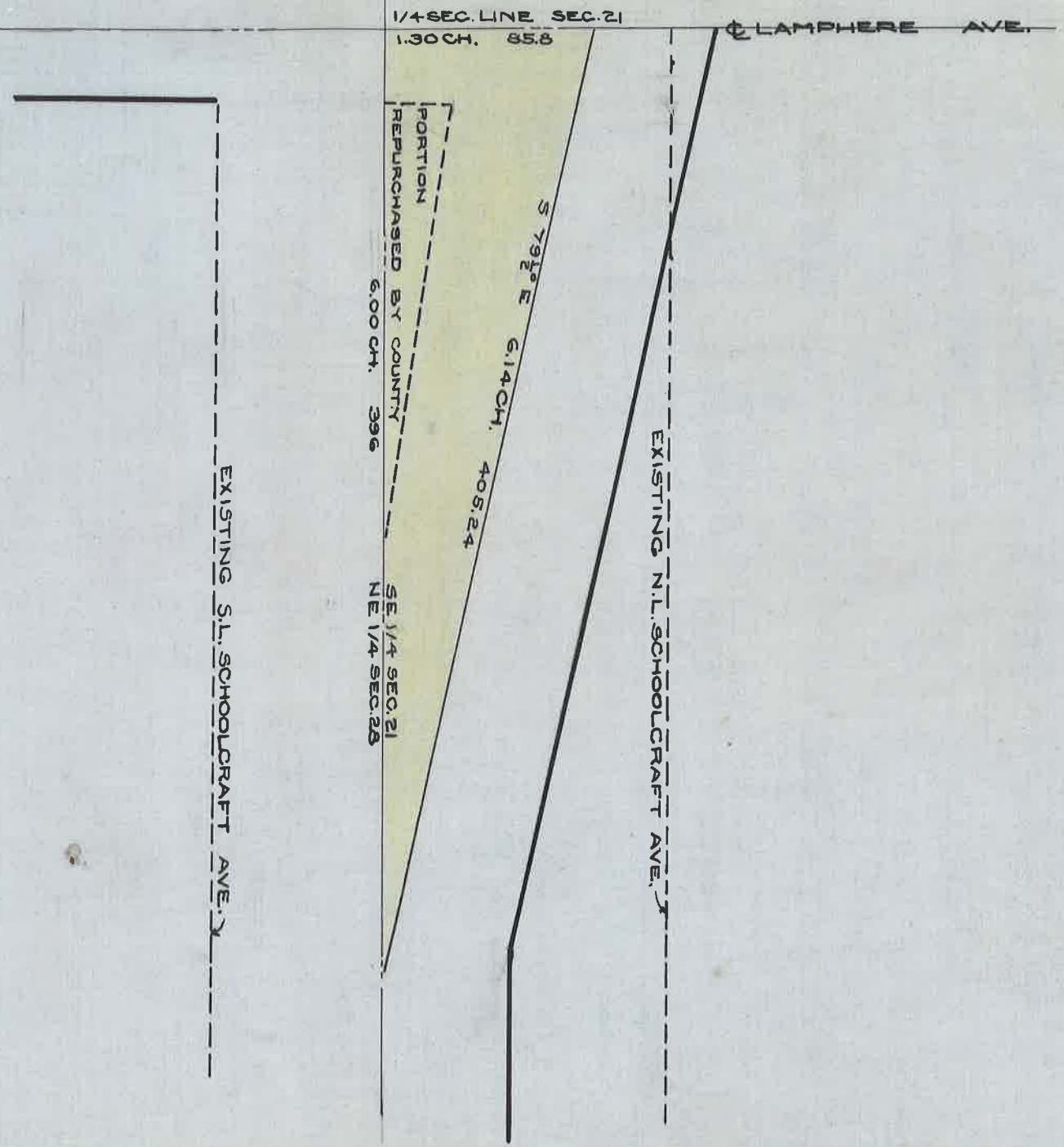

ST. OPS. BK. 6 - PG. 148  
A.P.M.

DEPARTMENT OF PUBLIC WORKS  
CITY ENGINEER'S OFFICE  
412 CITY HALL

SCALE 1" = 1 CHAIN  
10-17-30

A.F.