

**OPENING OF BURT RD. FROM PLYMOUTH TO SCHOOLCRAFT
VACATION OF AN ANGLING RD. WEST OF BURT RD.**

TOBIN HAWK & JESSE ZIEP REDFORD TWP. HWY COMMS. NOV. 24, 1848.

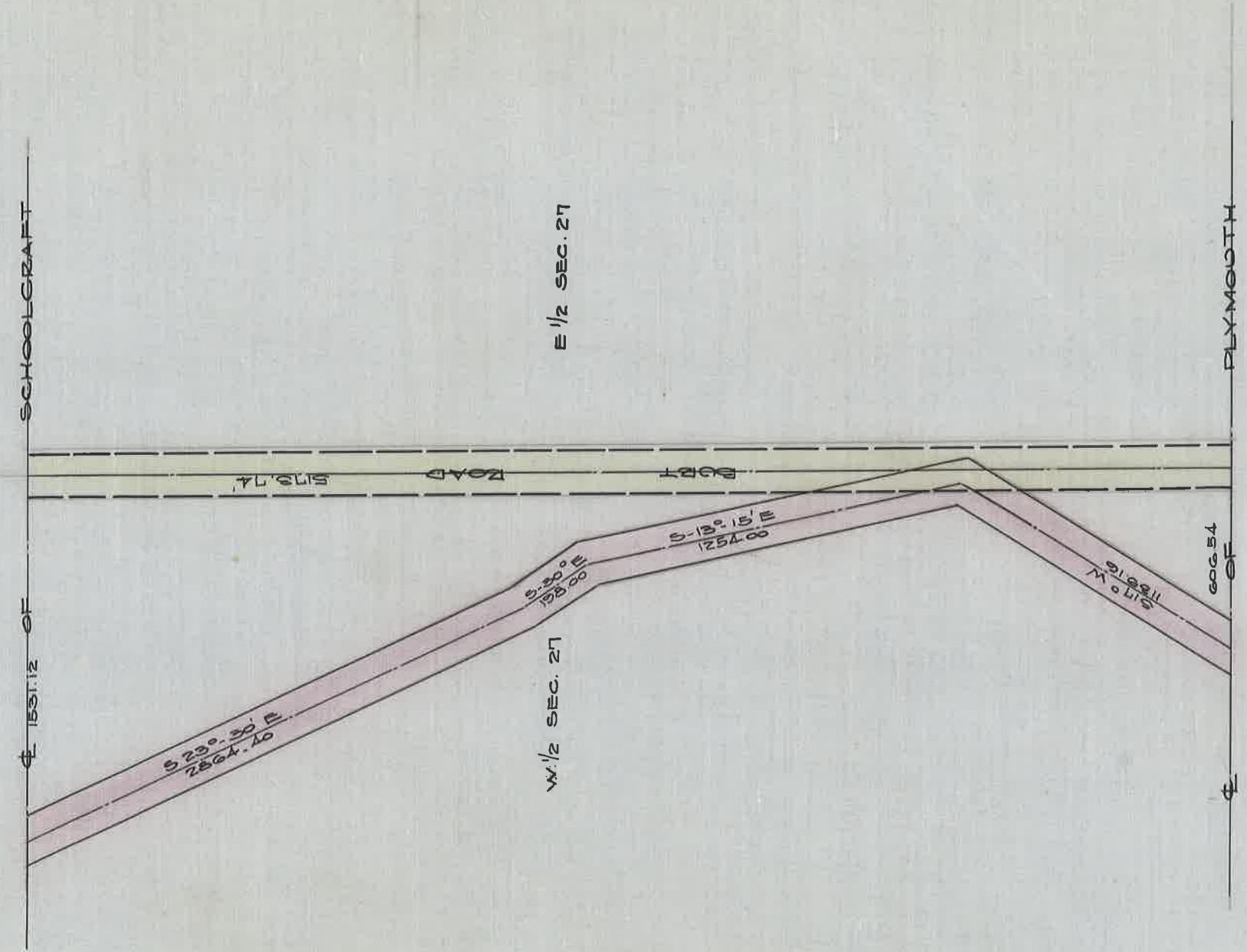

DEPARTMENT OF PUBLIC WORKS
 CITY ENGINEER'S OFFICE
 412 CITY HALL
 SCALE 1" = 40' SCALE
 G.F.C.