

**DEED OF ROAD ACROSS RIVER ROUGE
(ABOUT 3RD. WD. NON EXISTENT)**

§ TO 10 RDS. S. OF SEC. LINE BETWEEN SEC. 33 T.1 S.R.10E & SEC. 4 T.2 S.R.10E
DEEDED BY MARIE MARGUERITE GENEY NOV. 9, 1867.
SEE Pgs. 215 REDFORD TWP. 50 PROC. 1918 TO 1923 JUNE. 19. 1920.

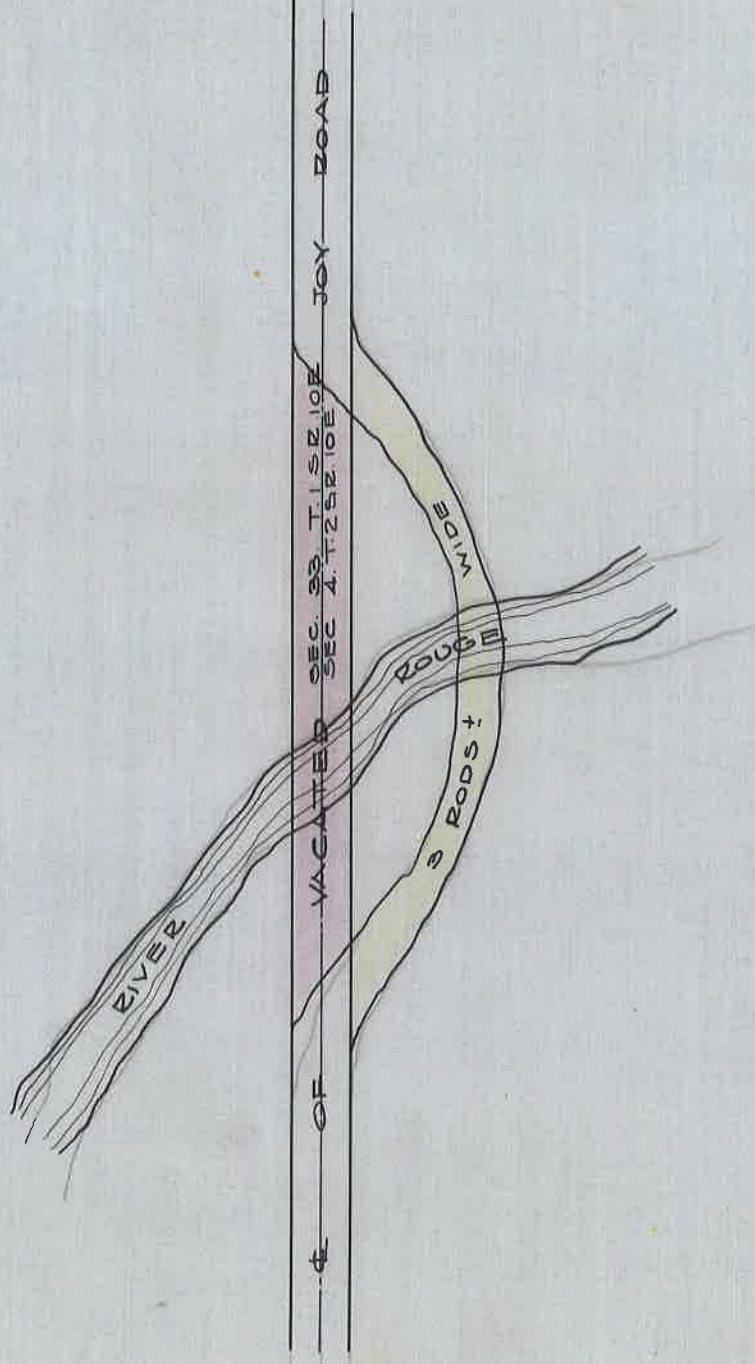

DEPARTMENT OF PUBLIC WORKS
CITY ENGINEER'S OFFICE
412 CITY HALL

SCALE 1"=100 SCALE

S.F.C.