

**SURVEY OF EVERGREEN AVE**

FROM SIX MILE ROAD TO SEVEN MILE ROAD

MADE BY A.T. SULLIVAN

FEB. 1, 1856.

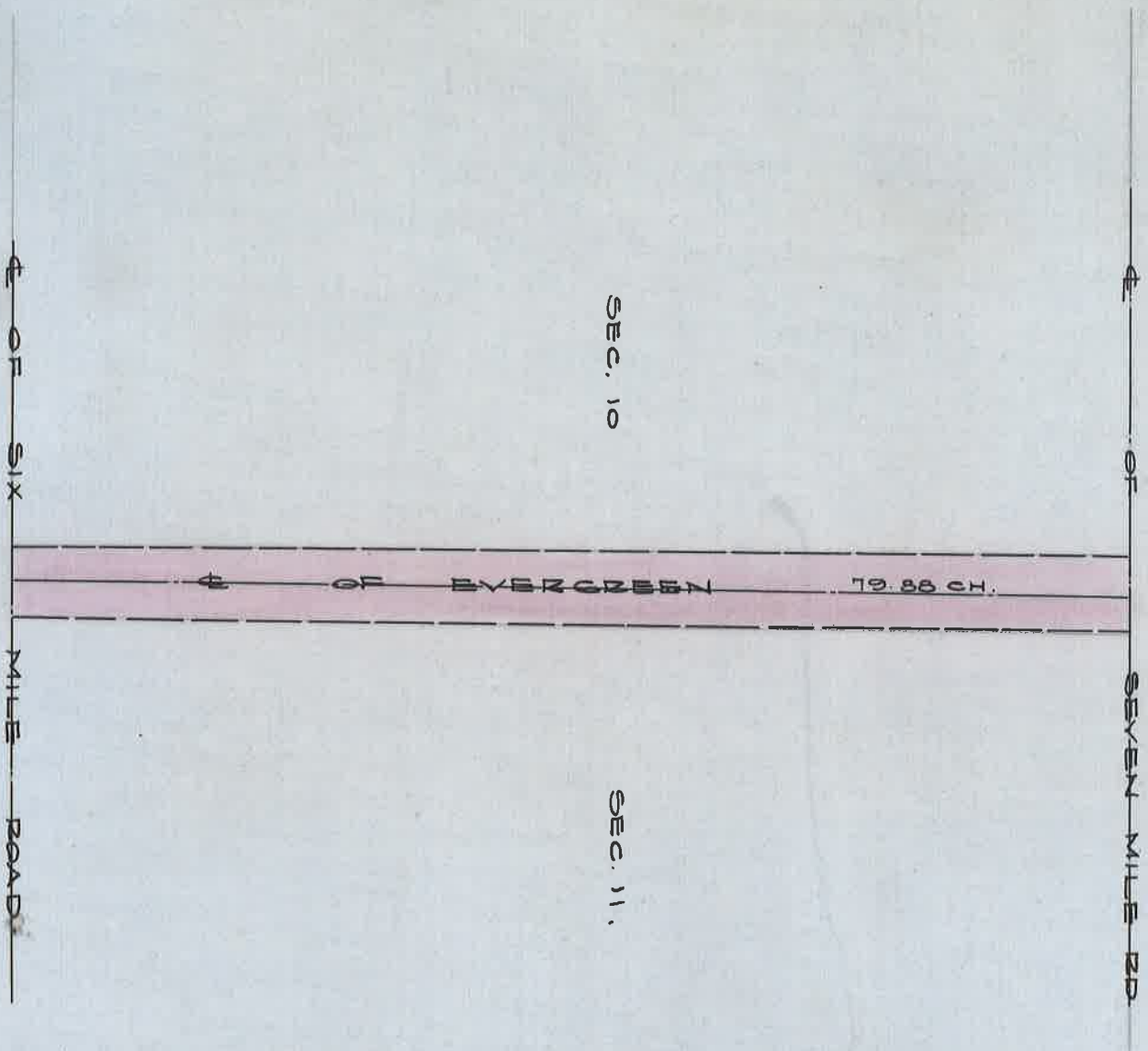

DEPARTMENT OF PUBLIC WORKS  
CITY ENGINEER'S OFFICE  
412 CITY HALL  
SCALE 1"=40 FEET