

# DEDICATION OF PLYMOUTH AVE.

BEING N. 33' OF SEC. 31. & S. 33' OF SEC. 30. [4 BODS]

DEEDED FEB. 6, 1915 TO GREENFIELD TOWNSHIP.

PG. 140 <sup>147</sup> HWY. COM. RECORDS OF 8-9-06 TO 1-22-24.

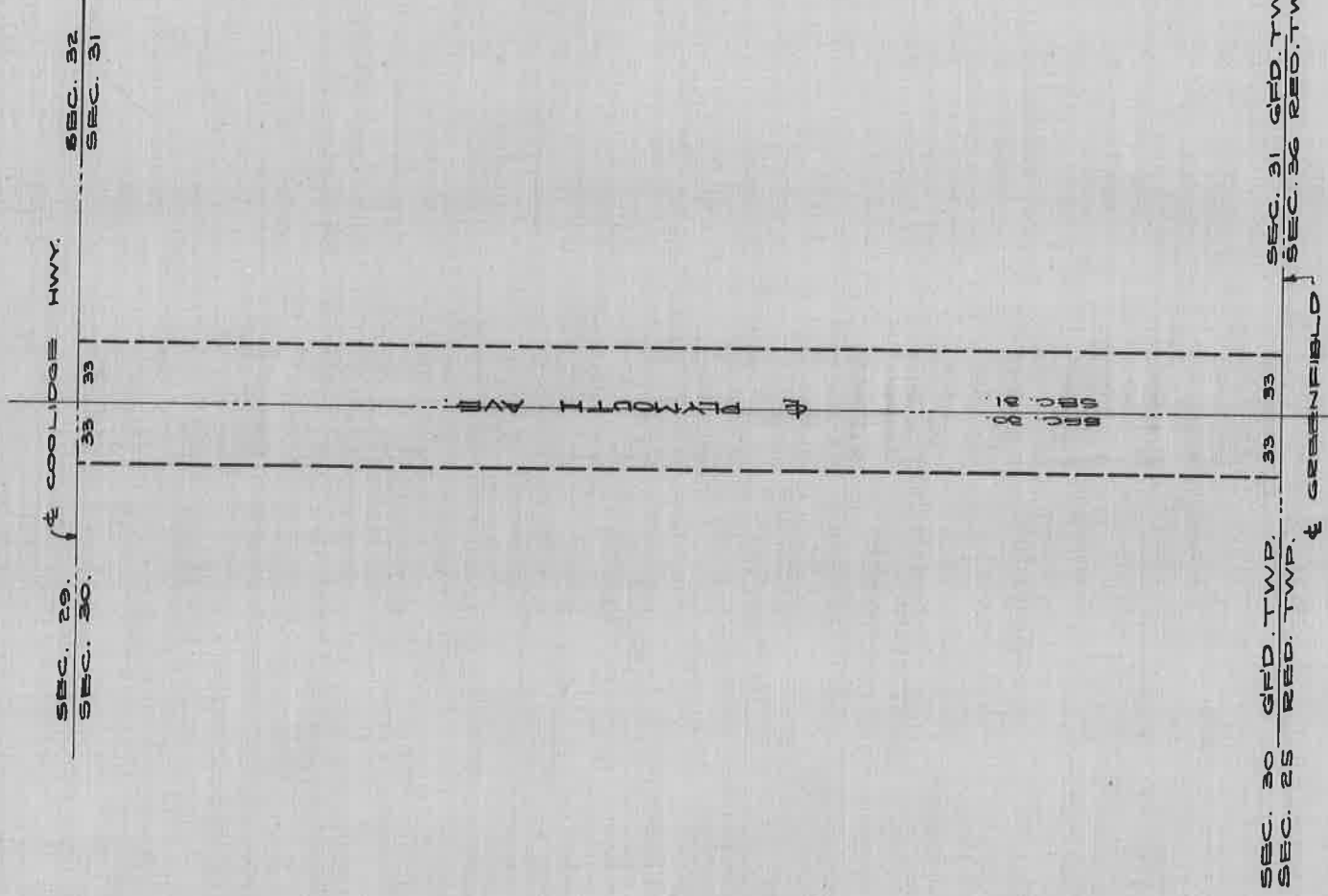

DEPARTMENT OF PUBLIC WORKS  
CITY ENGINEER'S OFFICE  
401 CITY HALL

SCALE 1" = 100' 12-28-27

EA.

33