

Transfer of Relocated Streets and Service Drives
Adjacent to Michigan Route 10
In the City of Detroit

WHEREAS, the State Transportation Commission has determined that the public interest will best be served if the following described relocated streets and service drives, having been constructed, be transferred to the city of Detroit.

- #1 Commencing on the north side of M-10, at the center of Wyoming Avenue (Station 357+23.40); thence easterly to a point west of Ohio Street at Station 369+23.

(0.227 Miles - Approximately)

- #2 Commencing on the north side of M-10, at the center of Kentucky Street (Station 9+80); thence easterly to the center of an alley (Station 11+96).

(0.041 Miles - Approximately)

- #3 Commencing on the north side of M-10, east of Monica Street at Station 402+50; thence easterly to a point west of Dexter Street at Station 420+00.

(0.331 Miles - Approximately)

- #4 Commencing on the north side of M-10, at the center of Stoepel Street (Station 406+95); thence easterly to the center of an alley (Station 408+80).

(0.035 Miles - Approximately)

- #5 Commencing on the north side of M-10, at the center of the north service drive (Station 0+50), thence northwesterly to existing Quincy Street at Station 2+10.

(0.030 Miles - Approximately)

- #6 Commencing on the south side of M-10, at the center of the south service drive west of Livernois Avenue at Station 98+59.58; thence northerly crossing M-10 to the center of the north service drive west of Livernois Avenue at Station 101+43.36.

(0.054 Miles - Approximately)

- #7 Commencing on the south side of M-10, west of Monica Street at Station 400+75; thence easterly to the center of Livernois Avenue (Station 410+26.22).

(0.180 Miles - Approximately)

#8 Commencing on the north side of M-10, southeast of Ford Street at Station 491+16.21; thence southeasterly to the Detroit - Highland Park city limits at Station 500+00.

(0.167 Miles - Approximately)

#9 Commencing on the east side of M-10 at the center of Lawrence Street (Station 551+41); thence southerly to a point south of Collingwood Street at Station 555+13.

(0.070 Miles - Approximately)

NOW, THEREFORE, in conformance with existing laws, and in accordance with the agreements covering relocated streets and roads related to the reconstruction of M-10, said streets and roads are hereby transferred to the jurisdiction of the city of Detroit.

The transfer shall be effective July 1, 1988

MICHIGAN DEPARTMENT OF TRANSPORTATION

James P. Pitz, Director

TRANSFER OF RELOCATED STREET AND SERVICE DRIVE ADJACENT TO M-10 IN THE CITY OF DETROIT

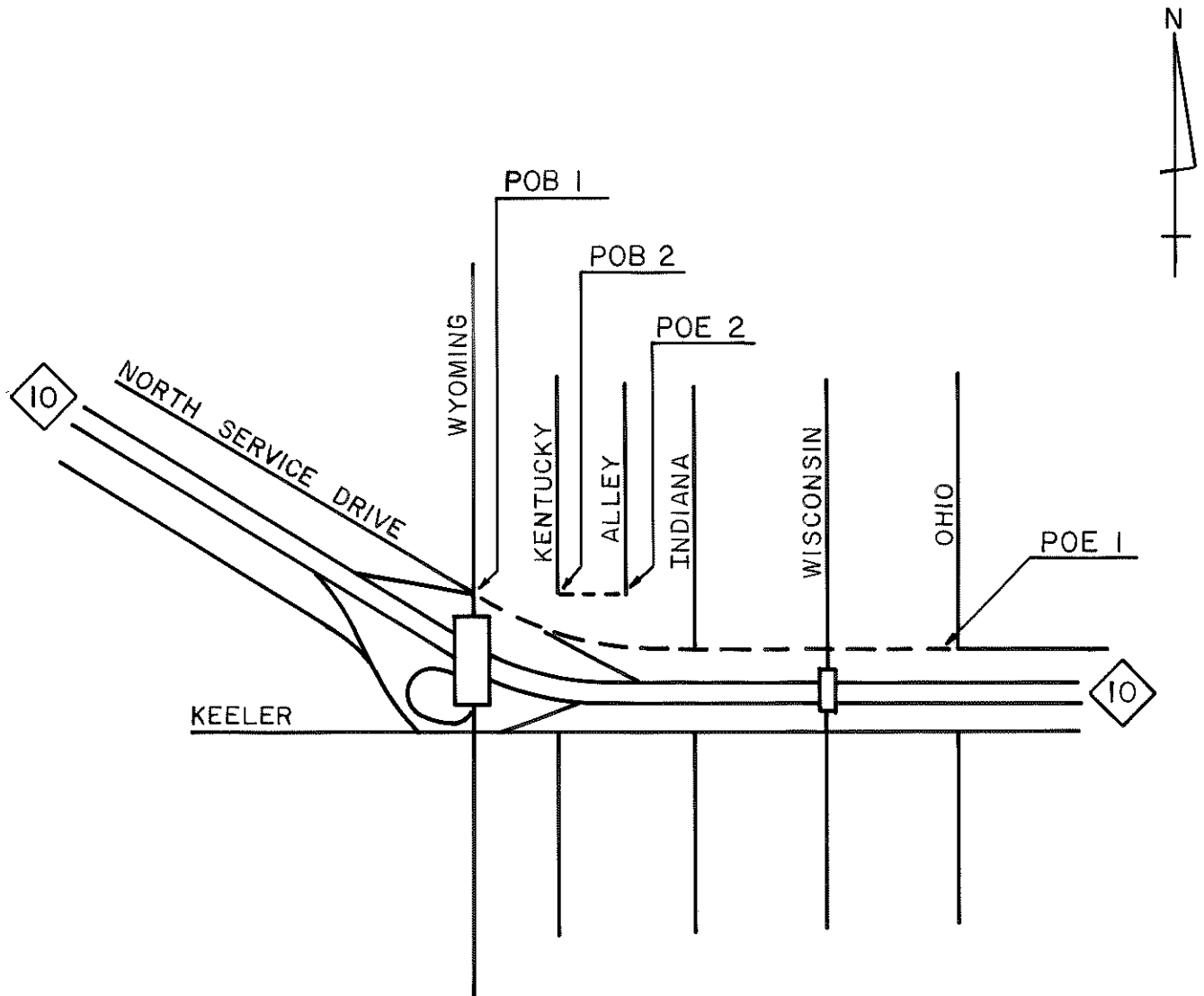

The transfer shall be effective
July 1, 1988



James P. Pitz
James P. Pitz, Director
Department of Transportation

TRANSFER OF RELOCATED STREETS AND SERVICE DRIVES ADJACENT TO M-10 IN THE CITY OF DETROIT

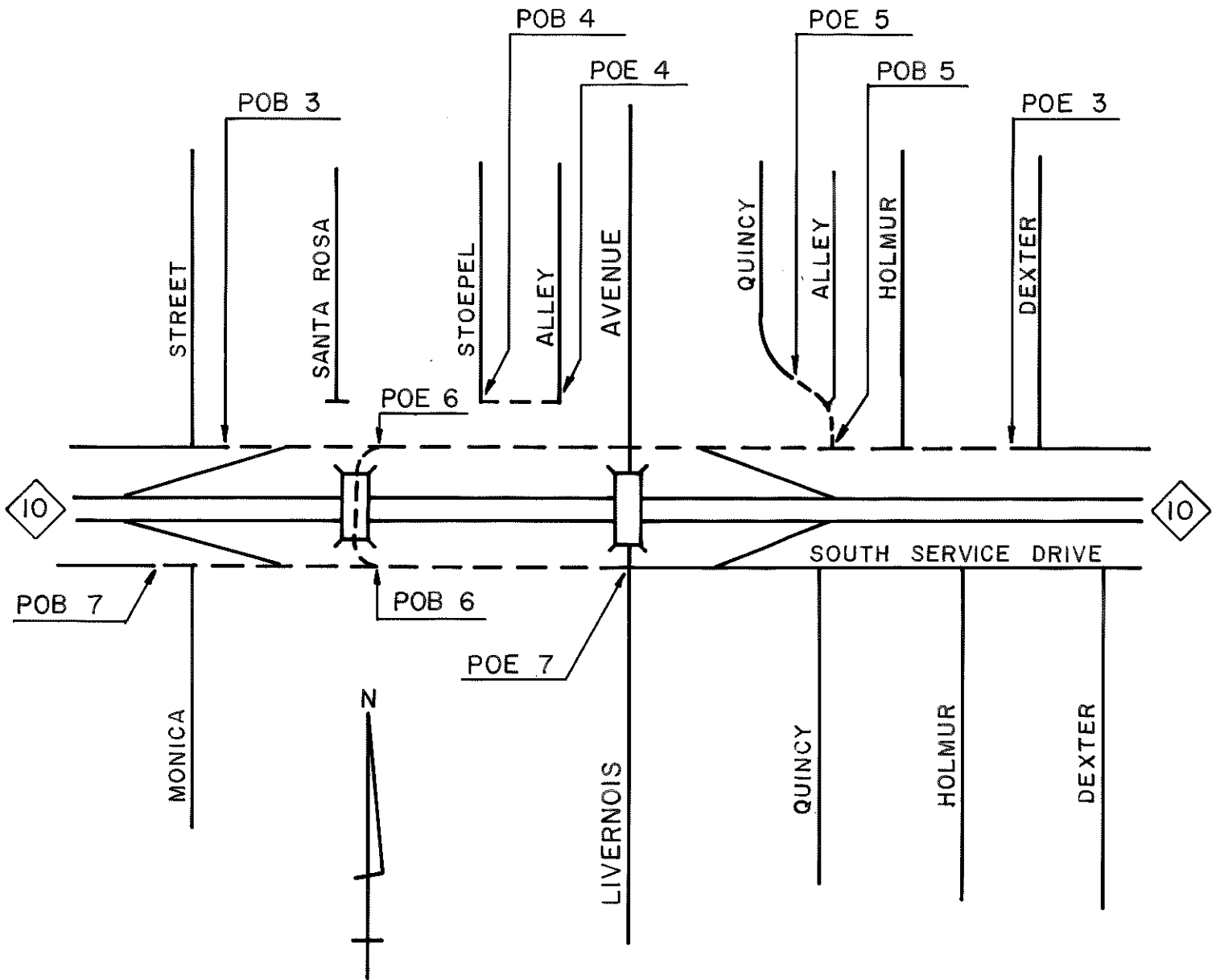

The transfer shall be effective
July 1, 1988



 James P. Pitz, Director
 Department of Transportation

TRANSFER OF SERVICE DRIVE ADJACENT TO M-10 IN THE CITY OF DETROIT

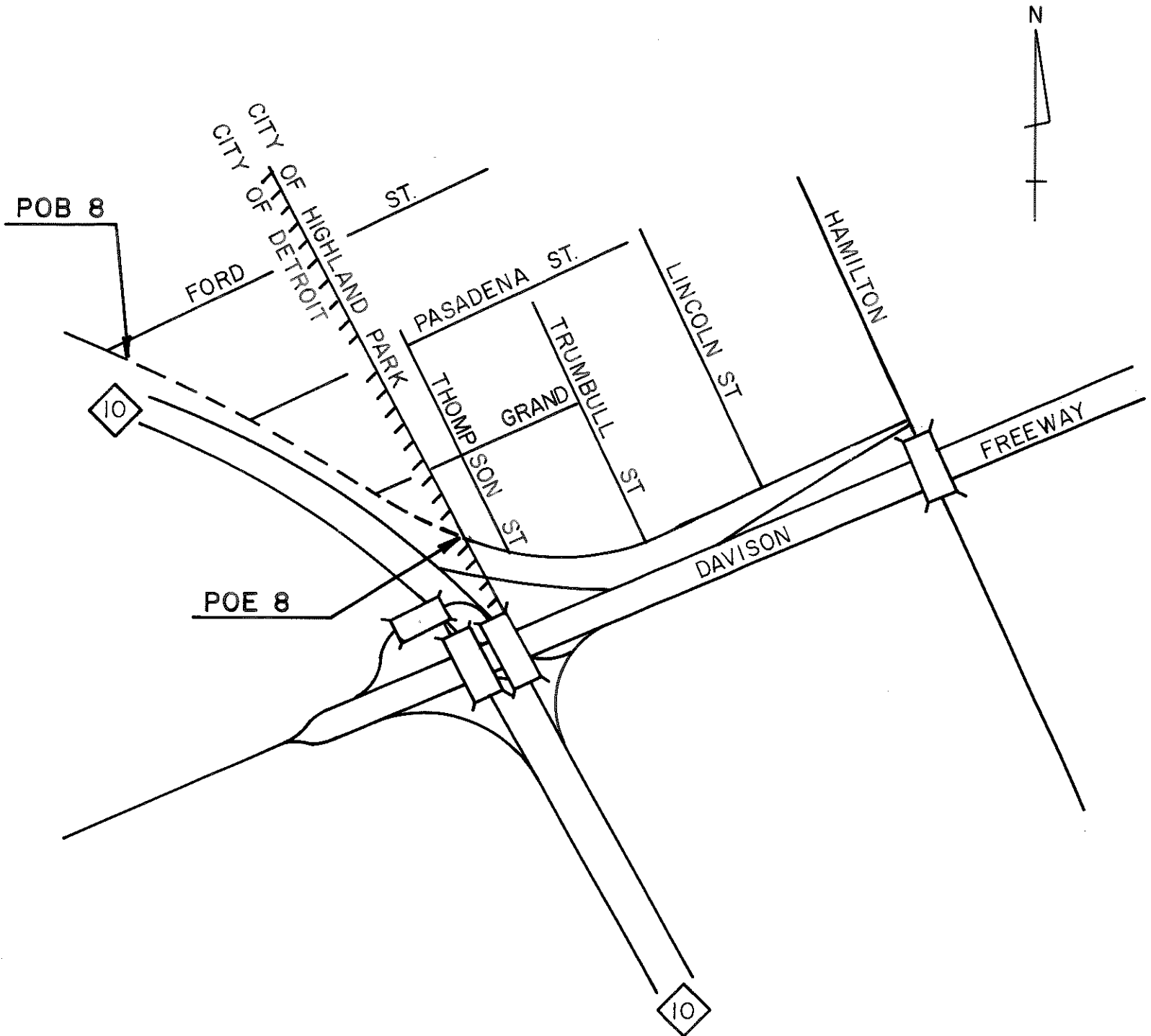

The transfer shall be effective
July 1, 1988



James P. Pitz
James P. Pitz, Director
Department of Transportation

TRANSFER OF SERVICE DRIVE ADJACENT TO M-10 IN THE CITY OF DETROIT

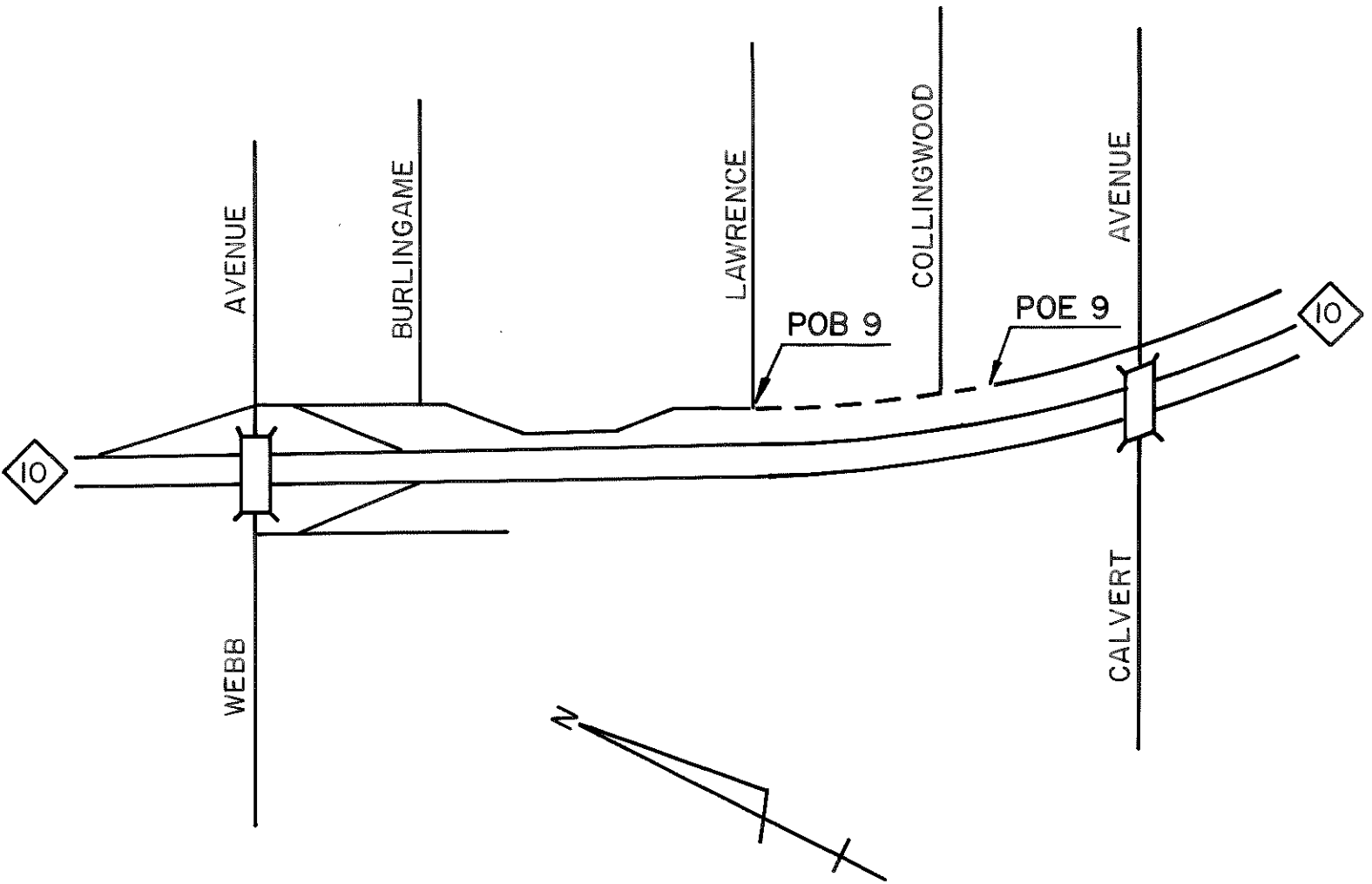

The transfer shall be effective
July 1, 1988



James P. Pitz
James P. Pitz, Director
Department of Transportation