

TRUE COPY CERTIFICATE

Form C of D-16-CE

STATE OF MICHIGAN, }
City of Detroit } ss.

CITY CLERK'S OFFICE, DETROIT

I, Janice M. Wmfrey, City Clerk of the City of Detroit, in said State, do hereby certify that the annexed paper is a TRUE COPY OF Resolution

adopted (passed) by the City Council at session of July 2, 2024

and approved by Mayor July 3, 2024

as appears from the Journal of said City Council in the office of the City Clerk of Detroit, aforesaid; that I have compared the same with the original, and the same is a correct transcript therefrom, and of the whole of such original.

In Witness Whereof, I have hereunto set my hand and affixed the corporate seal of said City, at

Detroit, this 25th day of March A.D. 2025

Janice M. Wmfrey
CITY CLERK



CITY OF DETROIT
DEPARTMENT OF PUBLIC WORKS
CITY ENGINEERING DIVISION

COLEMAN A. YOUNG MUNICIPAL CENTER
2 WOODWARD AVE. SUITE 601
DETROIT, MICHIGAN 48226
PHONE: (313) 224-3949 • TTY: 711
FAX: (313) 224-3471
WWW.DETROITMI.GOV

February 23rd, 2024

Honorable City Council:

RE: Petition No. x2024-048 – Great Lakes Water Authority request for the Vacation, ‘Outright’, of Freud Street and public alleys, lying between Conner Street and Navahoe Street, and for the dedication of land for the redirected route of Freud Street and a public alley.

Petition No. x2024-048 – Great Lakes Water Authority request for the Vacation, ‘Outright’, of Freud Street, 60 ft. wide, and public alleys lying between Conner Street, 50 ft. wide, and Navahoe Street, 50 ft. wide, and for the dedication of land for the redirected route of Freud Street and a public alley.

This request comes as part of a development plan to construct a new pumping station to provide flood relief to the community.

The petition was referred to the City Engineering Division – DPW for investigation (utility review) and report. This is our report.

The request was approved by the Solid Waste Division – DPW, and Traffic Engineering Division – DPW, and City Engineering - DPW. Detroit Water and Sewerage Department (DWSD) has no objection provided certain provisions are met. The DWSD provisions are a part of the attached resolution. All other involved City Departments, and privately owned utility companies have reported no objections. Provisions protecting utility installations are part of the attached resolution.

I am recommending adoption of the attached resolution.

Respectfully submitted,

Richard Doherty, P.E., City Engineer
City Engineering Division – DPW

Cc: Ron Brundidge, Director, DPW
Mayor’s Office – City Council Liaison

BY COUNCIL MEMBER _____

RESOLVED, Part of Freud Street, 60 ft. wide., and public alleys between Conner Street, 50 ft. wide, and Navahoe Street, 50 ft. wide, further described as land in the City of Detroit, Wayne County, Michigan being:

1. Freud Street, 60 ft. wide, lying northerly of and adjacent to lots 232 and 298, also the public alley residing between said lots 232 and 298, and lying southerly of and adjacent to lots 130 and 231, also the public alley residing between said lots 130 and 231 of "A M Campau Realty Co" as recorded in Liber 32, Page 87 of Plats, Wayne County Records.
2. Public alley, 18 ft. wide, lying easterly of and adjacent to lots 232 through 235, and lying westerly of and adjacent to lots 296 through 298 and the north 15 ft. of lot 295 of "A M Campau Realty Co" as recorded in Liber 32, Page 87 of Plats, Wayne County Records.
3. Public alley, 18 ft. wide, lying easterly of and adjacent to lot 231, and lying westerly of and adjacent to lots 130 of "A M Campau Realty Co" as recorded in Liber 32, Page 87 of Plats, Wayne County Records.

Be and the same are hereby vacated (outright) as public rights-of-way to become part and parcel of the abutting property, and further.

PROVIDED, that petitioner/property owner make satisfactory arrangements with any and all utility companies for cost and arrangements for the removing and/or relocating of the utility companies and city departments services, and further

PROVIDED, that the petitioner/property owner acknowledge that DWSD relinquishes all responsibility for underground sewers, if any, and further

PROVIDED, that the petitioner/property owner bear the entire cost of any modification to the sewer, in any, including costs related to construction, demolition, permitting, inspection, and survey, and further

PROVIDED, that any construction in the public rights-of-way such as curbs and sidewalks shall be done under city permit and inspection according to City Engineering Division – DPW specifications with all costs borne by the abutting owner(s), their heir or assigns; and further

RESOLVED, that that your Honorable Body authorize the acceptance of the following described properties owned by the City of Detroit for public street purposes:

For the Rerouting of Freud Street:

1. Lots 230, and 131 and part of lots 229, 231, 130, 132, 128-129, and 41 of "A M Campau Realty Co" as recorded in Liber 32, Page 87 of Plats, Wayne County Records; and Lot 70 and part of lots 68-69 and 87 of "Grosse Pointe Lands Company Subdivision" as recorded in Liber 27, Page 91 of Plats, Wayne County Records.

The north line of the proposed reroute of Freud Street will follow the below described direction:

2. Beginning from the southeast corner of lot 41 of "A M Campau Realty Company Subdivision", thence along a curve 104.02' in length, with a radius of 424.31', and chord bearing S 73-39-02 W, 103.76'.
3. Commencing from the northeast corner of lot 128 of "A M Campau Realty Company Subdivision", thence south along the westerly boundary of the public alley, 18' wide, 49.2' to the point of beginning; thence along a curve 51.9' in length, with a radius of 424.31', and chord bearing S 86-44-49 W, 51.87'; thence along a curve 57.3' in length, with a radius of 485.12', and chord bearing S 86-39-02 W, 57.27'.
4. Commencing from the northeast corner of lot 132 of "A M Campau Realty Company Subdivision", thence south along the westerly boundary of the Navahoe Street, 50' wide, 24.83' to the point of beginning; thence along a curve 101.17' in length, with a radius of 485.12', and chord bearing S 71-06-38 W, 100.99'.
5. Commencing from the northeast corner of lot 229 of "A M Campau Realty Company Subdivision", thence south along the westerly boundary of the public alley, 18' wide, .2' to the point of beginning; thence along a curve 96.46' in length, with a radius of 485.12', and chord bearing S 57-18-47 W, 96.3'.
6. Commencing from the northeast corner of lot 68 of "Grosse Pointe Lands Company Subdivision", thence south along the westerly boundary of Conner Street, 50' wide, 12.57' to the point of beginning; thence along a curve 80.68' in length, with a radius of 485.12', and chord bearing S 40-44-53 W, 80.58'; thence continuing along a curve, 26.5' in length, with a radius of 425.4', and chord bearing S 37-46-07 W, 26.5'.
7. Commencing from the northeast corner of lot 87 of "Grosse Pointe Lands Company Subdivision", thence south along the westerly boundary of the public alley, 18' wide, 1.93' to the point of beginning; thence along a curve 103.32' in length, with a radius of 425.4', and chord bearing S 49-07-53 W, 103.06'.

The south line of the proposed reroute of Freud Street, between Conner Street and Navahoe Street, will follow the below described direction:

8. Commencing from the southwest corner of lot 231 of "A M Campau Realty Company Subdivision" thence north along the easterly boundary of Navahoe Street, 50' wide, 28.85' to the point of beginning; thence along a curve 216.37' in length, with a radius of 425.12', and chord bearing N 64-31-50 E, 214.05'

Dedication of land for alley purposes west of Navahoe Street:

9. Public alley, being the southerly 15' of lot 295 of "A M Campau Realty Company Subdivision" as recorded in Liber 32, Page 87 of Plats, Wayne County Records.

PROVIDED, that the entire work in constructing the new streets is to be performed in accordance with plans and specifications approved by City Engineering Division – DPW (CED) and constructed under the inspection and approval of CED; and further

PROVIDED, that the Great Lakes Water Authority maintains the remaining part of Freud Street between Tennessee Street and Conner Street, also that part between Navahoe Street and Algonquin Street that is being converted into a grass berm area because of the Freud Street reroute. The Great Lakes Water Authority will be responsible for the landscaping and mowing within the grass berm areas on the south side of Freud Street that had formally been the paved route of Freud Street. In the event that said grass berm areas become vacated the maintenance responsibility shall transfer to the appropriate ownership of the vacated land, and be it further

PROVIDED, That the petitioner obtains Traffic Engineering Division, signature of approval on the final design and plans for the construction of the streets; and be it further

PROVIDED, That the City Clerk shall within 30 days record a certified copy of this resolution with the Wayne County Register of Deeds.



TENNESSEE ST. 50 FT. WD.

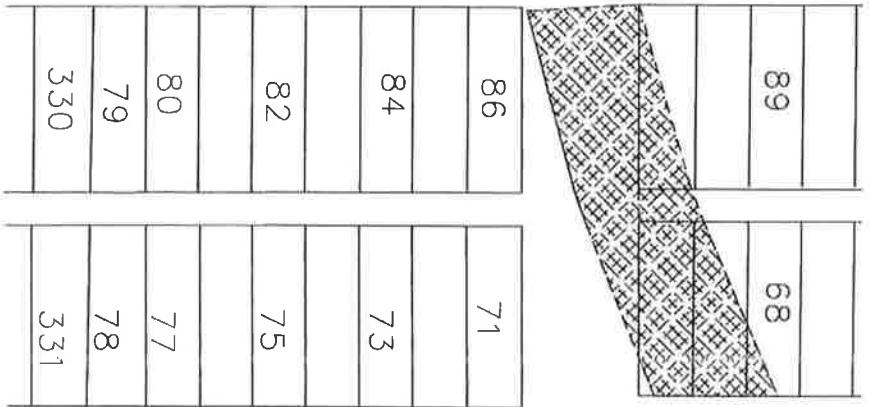

CONNER ST. 50 FT. WD.

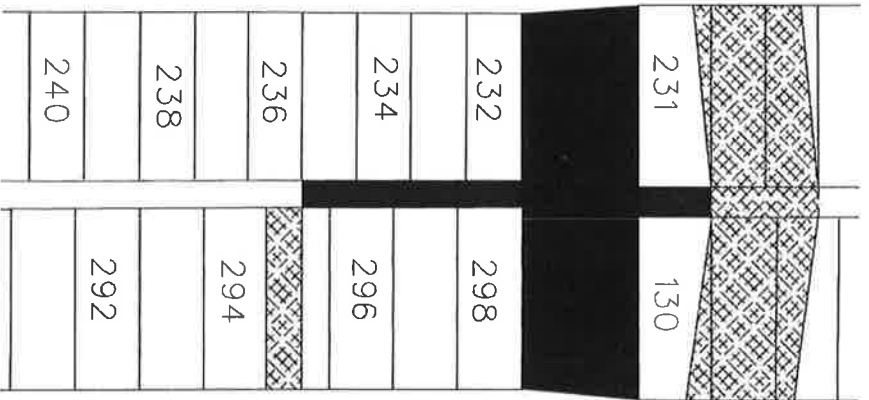

NAVAHOE ST. 50 FT. WD.

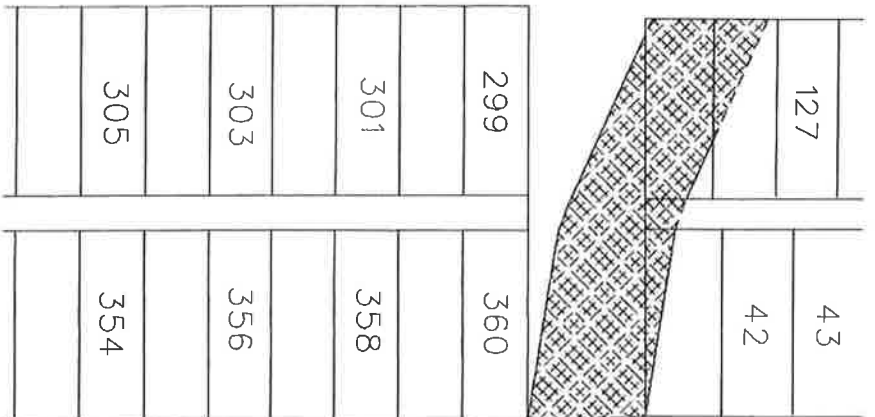

ALGONQUIN ST. 60 FT. WD.

- OUTRIGHT VACATION
- REQUEST STREET DEDICATION

(FOR OFFICE USE ONLY)

CARTO 62 C & D

A		B	
DESCRIPTION	REVISIONS	DRAWN	CHECKED
AP			
LC			
DATE	05-26-2023	APPROVED	JD

REQUEST DEDICATION OF FREUD ST. AND
REQUEST TO OUTRIGHT VACATE PUBLIC ALLEYS BETWEEN
TENNESSEE, ALGONQUIN, NORTH AND SOUTH OF FREUD ST.

CITY OF DETROIT	
CITY ENGINEERING DIVISION	
SURVEY BUREAU	
JOB NO.	23-73
DRWG. NO.	

**ADOPTED AS FOLLOWS
COUNCIL MEMBERS**

	YEAS	NAYS
Scott BENSON	✓	
Fred DURHAL, III	✓	
Latisha JOHNSON	✓	
Gabriela SANTIAGO-ROMERO	✓	
*James TATE	✓	
Mary WATERS	✓	
Angela WHITFIELD-CALLOWAY	✓	
Coleman YOUNG, II	✓	
MARY PRESIDENT SHEFFIELD	✓	
*PRESIDENT PRO TEM		
	9	0
WAIVER OF RECONSIDERATION (No. _____)		
Per motions before adjournment.		