

BENCH MARKS

BM 11 ELEV 115.29
ARROW ON HYDRANT LOCATED AT THE
NORTHEAST CORNER OF LARNED ST
AND WASHINGTON BLVD

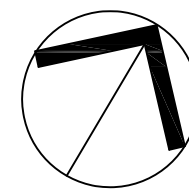

SCALE: 1" = 10'-0"

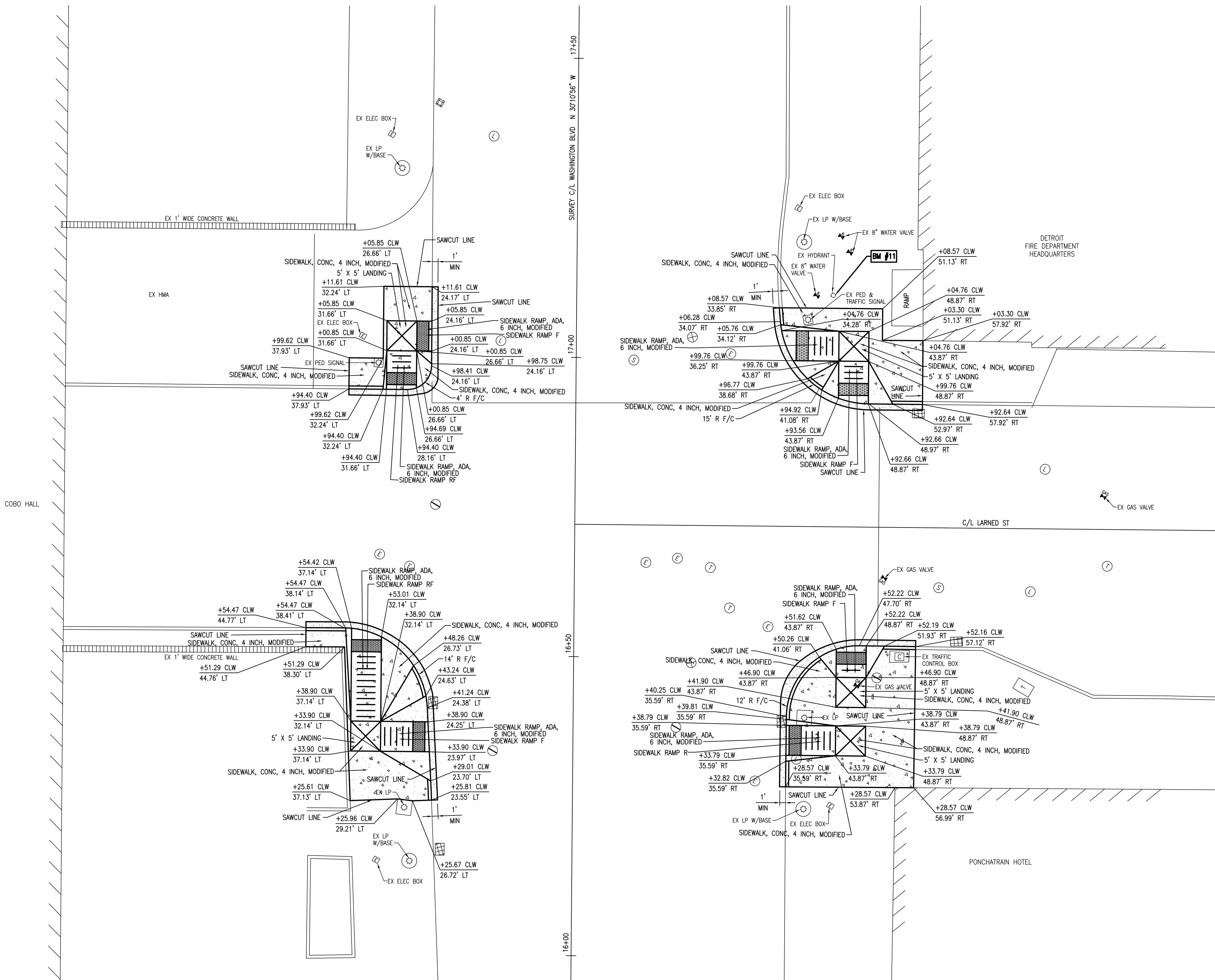

GENERAL NOTES

1. THE ELEVATIONS SHOWN ARE CITY OF DETROIT VERTICAL DATUM. TO CONVERT THE ELEVATION VALUES SHOWN TO THE NATIONAL GEODATIC VERTICAL DATUM OF 1929 (COMMONLY REFERRED TO AS USGS OR USC & GS DATUM), ADD 479.755'.
2. ALL ELEVATIONS ARE SIDEWALK ELEVATIONS UNLESS OTHERWISE NOTED.
3. ALL MATERIALS AND WORKMANSHIP FOR R.O.W. IMPROVEMENTS SHALL MEET THE STANDARDS, REGULATIONS, ORDINANCES AND SPECIFICATIONS OUTLINED IN THE CITY OF DETROIT ENGINEERING DEPARTMENT STANDARDS AND SPECIFICATIONS FOR PAVING AND RELATED CONSTRUCTION.
4. SOD ALL LAWN AREAS WHICH ARE DISTURBED DURING CONSTRUCTION. IF A DISTURBED AREA CANNOT BE PERMANENTLY STABILIZED IMMEDIATELY AFTER AN EARTH CHANGE OR IF ACTIVITY CEASES FOR MORE THAN 30 DAYS, TEMPORARY SEEDING SHALL BE IMPLEMENTED WITHIN 5 DAYS.
5. REFER TO SHEET R-22 FOR ON-SITE DEMOLITION.
6. FOR PROTECTION OF UNDERGROUND UTILITIES, THE CONTRACTOR SHALL DIAL 1-800-482-7171 A MINIMUM OF THREE (3) WORKING DAYS PRIOR TO EXCAVATION IN THE VICINITY OF UTILITY LINES. ALL "MISS DIG" PARTICIPATING MEMBERS WILL THUS BE ROUTINELY NOTIFIED. THIS DOES NOT RELIEVE THE CONTRACTOR OF THE RESPONSIBILITY OF NOTIFYING UTILITY OWNERS WHO MAY NOT BE PART OF THE "MISS DIG" ALERT SYSTEM.
7. CONSTRUCTION SAFETY IS THE SOLE RESPONSIBILITY OF THE CONTRACTOR; NEITHER THE OWNER NOR THE ENGINEER SHALL BE EXPECTED TO ASSUME ANY RESPONSIBILITY FOR SAFETY OF THE WORK, OF PERSONS ENGAGED IN THE WORK, OF ANY NEARBY STRUCTURES, OR OF ANY OTHER PERSONS.
8. A MINIMUM OF ONE LANE OF TRAFFIC SHALL BE MAINTAINED AT ALL TIMES ON WASHINGTON BLVD AND LARNED ST DURING CONSTRUCTION.
9. CONTRACTOR IS RESPONSIBLE FOR AVOIDING ANY CONFLICT BETWEEN THE PROPOSED CONSTRUCTION AND THE EXISTING UTILITIES.
10. HMA RESURFACING IN VICINITY OF PROPOSED CURBS IS CONSIDERED INCLUDED IN THE PAY ITEM "SEPARATE TYPE CURB". SEE DETAIL SHEET DET-13.
11. RESTORATION OF LAWN AREAS DISTURBED AS PART OF THE CONSTRUCTION OPERATION WILL NOT BE PAID FOR SEPARATELY BUT IS CONSIDERED INCLUDED IN OTHER ITEMS OF WORK.
12. THE CONTRACTOR SHALL RE-VERIFY EXISTING ON-SITE ELEVATIONS WHERE PROPOSED CONSTRUCTION MEETS EXISTING CONDITIONS PRIOR TO START OF CONSTRUCTION AND NOTIFY THE ENGINEER IF OTHER THAN INFORMATION SHOWN ON THESE PLANS. IN ADDITION, THE CONTRACTOR SHALL INSURE THAT POSITIVE DRAINAGE IS MAINTAINED THROUGHOUT THE SITE.

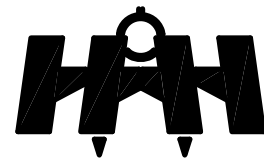

HH Engineering LTD
220 Bagley, Suite 500
Detroit, Michigan 48226
phone (313) 963-6560
fax (313) 963-6960
hhimes@hhengltd.com

Hamilton Anderson Associates
1435 Randolph, Suite 200
Detroit, Michigan 48226

ph (313) 964-0270, fax (313) 964-0170, www.hamilton-anderson.com

REVISION #	DATE

CONSTRUCTION QUANTITIES
THIS SHEET

160	FT	CURB, CONC, DET C1, MODIFIED
1050	SFT	SIDEWALK, CONC, 4 INCH, MODIFIED
355	SFT	SIDEWALK RAMP, ADA, 6 INCH, MODIFIED
9	CYD	GRANULAR MATERIAL, CL II, MODIFIED
8	EA	24" x 60" DETECTABLE WARNING SURFACE TILES, MODIFIED

NOTE: LANDING AREAS ARE INCLUDED IN PAY ITEM "SIDEWALK, CONC, 4 INCH, MODIFIED".

LEGEND

CLW WASHINGTON BLVD SURVEY C/L

SITE PLAN

W LARNED ST & WASHINGTON BLVD
ADA HANDICAP RAMPS - DETROIT, MICHIGAN

DATE
07/09/09

SCALE
1" = 10'

JOB NO.
C0720

DESIGN UNIT
HIMES

SHEET NO.

146

SHEET NO.

GC-22