

Engineering Consultants

Infrastructure • Land Development • Surveying

220 W. Congress, Suite 400
Detroit, MI 48226
Phone: (313) 967-4700
Fax: (313) 967-4707

905 South Blvd. East
Rochester Hills, MI 48307
Phone: (248) 844-5400
Fax: (248) 844-5404

2505 W. Jefferson
Trenton, MI 48183
Phone: (734) 671-4344
Fax: (734) 671-4347

www.spaldingdedecker.com

DDA CITY OF DETROIT

DOWNTOWN DEVELOPMENT AUTHORITY

500 Griswold, Suite 2200,
Detroit, MI 48228
P: (313) 963-2940
F: (313) 963-8893

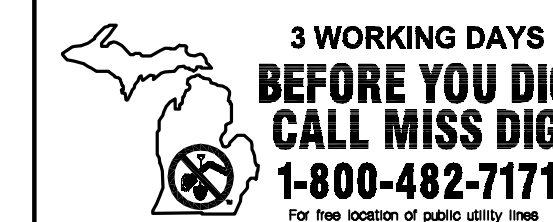

NOTE: UTILITY INFORMATION ON THIS DRAWING MAY BE FROM INFORMATION DISCLOSED TO THIS FIRM BY THE VARIOUS UTILITY COMPANIES, CITY/COUNTY AGENCIES AND OTHER VARIOUS SOURCES. UNDERGROUND UTILITIES WHICH ARE ON PRIVATE PROPERTY ARE USUALLY NOT Delineated UNDER A UTILITY COMPANY'S PUBLISHED PLANS. THEIR LOCATION, IF SHOWN ON THIS SURVEY, ARE APPROXIMATED FROM FOUND PAINT MARKS/STAKES, ETC. AS LOCATED BY THIS FIRM FROM SOURCES WHICH ARE UNKNOWN. NO GUARANTEE IS GIVEN AS TO THE COMPLETENESS OR ACCURACY THEREOF.

PRIOR TO CONSTRUCTION, ALL LOCATIONS AND DEPTHS OF EXISTING UTILITIES (IN CONFLICT WITH PROPOSED IMPROVEMENTS) SHALL BE VERIFIED IN THE FIELD. CALL MISS DIG 3 WORKING DAYS PRIOR TO CONSTRUCTION.

COPYRIGHT © 2007 SPALDING DeDECKER ASSOCIATES, IN
THIS DRAWING AND THE SUBJECT MATTER CONTAINED
THEREON IS PROPRIETARY AND IS NOT TO BE USED OR
REPRODUCED WITHOUT WRITTEN PERMISSION OF
SPALDING DeDECKER ASSOCIATES, INC.

BROADWAY-

JOHN R.
ADA RAMP DESIGN
REMOVAL PLAN

SECTION	PRIVATE CLAIM
TOWN	RANGE
CITY OF DETROIT	
WAYNE	COUNTY

NO.	DATE	REVISION

[SHEET 75]

DRAFTER SDA		DATE 06-25-07
DESIGNER SDA		DATE 06-25-07
CHECKED		DATE

PROJECT MANAGER	BID PLAN DATE
M. HAMOOD	
DEPARTMENT MANAGER APPROVAL	DATE

VERIFY SCALES
BAR IS ONE INCH ON ORIGINAL DRAWING
IF NOT ONE INCH ON THIS SHEET,
ADJUST SCALES ACCORDINGLY

JOB NO. DE06001_OT	DRAWING NO. DE06001ADA-BR-R
SCALE: 1" = 10'	SHEET NO. R-7

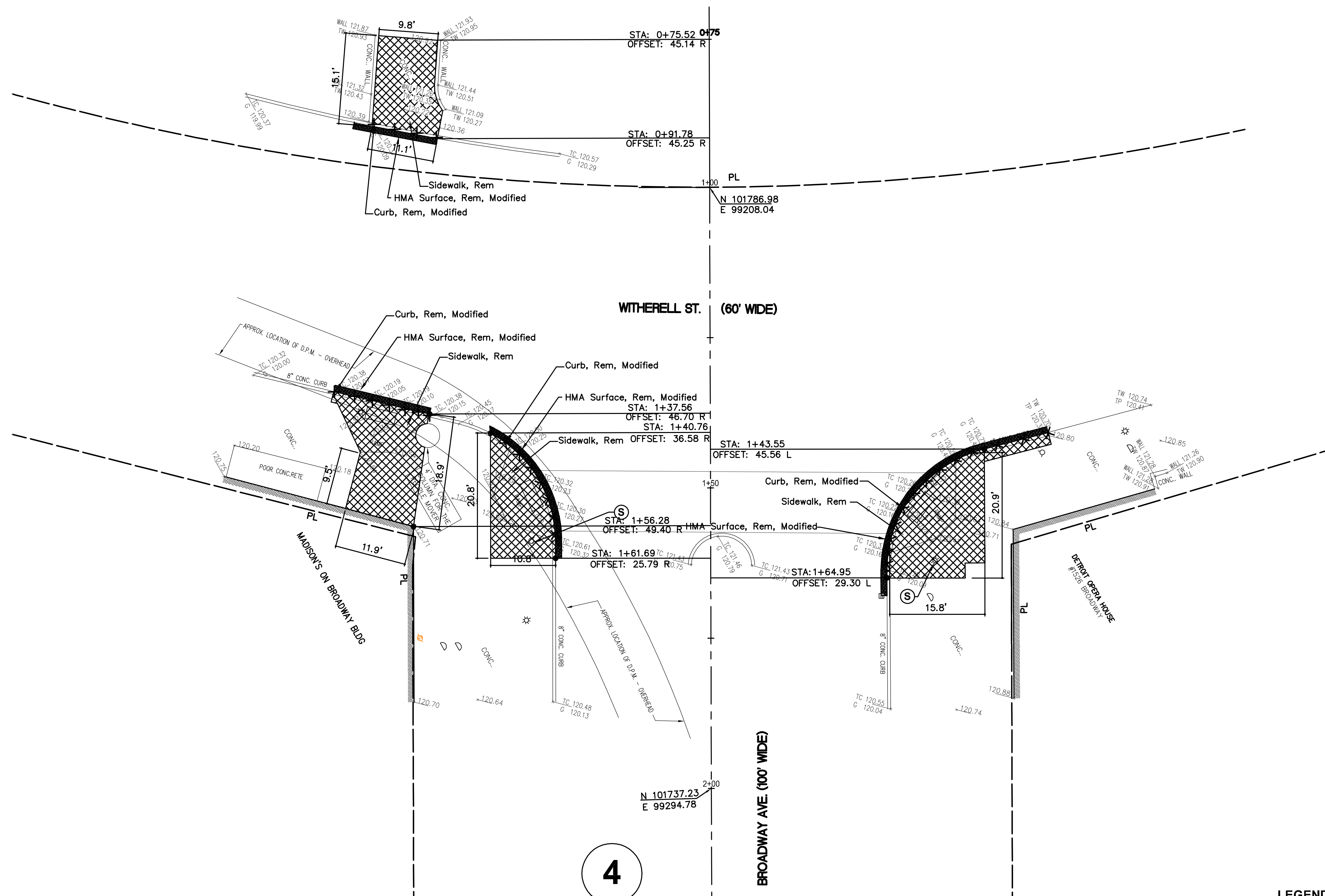





BROADWAY & WITHERELL

BENCHMARK DESCRIPTIONS

BM#28-353A FOUND CITY OF DETROIT CONTROL DISK IN MONUMENT BOX IN
SIDEWALK AT THE NORTHEAST CORNER OF FORT STREET AND
WASHINGTON BLVD.

SITE BM#11 ARROW ON HYDRANT LOCATED ON THE NORTHWEST CORNER OF
WOODWARD AVENUE AND CLIFFORD STREET.

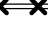
LEGEND

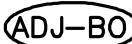
	Sidewalk, Rem
	HMA Surface, Rem, Modified
	Curb, Rem, Modified
	SAVE LIGHT POLE, UTILITY POLE, FIRE HYDRANT
	Dr. Structure cover, Adj, Case 1, Modified
	Adjust Utility Structure cover—by others
	Water Shutoff, Adj, Modified

CONSTRUCTION QUANTITIES, THIS SHEET

PAY ITEM	UNIT	QUANTITY
Sidewalk, Rem	Syd	90
Curb, Rem, Modified	Ft	95
HMA Surface, Rem, Modified	Syd	12